

DATA SHEET

Premium Efficiency Motor: **NAT34-36-56CB**

60 Hz

WorldWide Electric Corporation

1 (800) 808-2131

Worldwideelectric.net



Document Generated: 31-May-2023
Document ID:

Customer:

MOTOR INFORMATION	
HP	3/4
RPM	3600
Phase	3
Frequency	60 Hz
Voltage	230/460
Frame Size	56C
Enclosure	TEFC
Degree of Protection	IP43
Service Factor	1.15
Poles	2
Full Load Speed	3450
Insulation Class	F
Temp Rise	80°C
NEMA Code Letter	N
Duty Cycle	S1 / Continuous
Slip	0.04%
NEMA Design	B
Moment of Inertia	0.031 lb.ft.^2
Sound Pressure Level	78 dB(A)
Max Ambient Temperature	40°C
Max Elevation	1000 m.a.s.l (3300 f.a.s.l)
Mounting	F1
Base	C-Face Removable Base
Rotation	Bi-Directional
Standard	NEMA MG-1
Approvals	CSA, CE

EFFICIENCY/POWER FACTOR		
LOAD	EFF	P. F.
100%	74.7 %	81.8
75%	73.1 %	74.4
50%	68.3 %	62.4

TORQUE		
FULL LOAD	LRT	BDT
1.12 lb.ft.	260 %	375 %

AMPERAGE INFORMATION		
	230V	460V
Full Load Amps	2.4	1.2
Locked Rotor Amps	16.1	8.05
No Load Current	1.34	0.67
Usable at 208V	--	

BEARING INFORMATION	
DE Bearing	6203 2RS
ODE Bearing	6203 2RS

ADDITIONAL DATA	
F2 Suitable	No
Shaft Material	1045 Carbon Steel
Connection Diagram	230 / 460 V - 9 Lead Y
Approximate Weight	20.5 lbs.

MOTOR DRAWING

Premium Efficiency Motor: **NAT34-36-56CB**

WorldWide Electric Corporation

1 (800) 808-2131

Worldwideelectric.net

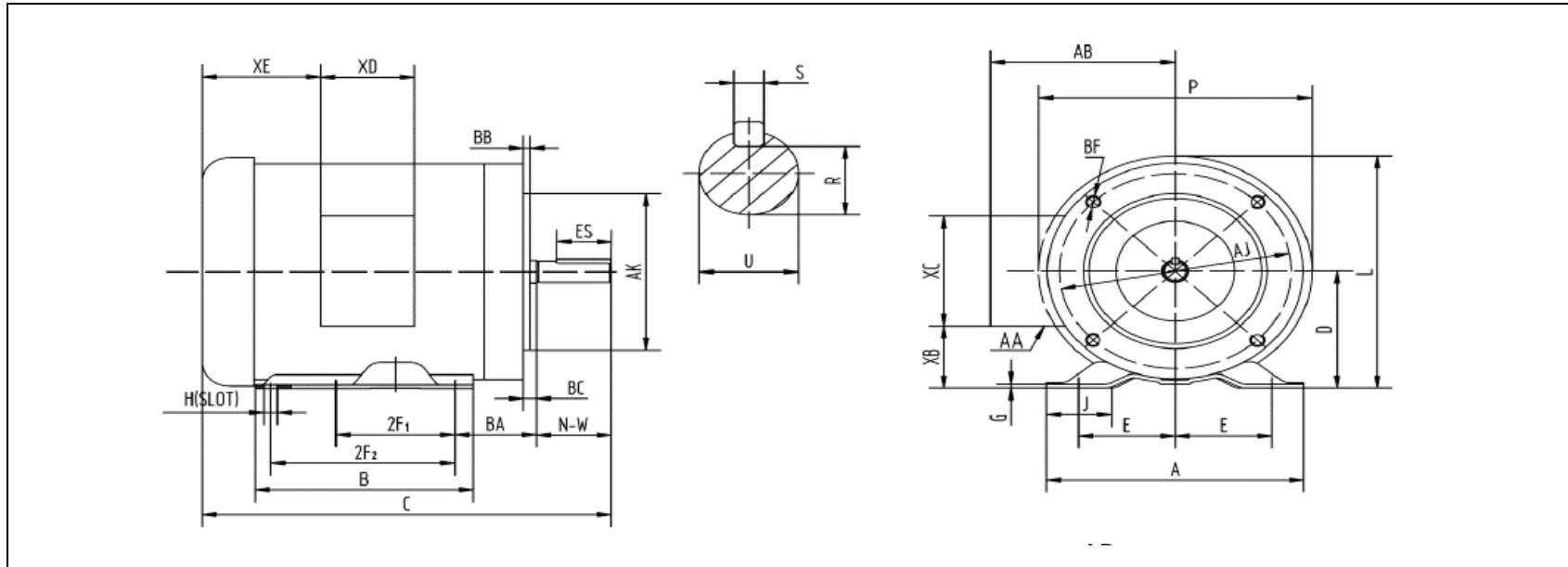

DIMENSION - INCHES

MOUNTING					A	B	C	D	G	J	L	P	AB
E	2F1	2F2	H	BA									
2.44	3	5	0.34	2.75	6.54	6.54	11.9	3.5	0.1	1.65	7.4	7.3	5.2

SHAFT & KEY				
S	ES	R	N-W	U
0.188	1.41	0.517	1.88	0.625

TERMINAL BOX				
AA	XB	XC	XD	XE
3-0.88/2-1.109	1.65	3.7	3.2	2.15

FLANGE				
AK	AJ	BF	BB	BC
4.5	5.875	3/8-16	0.16	-0.19

PERFORMANCE CURVES

WorldWide Electric Corporation

1 (800) 808-2131

Worldwideelectric.net



Premium Efficiency Motor:

NAT34-36-56CB

Document Generated: 31-May-2023	Customer:
Document ID:	

Motor Type			FL Speed	3450		
Output Rating (HP)	3/4		LRT (%FLT)	260	460 volt FLA	1.2
Full Load Torque	1.12	lb.ft	BDT (%FLT)	375	230 volt FLA	2.4
Rotor Wk ²	0.031	lb-ft ²				

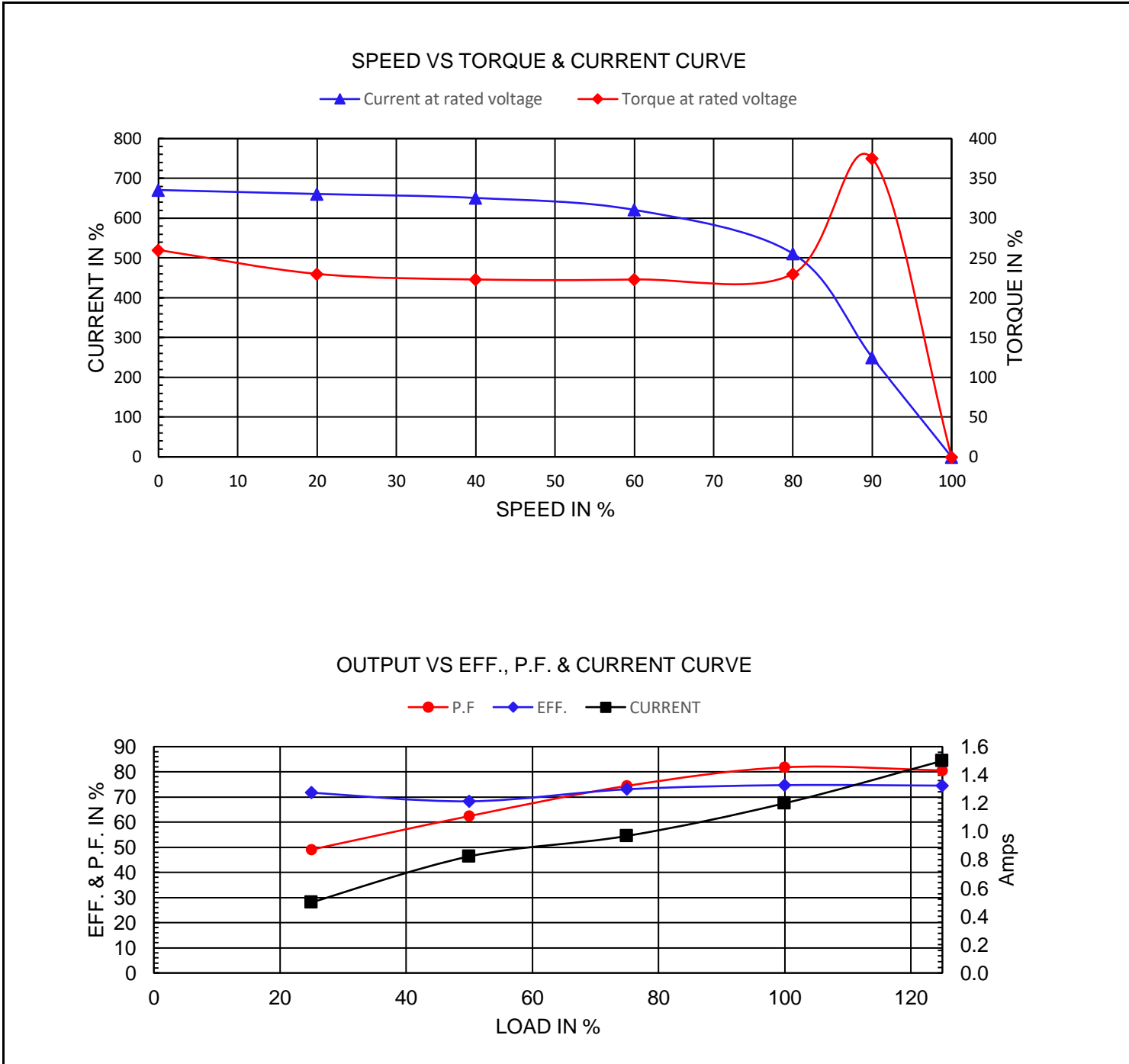

NAMEPLATE / WIRING

WorldWide Electric Corporation

1 (800) 808-2131

Worldwideelectric.net



Premium Efficiency Motor: **NAT34-36-56CB**

Document Generated: 31-May-2023
Document ID:

Customer:

SAMPLE NAMEPLATE DATA

		<h3>THREE PHASE INDUCTION MOTOR</h3>					
MODEL	FRAME	LOW VOLTAGE		HIGH VOLTAGE		MADE IN CHINA	
Hz	ENCL. TEFC	BLUE (T1)	} LINE1	BLUE (T1)	LINE1		
HP	PH 3	BROWN (T7)		WHITE (T2)	WHITE (T2)		
RPM	DUTY CONT	RED (T8)	} LINE2	ORANGE (T3)	LINE3		
VOLTS	CODE	ORANGE (T3)		YEL/BLA (T9)	YEL/BLA (T9)		
AMPS	INS. F	YEL/BLA (T9)	} LINE3	BROWN (T7)	INS		
	DES.	BLACK (T5)		YEL (T4)	BLACK (T5)		
S. F.	LB/WT	BLACK (T5)	} INS	RED (T8)	INS		
		GRAY (T6)		GRAY (T6)	GRAY (T6)		
		GRAY (T6)		YEL/BLA (T9)	INS		
NOM. EFF (60Hz)	DE/ODE BRG.	ACCEPTABLE FOR FIELD WIRING					
MAX. AMB. 40°C	Date Code XX/XXXXX	THERMALLY PROTECTED : NONE					
SERIAL NO. XXXXXXXXXX		WorldWide Electric Corporation					

Model	NAT34-36-56CB	Frame	56C
Hz	60 Hz 50Hz	Encl	TEFC
HP	3/4 1/2	PH	3
RPM	3450 2850	DUTY	CONT
Voltage	230/460 190/380	Code	N
Amps	4.73/2.26 1.96/0.98	Ins Cl	F
IP	IP43	Design	B
S.F.	1.15 1.00	LB/WT	20.5 lbs.
Nom.Eff.	74.7%	DE Brng	6203 2RS
		ODE Brng	6203 2RS