

# DATA SHEET

Premium Efficiency Motor: **OJ34-36-56JB,**

**60 Hz**

WorldWide Electric Corporation

1 (800) 808-2131

Worldwideelectric.net



Document Generated: 5-May-2022  
Document ID:

Customer:

MOTOR INFORMATION	
HP	3/4
RPM	3600
Phase	1
Frequency	60 Hz
Voltage	115/230
Frame Size	56J
Enclosure	ODP
Degree of Protection	IP23
Service Factor	1.50
Poles	2
Full Load Speed	3520
Insulation Class	F
Temp Rise	80°C
NEMA Code Letter	J
Duty Cycle	S1 / Continuous
Slip	2.16%
NEMA Design	N
Moment of Inertia	0.0364 lb.ft.^2
Locked Rotor Time (Hot)	12 seconds
Sound Pressure Level	78 dB(A)
Number of Starts	2
Max Ambient Temperature	40°C
Max Elevation	1000 m.a.s.l (3300 f.a.s.l)
Mounting	F1
Rotation	CW Facing ODE
Area of Classification	Safe
Inverter Rating	N/A
Standard	NEMA MG-1
Approvals	UL

EFFICIENCY/POWER FACTOR		
LOAD	EFF	P. F.
100%	76.2 %	0.97
75%	74.1 %	0.97
50%	66.6 %	0.95

TORQUE		
FULL LOAD	LRT	BDT
1.1 lb.ft.	303 %	291 %

AMPERAGE INFORMATION		
	115V	230V
Full Load Amps	6.312A	3.156A
Locked Rotor Amps	50A	25A
No Load Current	1.9444A	0.9722A
Usable at 208V	3.5A	

BEARING INFORMATION	
DE Bearing	6203-ZZ
ODE Bearing	6203-ZZ
Grease Type	NS7 ENS
DE Regreasing Interval	- Hours
ODE Regreasing Interval	- Hours
Grease Quantity	-

CAPACITOR INFORMATION	
Start Capacitor	1 - 200-240µf/125V
Run Capacitor	1 - 35µf/250V

ADDITIONAL DATA	
F2 Suitable	No
Shaft Material	S45C + SUS304
Connection Diagram	115 / 230 V - 3 Lead
Approximate Weight	26.6 lbs.

# ODP Jet Pump Motor Drawing

## 56JB

WorldWide Electric Corporation  
1 (800) 808-2131  
Worldwideelectric.net

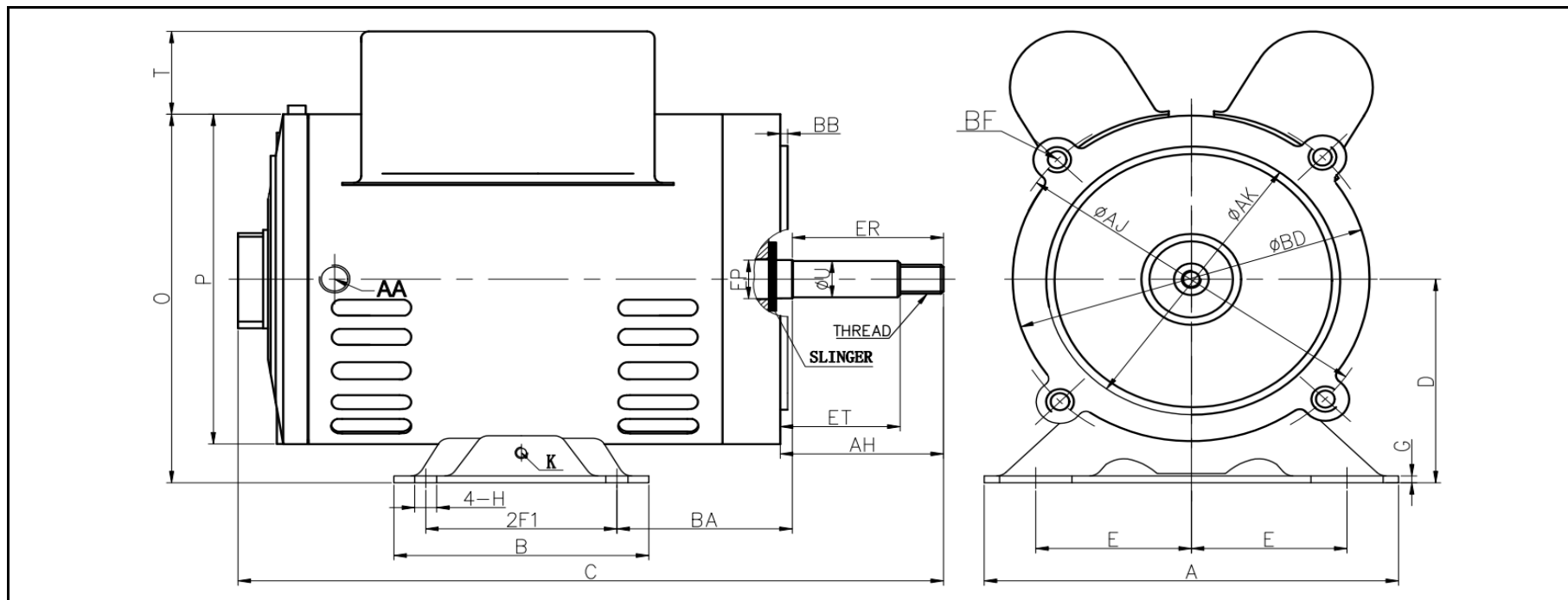

**DIMENSIONS - INCHES**

MOUNTING				A	B	C	D	G	P	O	T	Ground Lug K	AA
E	2F1	H	BA										
2.44	3	0.34	2.75	6.3	4	11.1	3.5	0.08	5.67	6.4	1.43	M5	1/2 NPT

SHAFT & KEY					
EP	ET	ER	AH	U	THREAD
0.66	1.88	2.37	2.56	0.625	7/16-20 2A UNF

FLANGE				
AK	BD	AJ	BF	BB
4.5	5.67	5.875	4*3/8-16 UNC	0.16

# NAMEPLATE / WIRING

Premium Efficiency Motor: **OJ34-36-56JB**

WorldWide Electric Corporation

1 (800) 808-2131

Worldwideelectric.net



Document Generated: 5-May-2022  
Document ID:

Customer:

## SAMPLE NAMEPLATE DATA

		<b>OPEN DRIP PROOF SINGLE PHASE JET PUMP MOTOR</b>							
		Model :		Encl : ODP		SN :			CW ROTATION OPE
HP :	Poles : 2	FR :	Ins : F	IP 23	Max Amb 40°C	Duty : Cont		HIGH VOLTAGE	
Hz : 60	CODE:		Design :						
Volts :	P.F. :		DE BRG :				LOW VOLTAGE		
Amps :	Eff :		ODE BRG :						
RPM :	S.F. :		WT : LBS						
Usable on 208V 60Hz network at ___ Amps		S.F.A :		Date :					
<b>WorldWide Electric Corporation</b>									

<b>Model</b>	OJ34-36-56JB	<b>Frame</b>	56J	<b>Design</b>	N
<b>HP</b>	3/4	<b>Code</b>	J	<b>DE Brg</b>	6203-ZZ
<b>Hz</b>	60 Hz	<b>P.F.</b>	0.97	<b>ODE Brg</b>	6203-ZZ
<b>Voltage</b>	115/230	<b>Nom.Eff.</b>	76.2%	<b>WT</b>	26.6 lbs.
<b>Amps</b>	6.312A/3.156A	<b>S.F.</b>	1.5		
<b>RPM</b>	3520	<b>S.F.A</b>	4.706A		
<b>Usable on 208V 60Hz Network at</b>		3.5A			