



# Hollow Bore Bushing Assembly Installation

## SSHDR Series Stainless Steel Worm Gear Reducers



### Instructions:

1. Loosen the 3 set screws located on the hollow output bore of gearbox (items 4 & 5).
2. Insert the bushing (item 2) into hollow output shaft and align bushing set screw holes with the output bore set screw holes of the gearbox, then partially fasten the set screws to hold the bushing in place. Take care to align the bushing keyway with the gearbox output bore keyway during insertion.
3. Install the key onto the driven shaft.
4. Insert the driven shaft through the hollow output shaft aligning the shaft key with the keyway located in the reducer output bore.
5. Fasten all set screws to fix the driven shaft.

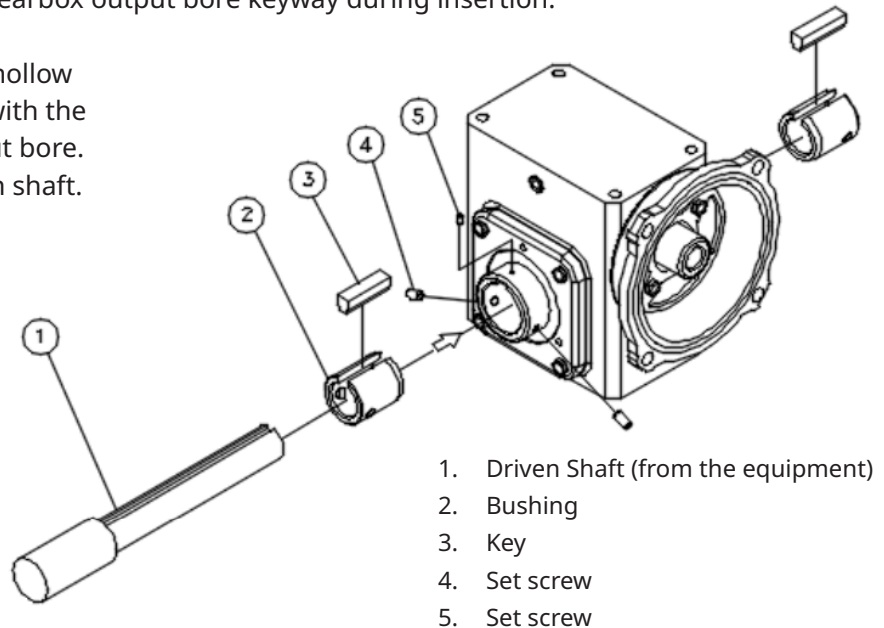

*Continued on Next Page*



**Notes**

Quantities - Stainless Steel Bushing Kits include sizing inserts (bushings x2), keys (x2) and set screws (x2).  
Sizes - Available for 1.75" through 3.25" center distances.

Not Suitable - Stainless Steel Bushing Kits are not suitable for cast iron gear reducers.

Reducer Size CD (in.)	Output Bore Size	Model Number	Outer Diameter O.D. (in.)	Inner Diameter I.D. (in.)	*/**
1.75	1"	SSB1.58	1"	5/8"	*
	1"	SSB1.1116	1"	11/16"	
	1"	SSB1.34	1"	3/4"	
	1"	SSB1.78	1"	7/8"	
	1"	NOT REQUIRED	1"	1"	
2.06	1-7/16"	SSB1716.1	1-7/16"	1"	
	1-7/16"	SSB1716.1.18	1-7/16"	1-1/8"	
	1-7/16"	SSB1716.1.316	1-7/16"	1-3/16"	
	1-7/16"	SSB1716.1.14	1-7/16"	1-1/4"	
	1-7/16"	NOT REQUIRED	1-7/16"	1-7/16"	
2.37	1-7/16"	SSB1716.1	1-7/16"	1"	
	1-7/16"	SSB1716.1.18	1-7/16"	1-1/8"	
	1-7/16"	SSB1716.1.316	1-7/16"	1-3/16"	
	1-7/16"	SSB1716.1.14	1-7/16"	1-1/4"	
	1-7/16"	NOT REQUIRED	1-7/16"	1-7/16"	
2.62	1-15/16"	SSB11516.1	1-15/16"	1"	**
	1-15/16"	SSB11516.1.18	1-15/16"	1-1/8"	**
	1-15/16"	SSB11516.1.316	1-15/16"	1-3/16"	**
	1-15/16"	SSB11516.1.14	1-15/16"	1-1/4"	**
	1-15/16"	SSB11516.1.716	1-15/16"	1-7/16"	
	1-15/16"	SSB11516.1.12	1-15/16"	1-1/2"	
	1-15/16"	NOT REQUIRED	1-15/16"	1-15/16"	
3.25	2-3/16"	SSB2316.1.14	2-3/16"	1-1/4"	*
	2-3/16"	SSB2316.1.716	2-3/16"	1-7/16"	
	2-3/16"	SSB2316.1.12	2-3/16"	1-1/2"	*
	2-3/16"	SSB2316.1.58	2-3/16"	1-5/8"	
	2-3/16"	SSB2316.1.1116	2-3/16"	1-11/16"	
	2-3/16"	SSB2316.1.34	2-3/16"	1-3/4"	
	2-3/16"	SSB2316.1.1516	2-3/16"	1-15/16"	*
	2-3/16"	SSB2316.2	2-3/16"	2"	*
	2-3/16"	NOT REQUIRED	2-3/16"	2-3/16"	

\* Use standard SS flat keys (0.25\*0.25\*1.37L)

\*\*When installing bushing kit for smaller hollow bores, the SS flat key enclosed with the gear unit and the SS flat key packed in the bushing kit should be used at the same time when installing bushing kit for smaller hollow bores, use the **SS T flat key** packed in the bushing kit and discard the one enclosed with the gear unit.



WorldWide Electric Corporation is a leading manufacturer of electric motors, motor controls, gear reducers, and generators. Offering fast, often same-day, shipping from seven regional US warehouses, WorldWide Electric takes pride in providing a competitive edge to our customers by responding to their requirements with urgency, technical expertise, and professionalism.

© Copyright 2023 WorldWide Electric Corporation