



WORLDWIDE ELECTRIC MOTOR DATA SHEET

NTMOL1.5-36-56CB



| | | | |
|----------------------------------|---------------------------------|----------------------|-------------|
| HORSEPOWER | 1.5 | | |
| RPM / POLES | 3600 / 2 | | |
| VOLTAGE / PHASE | 115/230 V / 1 | | |
| FRAME | 56HC | | |
| ENCLOSURE / DEGREE OF PROTECTION | TEFC / IP43 | | |
| FREQUENCY | 60 HZ | | |
| FULL LOAD SPEED | 3450 RPM | | |
| SERVICE FACTOR | 1.15 | | |
| INSULATION CLASS | F | | |
| FULL LOAD AMPS; 115 / 230 | 13.0 / 6.5 A | | |
| EFFICIENCY / POWER FACTOR | <u>LOAD</u> | <u>EFF.</u> | <u>P.F.</u> |
| | 100% | 77.0% | 0.72 |
| DUTY CYCLE | Continuous | | |
| MAX. AMBIENT TEMPERATURE | 40° C | | |
| MAX. ELEVATION | 3300 Ft. Above Sea Level | | |
| TEMPERATURE RISE (At Full Load) | 80° C | | |
| THERMAL PROTECTOR | Manual | | |
| DE BEARING | 6203 | | |
| ODE BEARING | 6203 | | |
| REGREASING INT. - DE BEARING | --- | | |
| REGREASING INT. - ODE BEARING | --- | | |
| GREASE TYPE | Mobil Polyrex EM | | |
| MOUNTING | F1 | | |
| ROTATION | Bi-Directional | | |
| CONNECTION DIAGRAM | 115/230 V - 6 Lead | | |
| APPROXIMATE WEIGHT | 31 lbs. | | |
| INVERTER RATING | --- | | |
| OPTIONS / ACCESSORIES | Base | NBASE56-2 | |
| | Capacitor (Start) | NSC56-4 (800UF/165V) | |
| | Capacitor (Run) | NRC56 (40UF/250V) | |
| | Capacitor Cover (Start) | NSCCOVER56 | |
| | Capacitor Cover (Run) | NRCCOVER56 | |
| | Centrifugal Switch | NCSWITCH56 | |
| | Endbell (DE) | NDEEBELL56-2 | |
| | Endbell (ODE) | NODEEBELL56 | |
| | Fan | NFAN56 | |
| | Fan Cover | NFCOVER56 | |
| | Junction Box | NJBOX56 | |
| Stationary Switch | NSSWITCH56 | | |



WORLDWIDE ELECTRIC MOTOR DRAWING

NTMOL1.5-36-56CB

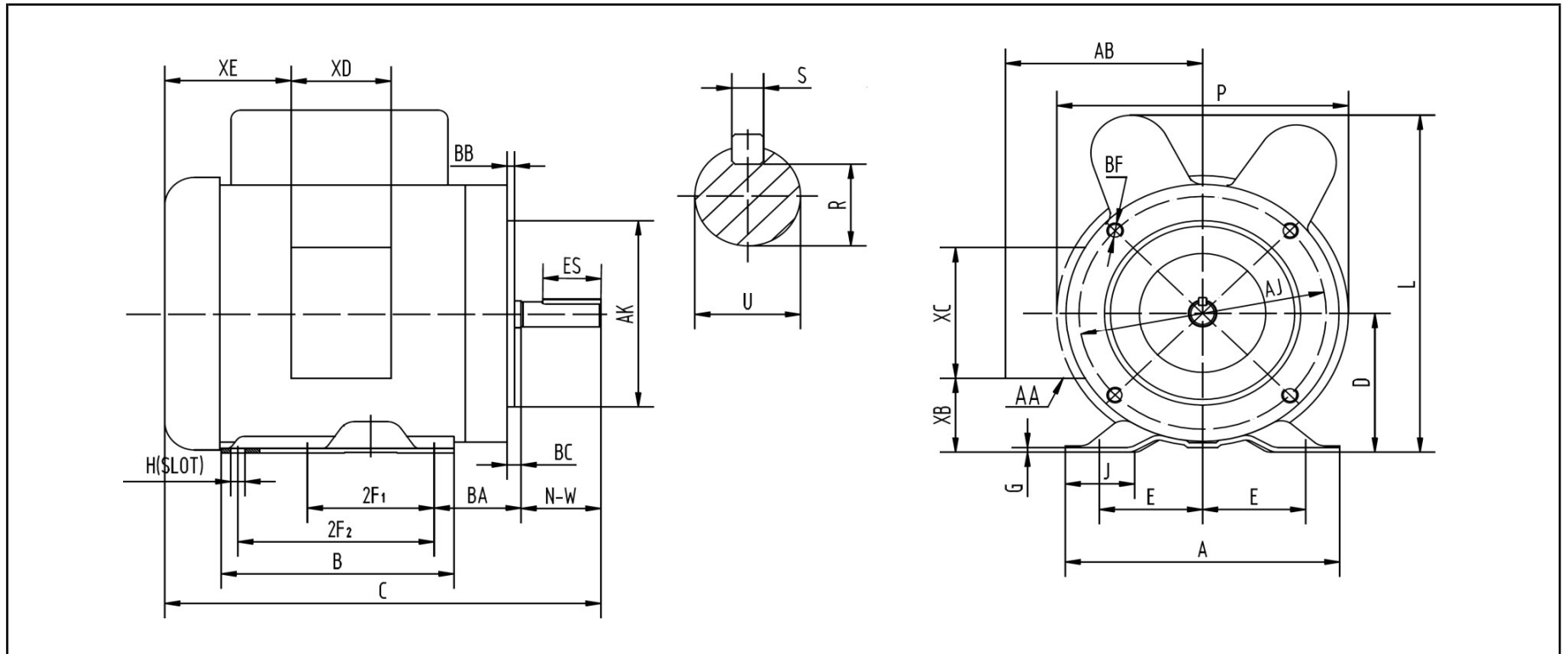

DIMENSIONS - INCHES

| MOUNTING | | | | | A | B | C | D | G | J | L | P | AB | BC |
|----------|-----|-----|------|------|------|------|------|-----|------|------|-----|-----|-----|-------|
| E | 2F1 | 2F2 | H | BA | | | | | | | | | | |
| 2.44 | 3 | 5 | 0.34 | 2.75 | 6.54 | 6.54 | 12.4 | 3.5 | 0.12 | 1.65 | 8.7 | 8.2 | 5.2 | -0.19 |

| KEY | | KEYSET | | FLANGE | | | | SHAFT | | TERMINAL BOX | | | | |
|-------|------|--------|-----|--------|--------|------|------|-------|------------------|--------------|-----|-----|------|--|
| S | ES | R | AK | AJ | BF | BB | N-W | U | AA | XB | XC | XD | XE | |
| 0.188 | 1.41 | 0.517 | 4.5 | 5.875 | 3/8-16 | 0.15 | 1.88 | 0.625 | 2-0.88 / 2-1.109 | 1.65 | 3.7 | 3.2 | 2.15 | |