

DATA SHEET

Premium Efficiency Motor: **NATJ13-36-56JB**

60 Hz

WorldWide Electric Corporation

1 (800) 808-2131

Worldwideelectric.net



Document Generated: 28-Feb-2023

Document ID:

Customer:

MOTOR INFORMATION

HP	1/3
RPM	3600
Phase	3
Frequency	60 Hz
Voltage	230/460
Frame Size	56J
Enclosure	TEFC
Degree of Protection	IP43
Service Factor	1.15
Poles	2
Full Load Speed	3450
Insulation Class	F
Temp Rise	80°C
NEMA Code Letter	T
Duty Cycle	S1 / Continuous
Slip	0.04%
NEMA Design	B
Moment of Inertia	0.0245 lb.ft.^2
Sound Pressure Level	78 dB(A)
Max Ambient Temperature	40°C
Max Elevation	1000 m.a.s.l (3300 f.a.s.l)
Mounting	F1
Base	C-Face Removable Base
Rotation	Clockwise
Standard	NEMA MG-1
Approvals	CSA, CE

EFFICIENCY/POWER FACTOR

LOAD	EFF	P. F.
100%	60.3 %	79.6
75%	56.0 %	72.7
50%	48.0 %	63.0

TORQUE

FULL LOAD	LRT	BDT
0.51 lb.ft.	180 %	355 %

AMPERAGE INFORMATION

	230V	460V
Full Load Amps	1.3	0.65
Locked Rotor Amps	7.26	3.63
No Load Current	0.88	0.44
Usable at 208V	--	

BEARING INFORMATION

DE Bearing	6203 2RS
ODE Bearing	6203 2RS

ADDITIONAL DATA

F2 Suitable	No
Shaft Material	AISI 420 Stainless
Connection Diagram	230 / 460 V - 9 Lead Y
Approximate Weight	18 lbs.

MOTOR DRAWING

Premium Efficiency Motor: **NATJ13-36-56JB**

WorldWide Electric Corporation

1 (800) 808-2131

Worldwideelectric.net

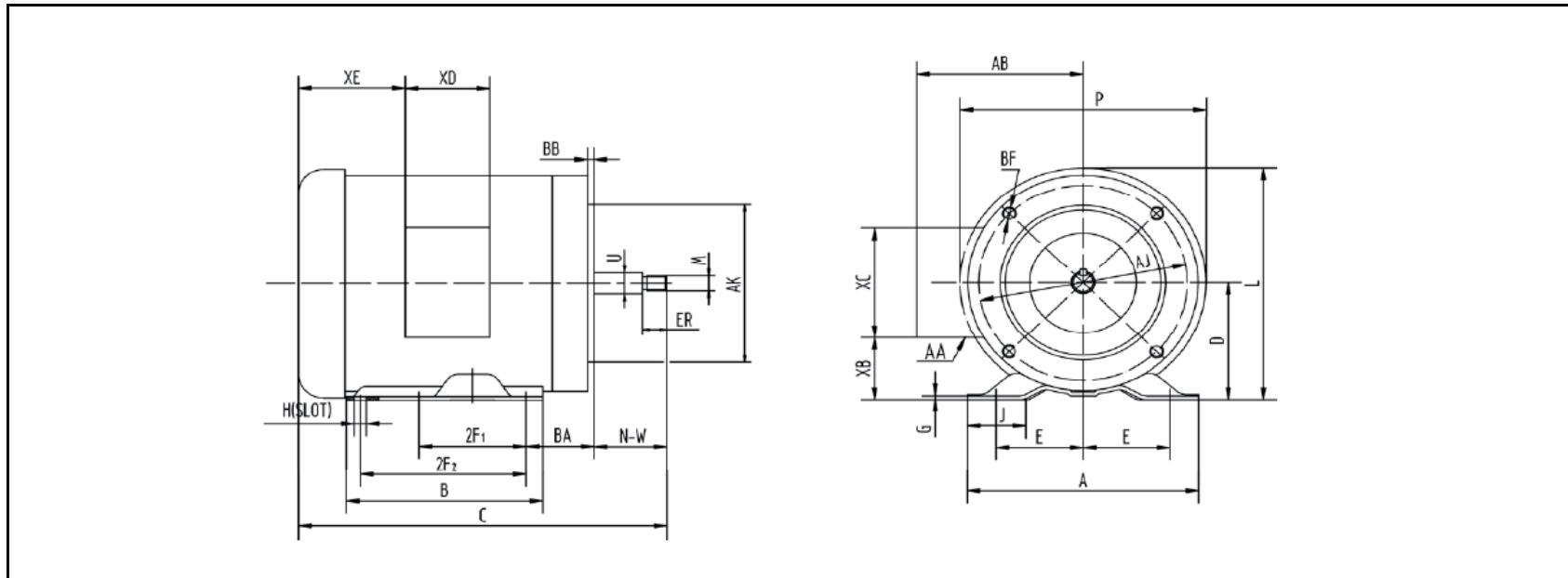

DIMENSION - INCHES

MOUNTING					A	B	C	D	G	J	L	P	AB
E	2F1	2F2	H	BA									
2.44	3	5	0.34	2.75	6.54	6.54	12.4	3.5	0.12	1.65	7.4	7.3	5.2

SHAFT & KEY			
ES	R	N-W	U
0.68	7/16-20	2.44	0.625

TERMINAL BOX				
AA	XB	XC	XD	XE
1/2 & 3/4	1.65	3.7	3.2	2.15

FLANGE				
AK	AJ	BF	BB	BC
4.5	5.875	3/8-16	0.16	-0.19

PERFORMANCE CURVES

WorldWide Electric Corporation

1 (800) 808-2131

Worldwideelectric.net



Premium Efficiency Motor:

NATJ13-36-56JB

Document Generated: 28-Feb-2023
 Document ID:

Customer:

Motor Type					
Output Rating (HP)	1/3		FL Speed	3450	
Full Load Torque	0.51 lb.ft		LRT (%FLT)	180	460 volt FLA 0.65
Rotor Wk^2	0.0245 lb-ft^2		BDT (%FLT)	355	230 volt FLA 1.3

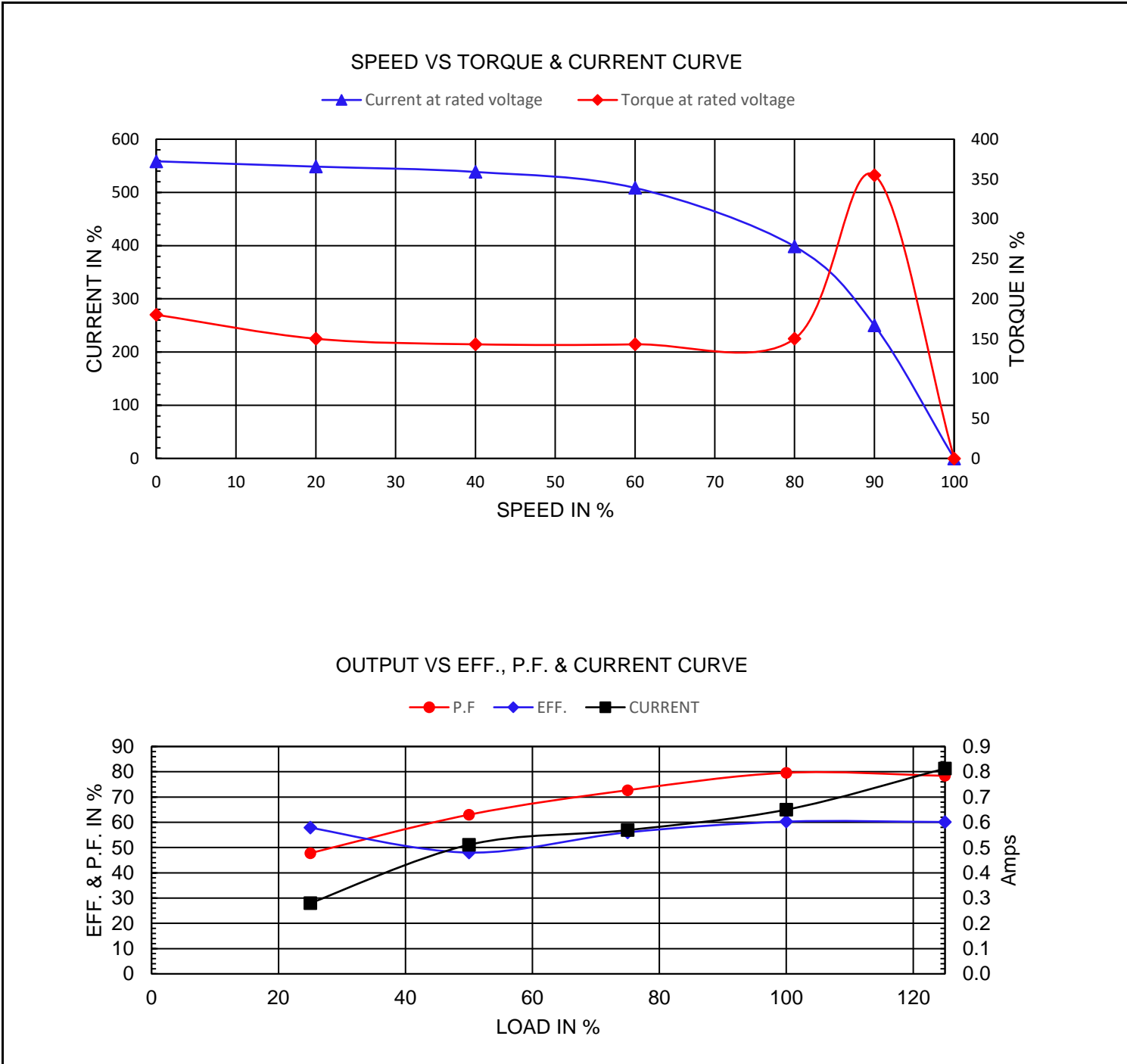

NAMEPLATE / WIRING

Premium Efficiency Motor: **NATJ13-36-56JB**

WorldWide Electric Corporation

1 (800) 808-2131

Worldwideelectric.net



Document Generated: 28-Feb-2023
Document ID:

Customer:

SAMPLE NAMEPLATE DATA

		<h3>INDUSTRIAL DUTY FRACTIONAL MOTOR</h3>			
MODEL	FRAME	LOW VOLTAGE		HIGH VOLTAGE	
Hz	ENCL.	BLUE (T1) — LINE2	BLUE (T1) — LINE2	WHITE (T2) — LINE1	WHITE (T2) — LINE1
HP	PH	BROWN (T7) — LINE2	ORANGE (T3) — LINE3	ORANGE (T3) — LINE3	ORANGE (T3) — LINE3
RPM	DUTY	WHITE (T2) — LINE1	RED (T8) — INS	YELLOW (T4) — INS	YELLOW (T4) — INS
VOLTS	CODE	RED (T8) — LINE1	ORANGE (T3) — LINE3	BROWN (T7) — INS	BROWN (T7) — INS
AMPS	INS.	YEL/BLA (T9) — LINE3	YELLOW (T4) — INS	BLACK (T5) — INS	BLACK (T5) — INS
S. F.	DES.	BLACK (T5) — INS	BLACK (T5) — INS	RED (T8) — INS	RED (T8) — INS
SFA.	LB/WT	GRAY (T6) — INS	GRAY (T6) — INS	GRAY (T6) — INS	GRAY (T6) — INS
MAX. AMB.	DE/ODE BRG.	ACCEPTABLE FOR FIELD WIRING		THERMALLY PROTECTED : NONE	
SERIAL NO. XXXXXX XXXX Date Code XX/XXXX					
WorldWide Electric Corporation					

Model	NATJ13-36-56JB	Frame	56J
Hz	60 Hz 50Hz	Encl	TEFC
HP	1/3 1/4	PH	3
RPM	3450 2850	DUTY	CONT
Voltage	230/460 190/380	Code	T
Amps	1.3/0.65 1.2/0.6	Ins Cl	F
S.F.	1.15 1.15	Design	B
SFA.	1.5/0.75 1.2/0.6	LB/WT	18 lbs.
Nom.Eff.	60.3%	DE Brng	6203 2RS
IP	IP43	ODE Brng	6203 2RS
MAX. AMB	40°C		