

DATA SHEET

Premium Efficiency Motor: **LAM300-18-449TBB-IB**

60 Hz

WorldWide Electric Corporation

1 (800) 808-2131

Worldwideelectric.net



Document Generated: 8-Sep-2023
Document ID:

Customer:

MOTOR INFORMATION	
HP	300
RPM	1800
Phase	3
Frequency	60 Hz
Voltage	460
Frame Size	447/9T
Enclosure	TEFC
Degree of Protection	IP55
Service Factor	1.15
Poles	4
Full Load Speed	1790
Insulation Class	F
Temp Rise	80°C
NEMA Code Letter	G
Duty Cycle	S1 / Continuous
Slip	0.56%
NEMA Design	B
Moment of Inertia	112.5 lb.ft.^2
Locked Rotor Time (Hot)	12 seconds
Sound Pressure Level	105 dB(A)
Number of Starts	2 Cold/1 Hot
Max Ambient Temperature	40°C
Max Elevation	1000 m.a.s.l (3300 f.a.s.l)
Mounting	Rigid
Rotation	Bi-Directional
Area of Classification	Class 1 Division 2 Groups A,B,C,D T3B
Inverter Rating	10:1 CT / 20:1 VT
Standard	NEMA MG-1
Approvals	UL, CE, IEEE45, ABS

EFFICIENCY/POWER FACTOR		
LOAD	EFF	P. F.
100%	96.2 %	0.91
75%	96.9 %	0.90
50%	96.8 %	0.86

TORQUE		
FULL LOAD	LRT	BDT
866 lb.ft.	251 %	354 %

AMPERAGE INFORMATION		
	230V	460V
Full Load Amps	--A	313.1A
Locked Rotor Amps	--A	2354A
No Load Current	--A	71.4A
Usable at 208V		-- A

BEARING INFORMATION	
DE Bearing	6320 C3
ODE Bearing	6316 C3
Grease Type	Mobil Polyrex EM
DE Regreasing Interval	2400 Hours
ODE Regreasing Interval	3600 Hours
Grease Quantity	51g/33g

ADDITIONAL DATA	
F2 Suitable	Yes
Shaft Material	4140
Connection Diagram	6 Lead Delta
Approximate Weight	2784.5 lbs.

MOTOR DRAWING

Premium Efficiency Motor: **LAM300-18-449TBB-IB**

WorldWide Electric Corporation

1 (800) 808-2131

Worldwideelectric.net

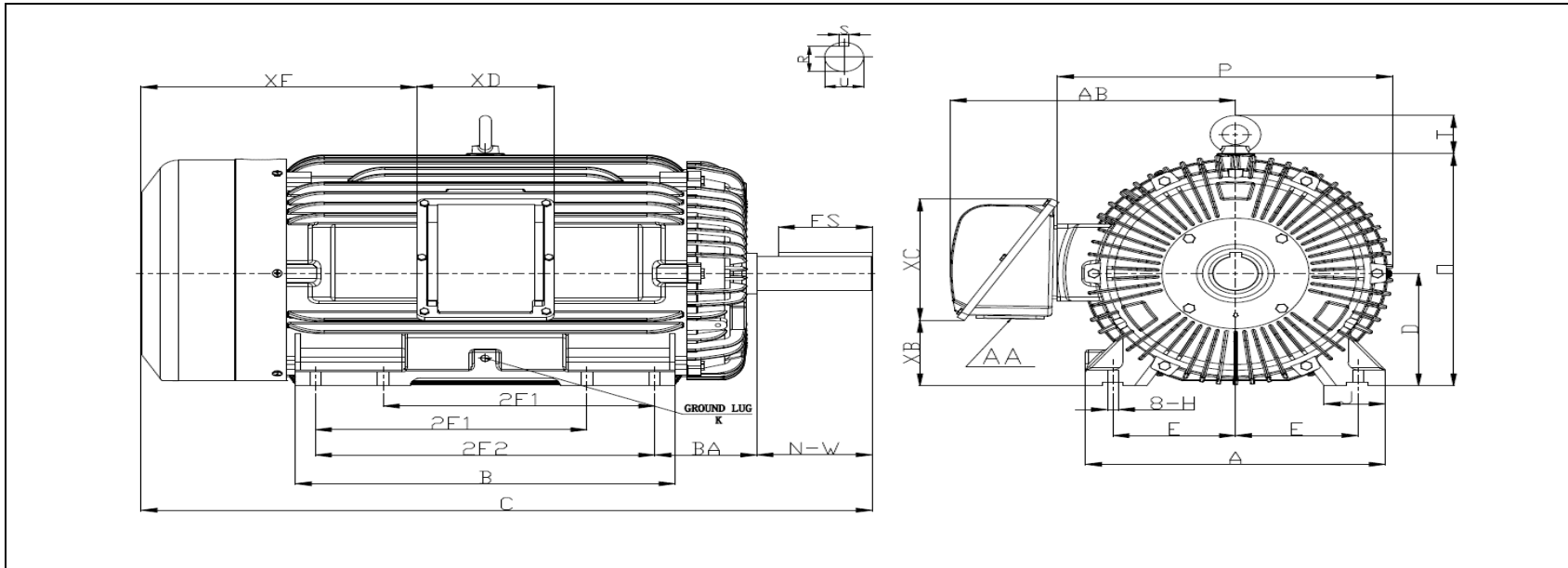

DIMENSION - INCHES

MOUNTING					A	B	C	D	G	J	P	O	T	AB
E	2F1	2F2	H	BA										
9	20	25	0.81	7.5	22	29	54.4	11	1.417	4.33	25.8	23.8	4.06	23.4

SHAFT & KEY				
S	ES	R	N-W	U
0.875	6.91	2.88	8.5	3.375

TERMINAL BOX				
AA	XB	XC	XD	XE
3 NPT	4.13	16.2	11.6	19.2

GROUND LUG
M12

PERFORMANCE CURVES

Premium Efficiency Motor:

LAM300-18-449TBB-IB

WorldWide Electric Corporation

1 (800) 808-2131

Worldwideelectric.net



Document Generated: 8-Sep-2023
Document ID:

Customer:

Motor Type	AEH3		FL Speed	1790	
Output Rating (HP)	300		LRT (%FLT)	251	460 volt FLA 313.1
Full Load Torque	866 lb.ft		BDT (%FLT)	354	230 volt FLA --
Rotor Wk^2	112.5 lb-ft^2				

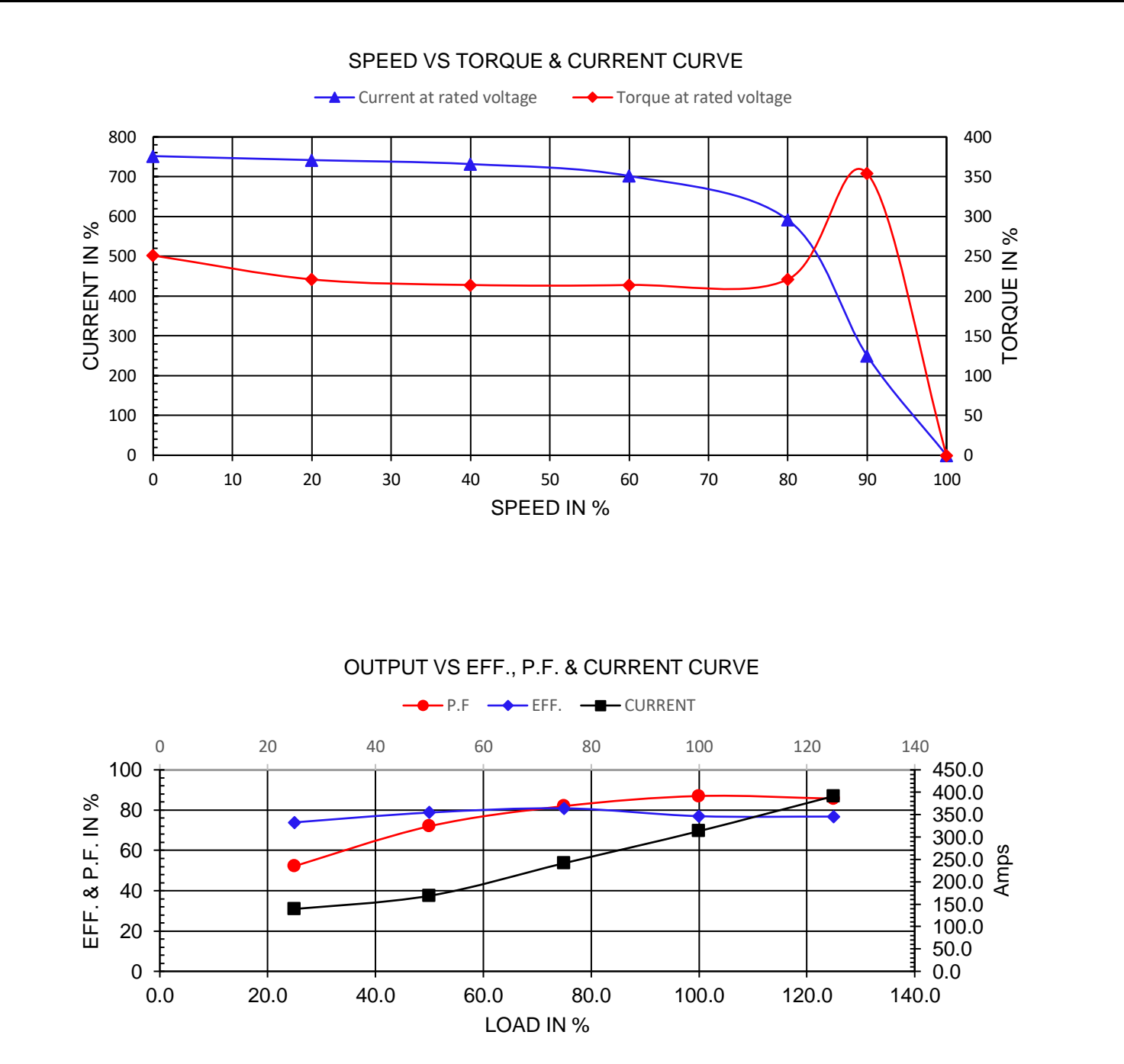

NAMEPLATE / WIRING

Premium Efficiency Motor: **LAM300-18-449TBB-IB**

WorldWide Electric Corporation

1 (800) 808-2131

Worldwideelectric.net



Document Generated: 8-Sep-2023
Document ID:

Customer:

SAMPLE NAMEPLATE DATA

		THREE PHASE SEVERE DUTY MOTOR IEEE45							
Model :			Encl :	Type :	SN :				
HP :	Poles :	FR:	Ins:	Duty: Cont	IP :	Max Amb 40°C			
Hz :		CODE :	Hz :	HP :	Design :				
Volts :		P.F :	Volts :		DE BRG :				
Amps :		Eff :	Amps :		ODE BRG :				
RPM :		S.F :	RPM :		WT :				
				S.F :		Date :			
CC306B					LOUIS ALLIS A WORLDWIDE ELECTRIC COMPANY				UL certified Class I, Division II, Groups A,B,C,D T3B

Model:	LAM300-18-449TBB-IB	Encl:	TEFC	Type:	AEH3
HP:	300	Poles	4	FR:	447/9T
Hz:	60	CODE:	G	Ins:	F
Volts:	460	P.F:	0.91	HP:	250
Amps:	313.1	Eff:	0.962	Design:	B
RPM:	1790	S.F:	1.15	DE BRG:	6320 C3
				ODE BRG:	6316 C3
				WT:	2784.5 lbs.
				S.F:	1.00