

DATA SHEET

Premium Efficiency Motor: **NAT12-18-56CB**

60 Hz

WorldWide Electric Corporation

1 (800) 808-2131

Worldwideelectric.net



Document Generated: 27-Feb-2023

Document ID:

Customer:

MOTOR INFORMATION

HP	1/2
RPM	1800
Phase	3
Frequency	60 Hz
Voltage	230/460
Frame Size	56C
Enclosure	TEFC
Degree of Protection	IP43
Service Factor	1.15
Poles	4
Full Load Speed	1725
Insulation Class	F
Temp Rise	80°C
NEMA Code Letter	M
Duty Cycle	S1 / Continuous
Slip	0.04%
NEMA Design	B
Moment of Inertia	0.0381 lb.ft.^2
Sound Pressure Level	68 dB(A)
Max Ambient Temperature	40°C
Max Elevation	1000 m.a.s.l (3300 f.a.s.l)
Mounting	F1
Base	C-Face Removable Base
Rotation	Bi-Directional
Standard	NEMA MG-1
Approvals	CSA, CE

EFFICIENCY/POWER FACTOR

LOAD	EFF	P. F.
100%	70.7 %	71.9
75%	69.4 %	62.3
50%	64.6 %	49.2

TORQUE

FULL LOAD	LRT	BDT
1.51 lb.ft.	250 %	325 %

AMPERAGE INFORMATION

	230V	460V
Full Load Amps	1.9	1.61
Locked Rotor Amps	10.16	5.08
No Load Current	1.36	0.68
Usable at 208V	--	

BEARING INFORMATION

DE Bearing	6203 2RS
ODE Bearing	6203 2RS

ADDITIONAL DATA

F2 Suitable	No
Shaft Material	1045 Carbon Steel
Connection Diagram	230 / 460 V - 9 Lead Y
Approximate Weight	19 lbs.

MOTOR DRAWING

Premium Efficiency Motor: **NAT12-18-56CB**

WorldWide Electric Corporation

1 (800) 808-2131

Worldwideelectric.net

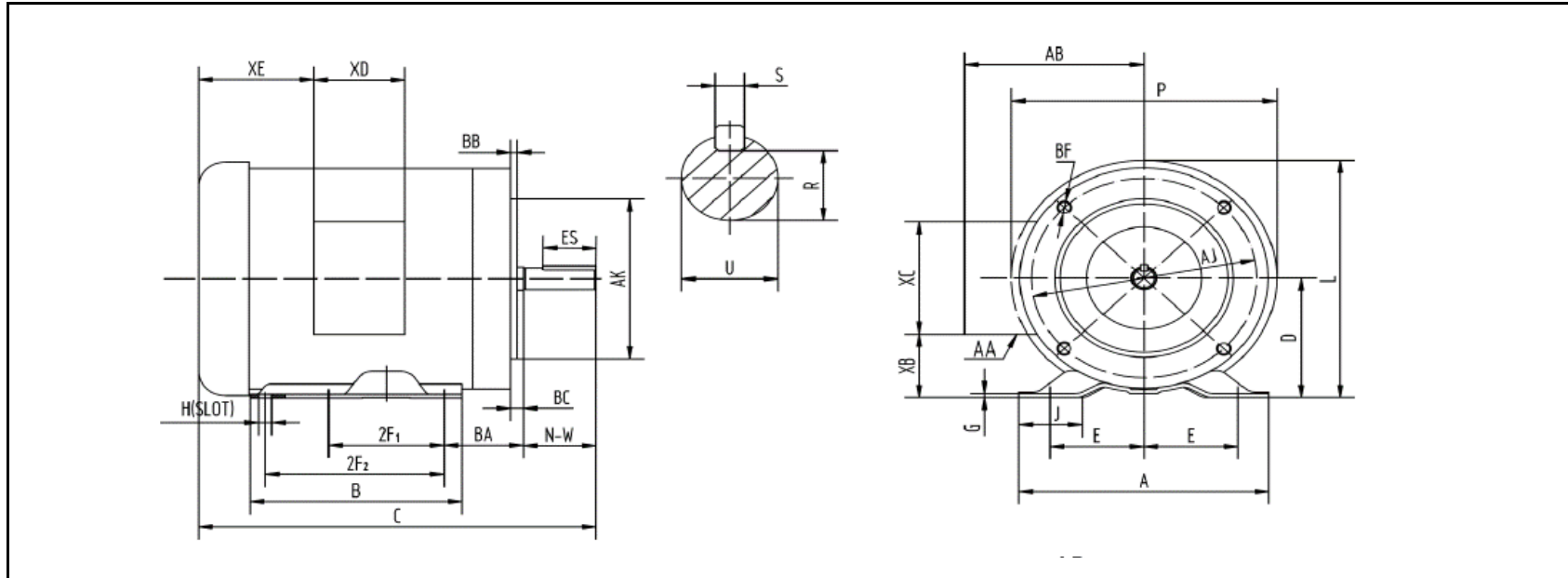

DIMENSION - INCHES

MOUNTING					A	B	C	D	G	J	L	P	AB
E	2F1	2F2	H	BA									
2.44	3	5	0.34	2.75	6.54	6.54	11.9	3.5	0.1	1.65	7.4	7.3	5.2

SHAFT & KEY				
S	ES	R	N-W	U
0.188	1.41	0.517	1.88	0.625

TERMINAL BOX				
AA	XB	XC	XD	XE
3-0.88/2-1.109	1.65	3.7	3.2	2.15

FLANGE				
AK	AJ	BF	BB	BC
4.5	5.875	3/8-16	0.16	-0.19

PERFORMANCE CURVES

WorldWide Electric Corporation

1 (800) 808-2131

Worldwideelectric.net



Premium Efficiency Motor:

NAT12-18-56CB

Document Generated: 27-Feb-2023
Document ID:

Customer:

Motor Type					
Output Rating (HP)	1/2		FL Speed	1725	
Full Load Torque	1.51 lb.ft		LRT (%FLT)	250	460 volt FLA 1.61
Rotor Wk ²	0.0381 lb-ft ²		BDT (%FLT)	325	230 volt FLA 1.9

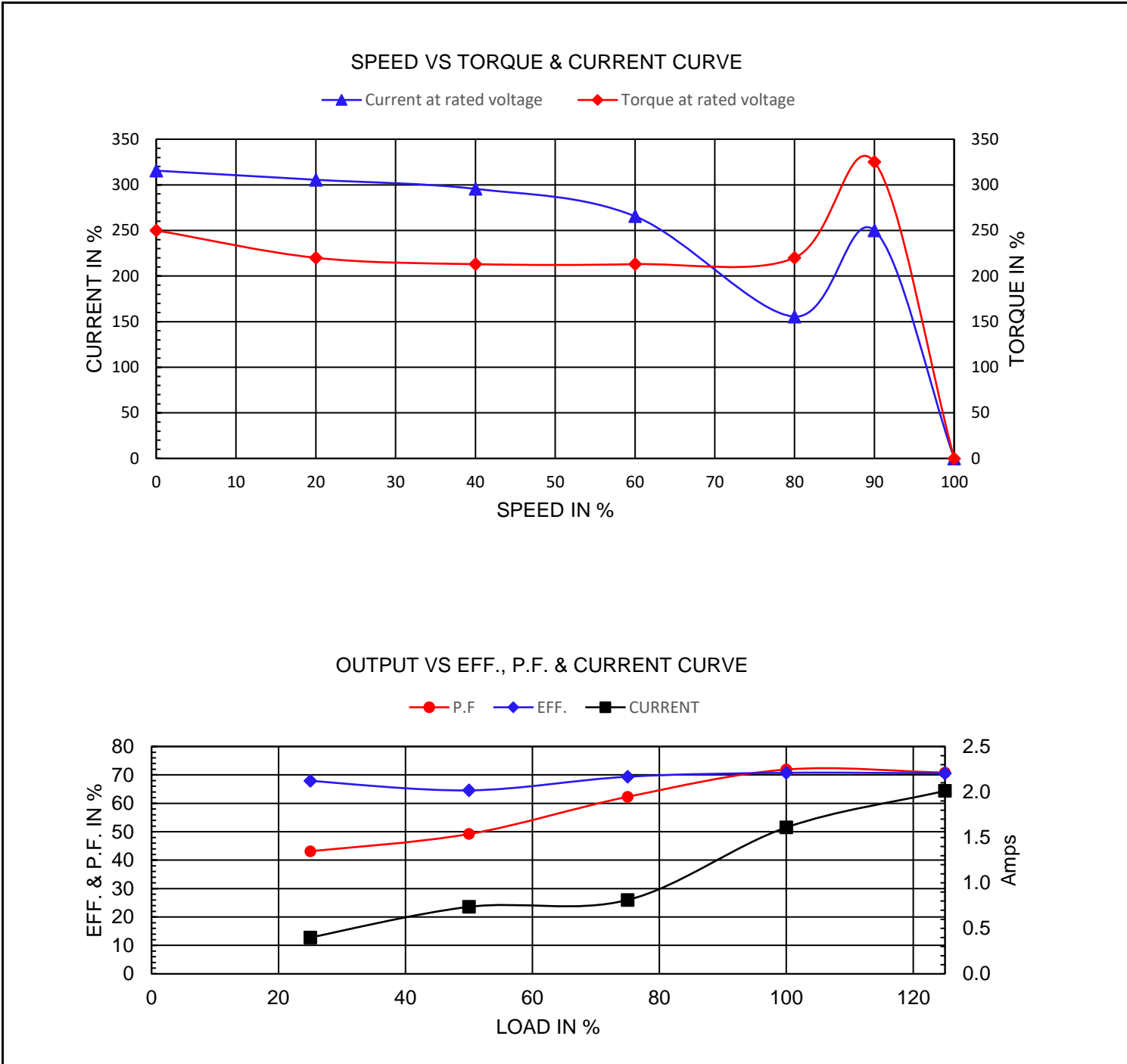

NAMEPLATE / WIRING

WorldWide Electric Corporation

1 (800) 808-2131

Worldwideelectric.net



Premium Efficiency Motor: **NAT12-18-56CB**

Document Generated: 27-Feb-2023
Document ID:

Customer:

SAMPLE NAMEPLATE DATA

		THREE PHASE INDUCTION MOTOR																								
		<table border="1"> <tr> <th>MODEL</th> <th>FRAME</th> </tr> <tr> <td>Hz</td> <td>ENCL. TEFC</td> </tr> <tr> <td>HP</td> <td>PH 3</td> </tr> <tr> <td>RPM</td> <td>DUTY CONT</td> </tr> <tr> <td>VOLTS</td> <td>CODE</td> </tr> <tr> <td>AMPS</td> <td>INS. F</td> </tr> <tr> <td></td> <td>DES.</td> </tr> <tr> <td>S. F.</td> <td>LB/WT</td> </tr> <tr> <td>NOM. EFF (60Hz)</td> <td>DE/ODE BRG.</td> </tr> <tr> <td>MAX. AMB. 40°C</td> <td>Date Code XX/XXXX</td> </tr> </table>		MODEL	FRAME	Hz	ENCL. TEFC	HP	PH 3	RPM	DUTY CONT	VOLTS	CODE	AMPS	INS. F		DES.	S. F.	LB/WT	NOM. EFF (60Hz)	DE/ODE BRG.	MAX. AMB. 40°C	Date Code XX/XXXX	<p>LOW VOLTAGE</p> <p>BLUE (T1) — LINE1</p> <p>BROWN (T7) — LINE1</p> <p>WHITE (T2) — LINE2</p> <p>RED (T8) — LINE2</p> <p>ORANGE (T3) — LINE3</p> <p>YEL/BLA (T9) — LINE3</p> <p>YELLOW (T4) — INS</p> <p>BLACK (T5) — INS</p> <p>GRAY (T6) — INS</p>		<p>HIGH VOLTAGE</p> <p>BLUE (T1) — LINE1</p> <p>WHITE (T2) — LINE2</p> <p>ORANGE (T3) — LINE3</p> <p>YELLOW (T4) — INS</p> <p>BROWN (T7) — INS</p> <p>BLACK (T5) — INS</p> <p>RED (T8) — INS</p> <p>GRAY (T6) — INS</p> <p>YEL/BLA (T9) — INS</p>
MODEL	FRAME																									
Hz	ENCL. TEFC																									
HP	PH 3																									
RPM	DUTY CONT																									
VOLTS	CODE																									
AMPS	INS. F																									
	DES.																									
S. F.	LB/WT																									
NOM. EFF (60Hz)	DE/ODE BRG.																									
MAX. AMB. 40°C	Date Code XX/XXXX																									
ACCEPTABLE FOR FIELD WIRING THERMALLY PROTECTED : NONE																										
SERIAL NO. XXXXXXXXXX				WorldWide Electric Corporation																						

Model	NAT12-18-56CB	Frame	56C
Hz	60 Hz 50Hz	Encl	TEFC
HP	1/2 1/3	PH	3
RPM	1725 1425	DUTY	CONT
Voltage	230/460 190/380	Code	M
Amps	3.29/1.61 1.7/0.85	Ins Cl	F
IP	IP43	Design	B
S.F.	1.15 1.00	LB/WT	19 lbs.
Nom.Eff.	70.7%	DE Brng	6203 2RS
		ODE Brng	6203 2RS