

# DATA SHEET

Premium Efficiency Motor: **NAT13-18-56CB**

**60 Hz**

WorldWide Electric Corporation

1 (800) 808-2131

Worldwideelectric.net



Document Generated: 27-Feb-2023

Document ID:

Customer:

## MOTOR INFORMATION

HP	1/3
RPM	1800
Phase	3
Frequency	60 Hz
Voltage	230/460
Frame Size	56C
Enclosure	TEFC
Degree of Protection	IP43
Service Factor	1.15
Poles	4
Full Load Speed	1725
Insulation Class	F
Temp Rise	80°C
NEMA Code Letter	N
Duty Cycle	S1 / Continuous
Slip	0.04%
NEMA Design	B
Moment of Inertia	0.0329 lb.ft.^2
Sound Pressure Level	68 dB(A)
Max Ambient Temperature	40°C
Max Elevation	1000 m.a.s.l (3300 f.a.s.l)
Mounting	F1
Base	C-Face Removable Base
Rotation	Bi-Directional
Standard	NEMA MG-1
Approvals	CSA, CE

## EFFICIENCY/POWER FACTOR

LOAD	EFF	P. F.
100%	68.5 %	66.4
75%	65.9 %	56.9
50%	59.7 %	45.0

## TORQUE

FULL LOAD	LRT	BDT
1.02 lb.ft.	285 %	370 %

## AMPERAGE INFORMATION

	230V	460V
Full Load Amps	1.4	0.95
Locked Rotor Amps	13.66	6.83
No Load Current	2.12	1.06
Usable at 208V	--	

## BEARING INFORMATION

DE Bearing	6203 2RS
ODE Bearing	6203 2RS

## ADDITIONAL DATA

F2 Suitable	No
Shaft Material	1045 Carbon Steel
Connection Diagram	230 / 460 V - 9 Lead Y
Approximate Weight	17.5 lbs.

# MOTOR DRAWING

Premium Efficiency Motor: **NAT13-18-56CB**

WorldWide Electric Corporation

1 (800) 808-2131

Worldwideelectric.net

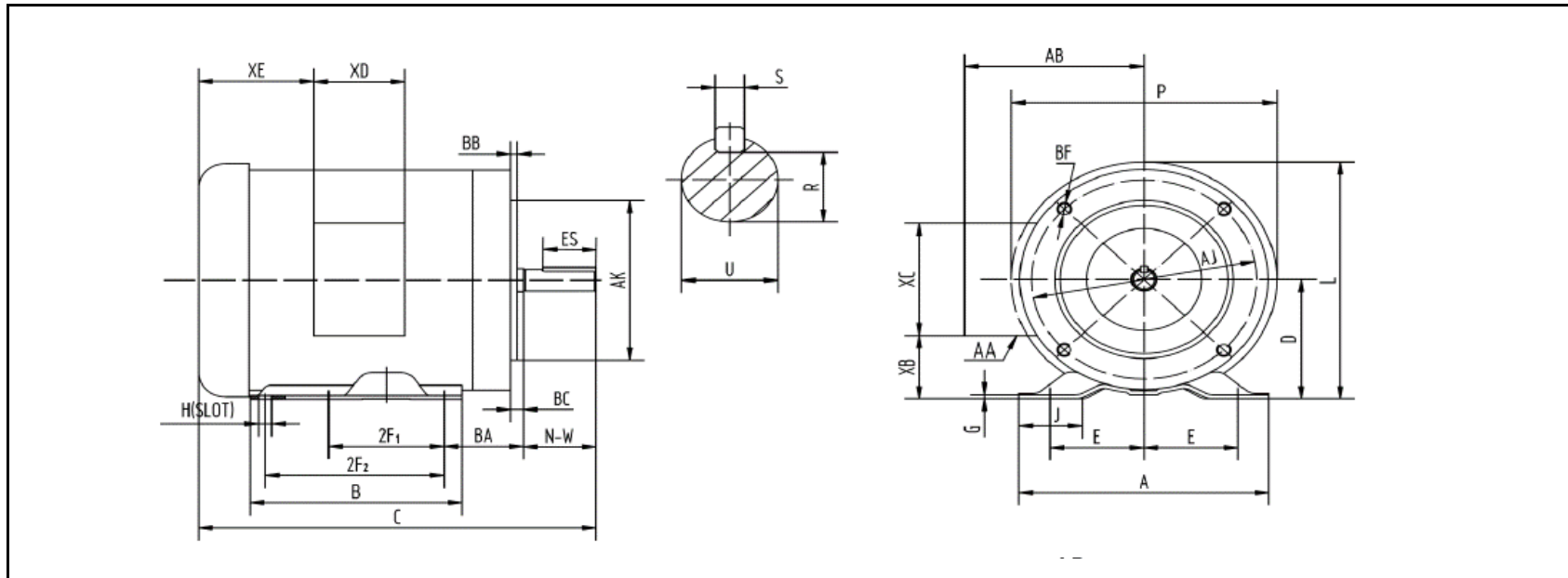

## DIMENSION - INCHES

MOUNTING					A	B	C	D	G	J	L	P	AB
E	2F1	2F2	H	BA									
2.44	3	5	0.34	2.75	6.54	6.54	11.9	3.5	0.1	1.65	7.4	7.3	5.2

SHAFT & KEY				
S	ES	R	N-W	U
0.188	1.41	0.517	1.88	0.625

TERMINAL BOX				
AA	XB	XC	XD	XE
3-0.88/2-1.109	1.65	3.7	3.2	2.15

FLANGE				
AK	AJ	BF	BB	BC
4.5	5.875	3/8-16	0.16	-0.19

# PERFORMANCE CURVES

WorldWide Electric Corporation

1 (800) 808-2131

Worldwideelectric.net



Premium Efficiency Motor:

**NAT13-18-56CB**

Document Generated: 27-Feb-2023  
Document ID:

Customer:

Motor Type					
Output Rating (HP)	1/3		FL Speed	1725	
Full Load Torque	1.02 lb.ft		LRT (%FLT)	285	460 volt FLA 0.95
Rotor Wk <sup>2</sup>	0.0329 lb-ft <sup>2</sup>		BDT (%FLT)	370	230 volt FLA 1.4

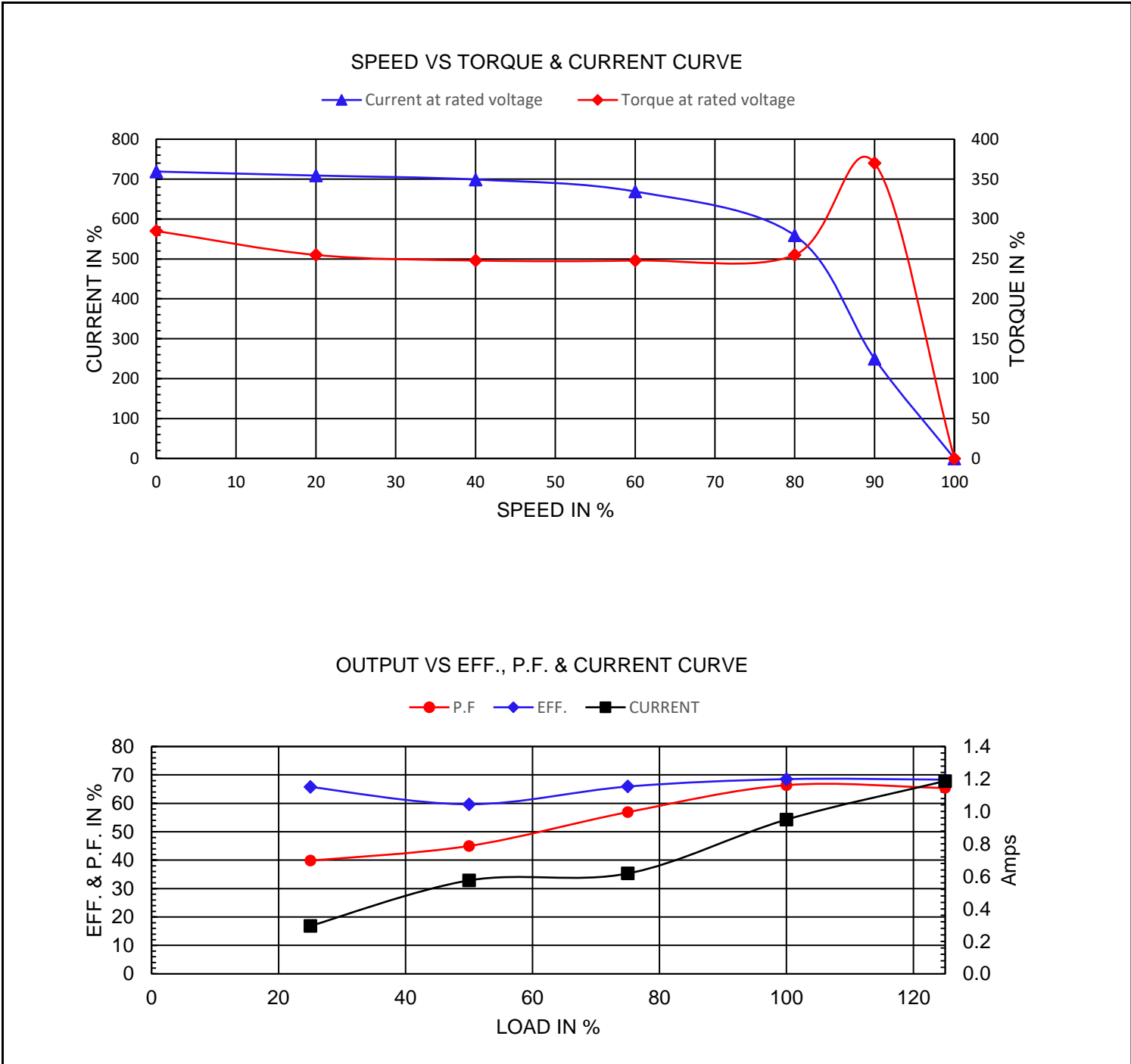

# NAMEPLATE / WIRING

Premium Efficiency Motor: **NAT13-18-56CB**

WorldWide Electric Corporation

1 (800) 808-2131

Worldwideelectric.net



Document Generated: 27-Feb-2023  
Document ID:

Customer:

## SAMPLE NAMEPLATE DATA

		<b>THREE PHASE INDUCTION MOTOR</b>			
<b>MODEL</b>	<b>FRAME</b>	<b>LOW VOLTAGE</b> BLUE (T1) — LINE1 BROWN (T7) — LINE1 WHITE (T2) — LINE2 RED (T8) — LINE2 ORANGE (T3) — LINE3 YEL/BLA (T9) — LINE3 YELLOW (T4) — INS BLACK (T5) — INS GRAY (T6) — INS		<b>HIGH VOLTAGE</b> BLUE (T1) — LINE1 WHITE (T2) — LINE2 ORANGE (T3) — LINE3 YELLOW (T4) — INS BROWN (T7) — INS BLACK (T5) — INS RED (T8) — INS GRAY (T6) — INS YEL/BLA (T9) — INS	
Hz	ENCL. TEFC				
HP	PH 3				
RPM	DUTY CONT				
VOLTS	CODE				
AMPS	INS. F				
	DES.				
S. F.	LB/WT				
NOM. EFF (60Hz)	DE/ODE BRG.				
MAX. AMB. 40°C	Date Code XX/XXXX				
SERIAL NO. XXXXXXXXXX		WorldWide Electric Corporation			

<b>Model</b>	NAT13-18-56CB	<b>Frame</b>	56C
<b>Hz</b>	60 Hz    50Hz	<b>Encl</b>	TEFC
<b>HP</b>	1/3        1/4	<b>PH</b>	3
<b>RPM</b>	1725      1425	<b>DUTY</b>	CONT
<b>Voltage</b>	230/460    190/380	<b>Code</b>	N
<b>Amps</b>	1.9/0.95    1.3/0.65	<b>Ins Cl</b>	F
<b>IP</b>	IP43	<b>Design</b>	B
<b>S.F.</b>	1.15        1.00	<b>LB/WT</b>	17.5 lbs.
<b>Nom.Eff.</b>	68.5%	<b>DE Brng</b>	6203 2RS
		<b>ODE Brng</b>	6203 2RS