

DATA SHEET

Premium Efficiency Motor: **NATE1-18-56CB**

60 Hz

WorldWide Electric Corporation

1 (800) 808-2131

Worldwideelectric.net



Document Generated: 24-Feb-2023
Document ID:

Customer:

MOTOR INFORMATION	
HP	1
RPM	1800
Phase	3
Frequency	60 Hz
Voltage	230/460
Frame Size	56HC
Enclosure	TEFC
Degree of Protection	IP43
Service Factor	1.15
Poles	4
Full Load Speed	1760
Insulation Class	F
Temp Rise	80°C
NEMA Code Letter	J
Duty Cycle	S1 / Continuous
Slip	0.02%
NEMA Design	B
Moment of Inertia	0.1069 lb.ft.^2
Sound Pressure Level	68 dB(A)
Max Ambient Temperature	40°C
Max Elevation	1000 m.a.s.l (3300 f.a.s.l)
Mounting	F1
Base	C-Face Removable Base
Rotation	Bi-Directional
Standard	NEMA MG-1
Approvals	CSA, CE

EFFICIENCY/POWER FACTOR		
LOAD	EFF	P. F.
100%	85.7 %	69
75%	85.1 %	59.4
50%	82.1 %	46.0

TORQUE		
FULL LOAD	LRT	BDT
3 lb.ft.	410 %	480 %

AMPERAGE INFORMATION		
	230V	460V
Full Load Amps	3.29	1.61
Locked Rotor Amps	31.22	15.61
No Load Current	2.18	1.09
Usable at 208V	3	

BEARING INFORMATION	
DE Bearing	6203 2RS
ODE Bearing	6203 2RS

ADDITIONAL DATA	
F2 Suitable	No
Shaft Material	1045 Carbon Steel
Connection Diagram	230 / 460 V - 9 Lead Y
Approximate Weight	35 lbs.

MOTOR DRAWING

Premium Efficiency Motor: **NATE1-18-56CB**

WorldWide Electric Corporation

1 (800) 808-2131

Worldwideelectric.net

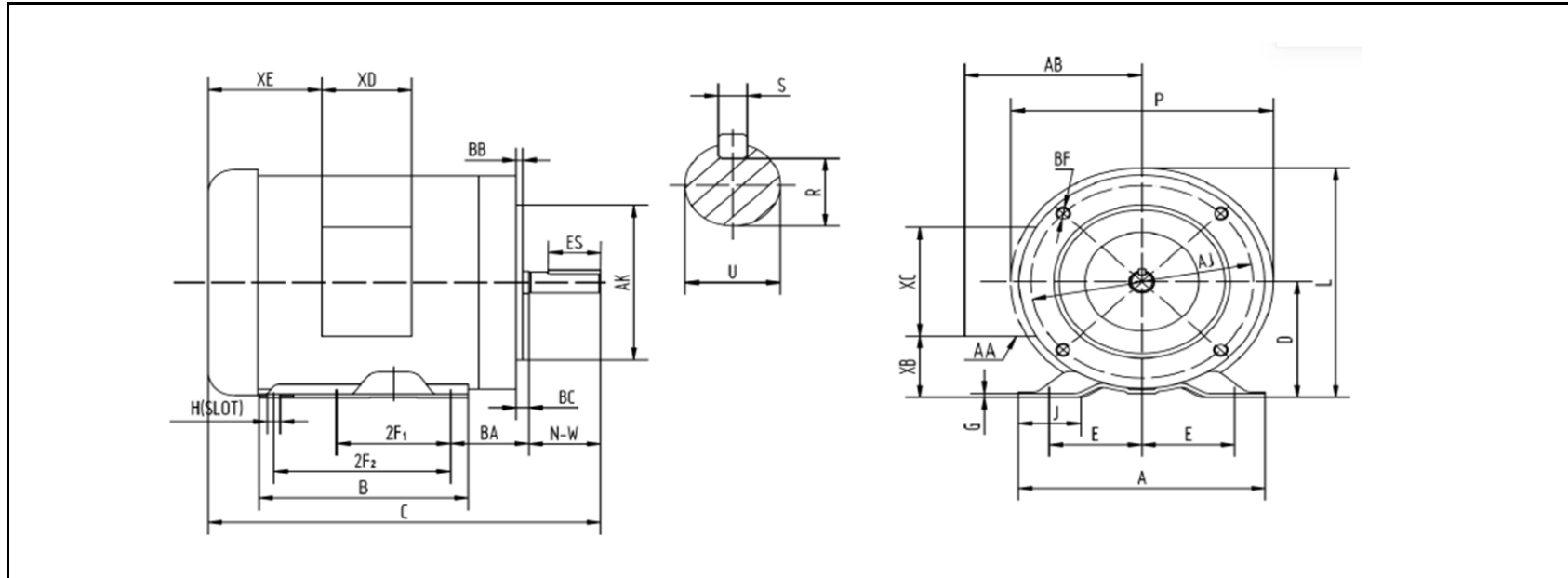

DIMENSION - INCHES

MOUNTING					A	B	C	D	G	J	L	P	AB
E	2F1	2F2	H	BA									
2.44	3	5	0.34	2.75	6.54	6.54	12.4	3.5	0.12	1.65	7.4	7.3	5.2

SHAFT & KEY				
S	ES	R	N-W	U
0.188	1.41	0.517	1.88	0.625

TERMINAL BOX				
AA	XB	XC	XD	XE
3-0.88/2-1.109	1.65	3.7	3.2	2.15

FLANGE				
AK	AJ	BF	BB	BC
4.5	5.875	3/8-16	0.16	-0.19

PERFORMANCE CURVES

WorldWide Electric Corporation

1 (800) 808-2131

Worldwideelectric.net



Premium Efficiency Motor:

NATE1-18-56CB

Document Generated: 24-Feb-2023
 Document ID:

Customer:

Motor Type					
Output Rating (HP)	1		FL Speed	1760	
Full Load Torque	3 lb.ft		LRT (%FLT)	410	460 volt FLA 1.61
Rotor Wk ²	0.1069 lb-ft ²		BDT (%FLT)	480	230 volt FLA 3.29

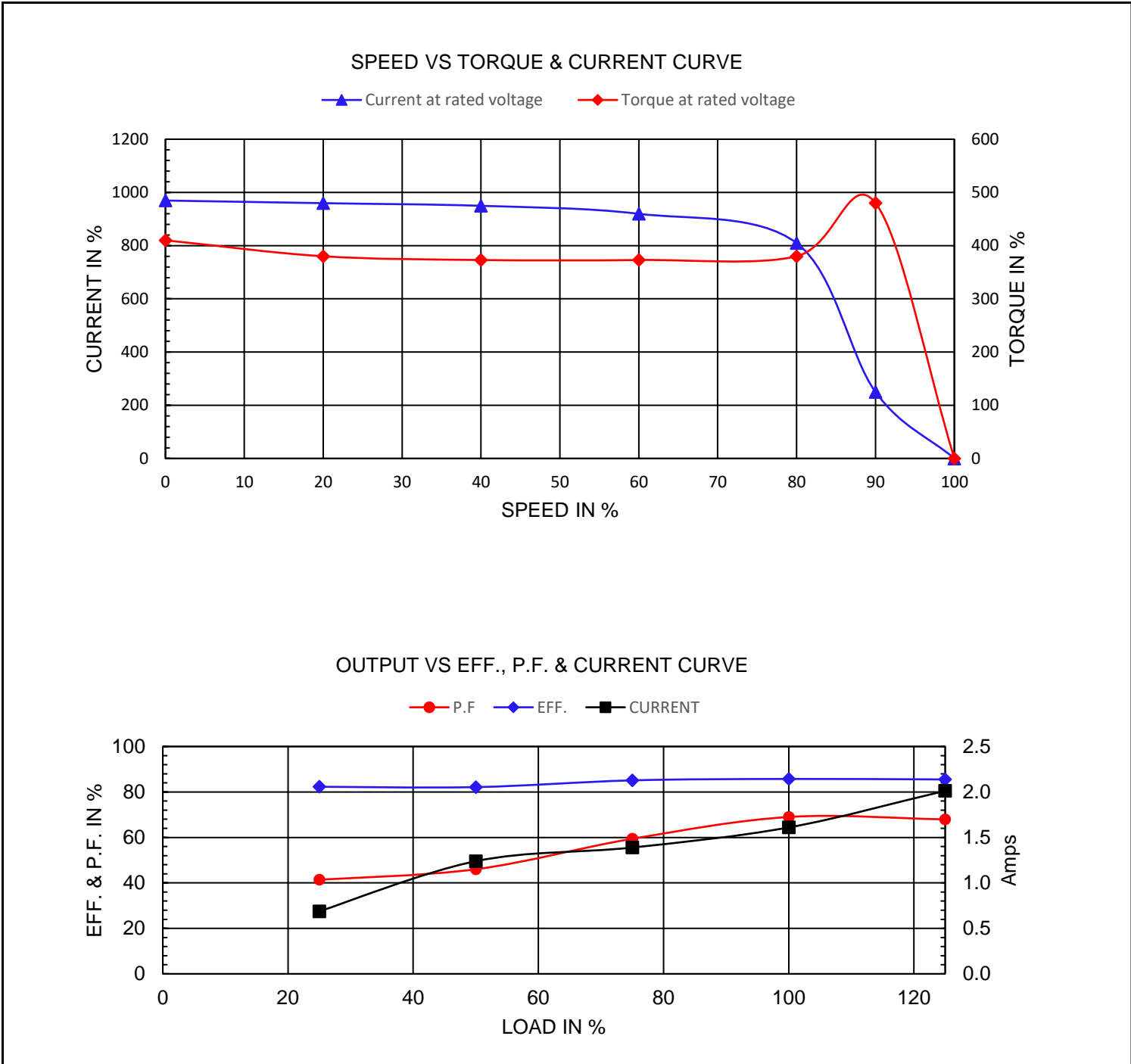

NAMEPLATE / WIRING

WorldWide Electric Corporation

1 (800) 808-2131

Worldwideelectric.net



Premium Efficiency Motor: **NATE1-18-56CB**

Document Generated: 24-Feb-2023
Document ID:

Customer:

SAMPLE NAMEPLATE DATA

		THREE PHASE INDUCTION MOTOR				
				C US Energy Verified 256950		CC315B
MODEL	FRAME	LOW VOLTAGE		HIGH VOLTAGE		
Hz	ENCL. TEFC	BLUE (T1) —	LINE1	BLUE (T1) —	LINE1	MADE IN CHINA
HP	PH 3	BROWN (T7) —	LINE2	WHITE (T2) —	LINE2	
RPM	DUTY CONT	WHITE (T2) —	LINE2	ORANGE (T3) —	LINE3	
VOLTS	CODE	RED (T8) —	LINE3	YELLOW (T4) —	INS	
AMPS	INS. F	ORANGE (T3) —	INS	BROWN (T7) —	INS	
	DES.	YEL/BLA (T9) —	INS	BLACK (T5) —	INS	
S. F.	LB/WT	YELLOW (T4) —		RED (T8) —	INS	
		BLACK (T5) —		GRAY (T6) —	INS	
		GRAY (T6) —		YEL/BLA (T9) —	INS	
NOM. EFF (60Hz)	DE/ODE BRG.	ACCEPTABLE FOR FIELD WIRING THERMALLY PROTECTED : NONE				
MAX. AMB. 40°C	Date Code XX/XXXX	SERIAL NO. XXXXXXXXXX WorldWide Electric Corporation				

Model	NATE1-18-56CB	Frame	56HC
Hz	60 Hz 50Hz	Encl	TEFC
HP	1 3/4	PH	3
RPM	1760 1465	DUTY	CONT
Voltage	230/460 190/380	Code	J
Amps	3.29/1.61 3.06/1.53	Ins Cl	F
IP	IP43	Design	B
S.F.	1.15 1.15	LB/WT	35 lbs.
Nom.Eff.	85.7%	DE Brng	6203 2RS
		ODE Brng	6203 2RS