

DATA SHEET

Premium Efficiency Motor: **NATE1-36-56CB**

60 Hz

WorldWide Electric Corporation

1 (800) 808-2131

Worldwideelectric.net



Document Generated: 24-Feb-2023

Document ID:

Customer:

MOTOR INFORMATION

| | |
|-------------------------|-----------------------------|
| HP | 1 |
| RPM | 3600 |
| Phase | 3 |
| Frequency | 60 Hz |
| Voltage | 230/460 |
| Frame Size | 56HC |
| Enclosure | TEFC |
| Degree of Protection | IP43 |
| Service Factor | 1.15 |
| Poles | 2 |
| Full Load Speed | 3500 |
| Insulation Class | F |
| Temp Rise | 80°C |
| NEMA Code Letter | H |
| Duty Cycle | S1 / Continuous |
| Slip | 0.03% |
| NEMA Design | B |
| Moment of Inertia | 0.0342 lb.ft.^2 |
| Sound Pressure Level | 73 dB(A) |
| Max Ambient Temperature | 40°C |
| Max Elevation | 1000 m.a.s.l (3300 f.a.s.l) |
| Mounting | F1 |
| Base | C-Face Removable Base |
| Rotation | Bi-Directional |
| Standard | NEMA MG-1 |
| Approvals | CSA, CE |

EFFICIENCY/POWER FACTOR

| LOAD | EFF | P. F. |
|------|--------|-------|
| 100% | 80.5 % | 83 |
| 75% | 79.8 % | 76.2 |
| 50% | 75.9 % | 64.4 |

TORQUE

| FULL LOAD | LRT | BDT |
|-------------|-------|-------|
| 1.51 lb.ft. | 260 % | 325 % |

AMPERAGE INFORMATION

| | 230V | 460V |
|-------------------|-------|-------|
| Full Load Amps | 3.13 | 1.5 |
| Locked Rotor Amps | 21.74 | 10.87 |
| No Load Current | 1.52 | 0.76 |
| Usable at 208V | 3 | |

BEARING INFORMATION

| | |
|-------------|----------|
| DE Bearing | 6203 2RS |
| ODE Bearing | 6203 2RS |

ADDITIONAL DATA

| | |
|--------------------|------------------------|
| F2 Suitable | No |
| Shaft Material | 1045 Carbon Steel |
| Connection Diagram | 230 / 460 V - 9 Lead Y |
| Approximate Weight | 22.9 lbs. |

MOTOR DRAWING

Premium Efficiency Motor: **NATE1-36-56CB**

WorldWide Electric Corporation

1 (800) 808-2131

Worldwideelectric.net

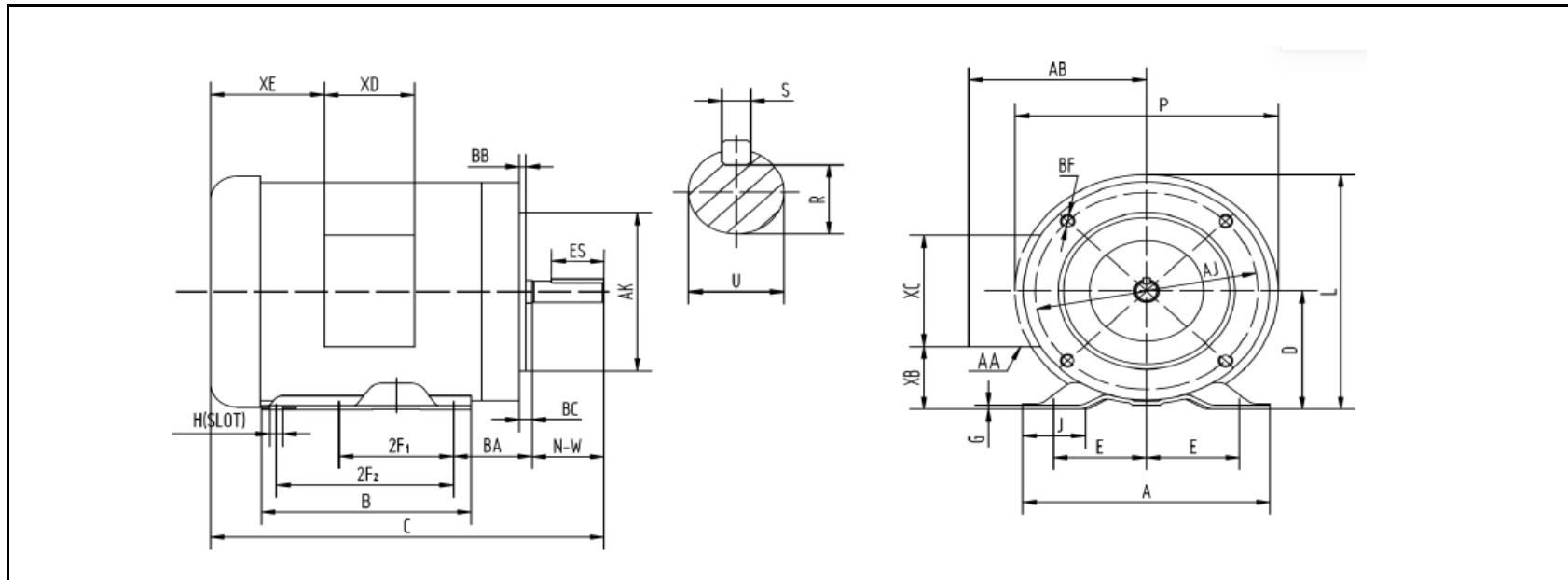

DIMENSION - INCHES

| MOUNTING | | | | | A | B | C | D | G | J | L | P | AB |
|----------|-----|-----|------|------|------|------|------|-----|------|------|-----|-----|-----|
| E | 2F1 | 2F2 | H | BA | | | | | | | | | |
| 2.44 | 3 | 5 | 0.34 | 2.75 | 6.54 | 6.54 | 11.9 | 3.5 | 0.12 | 1.65 | 7.4 | 7.3 | 5.2 |

| SHAFT & KEY | | | | |
|-------------|------|-------|------|-------|
| S | ES | R | N-W | U |
| 0.188 | 1.41 | 0.517 | 1.88 | 0.625 |

| TERMINAL BOX | | | | |
|----------------|------|-----|-----|------|
| AA | XB | XC | XD | XE |
| 3-0.88/2-1.109 | 1.65 | 3.7 | 3.2 | 2.15 |

| FLANGE | | | | |
|--------|-------|--------|------|-------|
| AK | AJ | BF | BB | BC |
| 4.5 | 5.875 | 3/8-16 | 0.16 | -0.19 |

PERFORMANCE CURVES

WorldWide Electric Corporation

1 (800) 808-2131

Worldwideelectric.net



Premium Efficiency Motor:

NATE1-36-56CB

Document Generated: 24-Feb-2023
 Document ID:

Customer:

| | | | | | | |
|-----------------------|--------|--------------------|------------|------|--------------|------|
| Motor Type | | | FL Speed | 3500 | | |
| Output Rating (HP) | 1 | | LRT (%FLT) | 260 | 460 volt FLA | 1.5 |
| Full Load Torque | 1.51 | lb.ft | BDT (%FLT) | 325 | 230 volt FLA | 3.13 |
| Rotor Wk ² | 0.0342 | lb-ft ² | | | | |

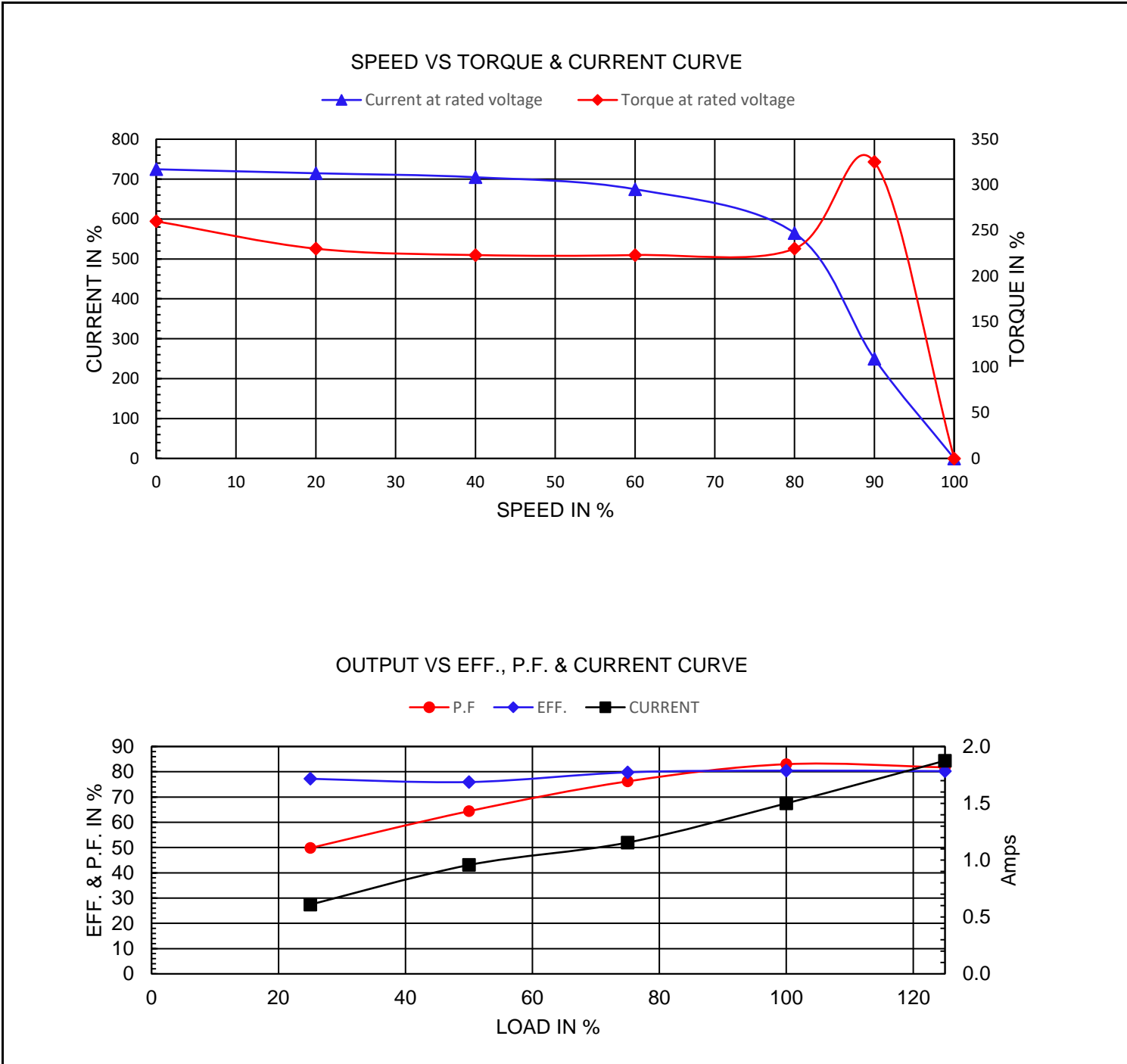

NAMEPLATE / WIRING

Premium Efficiency Motor: **NATE1-36-56CB**

WorldWide Electric Corporation

1 (800) 808-2131

Worldwideelectric.net



Document Generated: 24-Feb-2023
Document ID:

Customer:

SAMPLE NAMEPLATE DATA

| | | | | | | | |
|-----------------------|-------------------|--|-------|----------------|---------------------|---------------|--------|
| | | THREE PHASE INDUCTION MOTOR | | | | | CC315B |
| | | | | | | | |
| MODEL | FRAME | LOW VOLTAGE | | | HIGH VOLTAGE | | |
| Hz | ENCL. TEFC | BLUE (T1) — | LINE1 | BLUE (T1) — | LINE1 | MADE IN CHINA | |
| HP | PH 3 | BROWN (T7) — | LINE2 | WHITE (T2) — | LINE2 | | |
| RPM | DUTY CONT | WHITE (T2) — | LINE2 | ORANGE (T3) — | LINE3 | | |
| VOLTS | CODE | RED (T8) — | LINE3 | YELLOW (T4) — | INS | | |
| AMPS | INS. F | ORANGE (T3) — | INS | BROWN (T7) — | INS | | |
| | DES. | YEL/BLA (T9) — | INS | BLACK (T5) — | INS | | |
| S. F. | LB/WT | YELLOW (T4) — | INS | RED (T8) — | INS | | |
| | | BLACK (T5) — | INS | GRAY (T6) — | INS | | |
| | | GRAY (T6) — | INS | YEL/BLA (T9) — | INS | | |
| NOM. EFF (60Hz) | DE/ODE BRG. | ACCEPTABLE FOR FIELD WIRING | | | | | |
| MAX. AMB. 40°C | Date Code XX/XXXX | THERMALLY PROTECTED : NONE | | | | | |
| SERIAL NO. XXXXXXXXXX | | WorldWide Electric Corporation | | | | | |

| | | | |
|-----------------|---------------|--------------|--------------------------|
| Model | NATE1-36-56CB | Frame | 56HC |
| Hz | 60 Hz | 50Hz | Encl TEFC |
| HP | 1 | 3/4 | PH 3 |
| RPM | 3500 | 2915 | DUTY CONT |
| Voltage | 230/460 | 190/380 | Code H |
| Amps | 3.13/1.50 | 2.76/1.38 | Ins Cl F |
| IP | IP43 | | Design B |
| S.F. | 1.15 | 1.15 | LB/WT 22.9 lbs. |
| Nom.Eff. | 80.5% | | DE Brng 6203 2RS |
| | | | ODE Brng 6203 2RS |