

# DATA SHEET

Premium Efficiency Motor: **NATE2-18-56CB**

**60 Hz**

WorldWide Electric Corporation

1 (800) 808-2131

Worldwideelectric.net



Document Generated: 24-Feb-2023

Document ID:

Customer:

## MOTOR INFORMATION

HP	2
RPM	1800
Phase	3
Frequency	60 Hz
Voltage	230/460
Frame Size	56HC
Enclosure	TEFC
Degree of Protection	IP43
Service Factor	1.15
Poles	4
Full Load Speed	1760
Insulation Class	F
Temp Rise	80°C
NEMA Code Letter	J
Duty Cycle	S1 / Continuous
Slip	0.02%
NEMA Design	B
Moment of Inertia	0.1579 lb.ft.^2
Sound Pressure Level	68 dB(A)
Max Ambient Temperature	40°C
Max Elevation	1000 m.a.s.l (3300 f.a.s.l)
Mounting	F1
Base	C-Face Removable Base
Rotation	Bi-Directional
Standard	NEMA MG-1
Approvals	CSA, CE

## EFFICIENCY/POWER FACTOR

LOAD	EFF	P. F.
100%	86.8 %	73.8
75%	87.0 %	64.8
50%	85.1 %	51.3

## TORQUE

FULL LOAD	LRT	BDT
6.01 lb.ft.	450 %	455 %

## AMPERAGE INFORMATION

	230V	460V
Full Load Amps	6.15	2.96
Locked Rotor Amps	60.78	30.39
No Load Current	3.62	1.81
Usable at 208V	6	

## BEARING INFORMATION

DE Bearing	6203 2RS
ODE Bearing	6203 2RS

## ADDITIONAL DATA

F2 Suitable	No
Shaft Material	1045 Carbon Steel
Connection Diagram	230 / 460 V - 9 Lead Y
Approximate Weight	48.8 lbs.

# MOTOR DRAWING

Premium Efficiency Motor: **NATE2-18-56CB**

WorldWide Electric Corporation

1 (800) 808-2131

Worldwideelectric.net

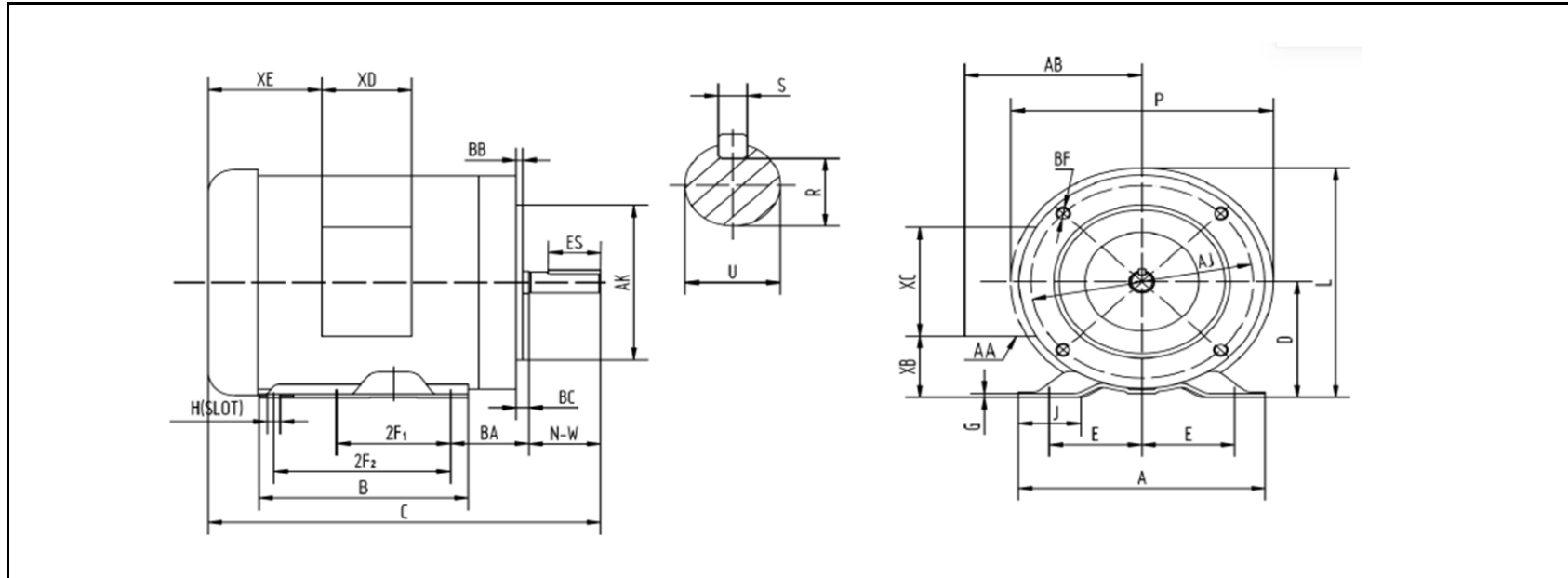

## DIMENSION - INCHES

MOUNTING					A	B	C	D	G	J	L	P	AB
E	2F1	2F2	H	BA									
2.44	3	5	0.34	2.75	6.54	6.54	13.9	3.5	0.12	1.65	7.4	7.3	5.2

SHAFT & KEY				
S	ES	R	N-W	U
0.188	1.41	0.517	1.88	0.625

TERMINAL BOX				
AA	XB	XC	XD	XE
3-0.88/2-1.109	1.65	3.7	3.2	2.15

FLANGE				
AK	AJ	BF	BB	BC
4.5	5.875	3/8-16	0.16	-0.19

# PERFORMANCE CURVES

WorldWide Electric Corporation

1 (800) 808-2131

Worldwideelectric.net



Premium Efficiency Motor:

**NATE2-18-56CB**

Document Generated: 24-Feb-2023  
 Document ID:

Customer:

Motor Type					
Output Rating (HP)	2		FL Speed	1760	
Full Load Torque	6.01 lb.ft		LRT (%FLT)	450	460 volt FLA 2.96
Rotor Wk <sup>2</sup>	0.1579 lb-ft <sup>2</sup>		BDT (%FLT)	455	230 volt FLA 6.15

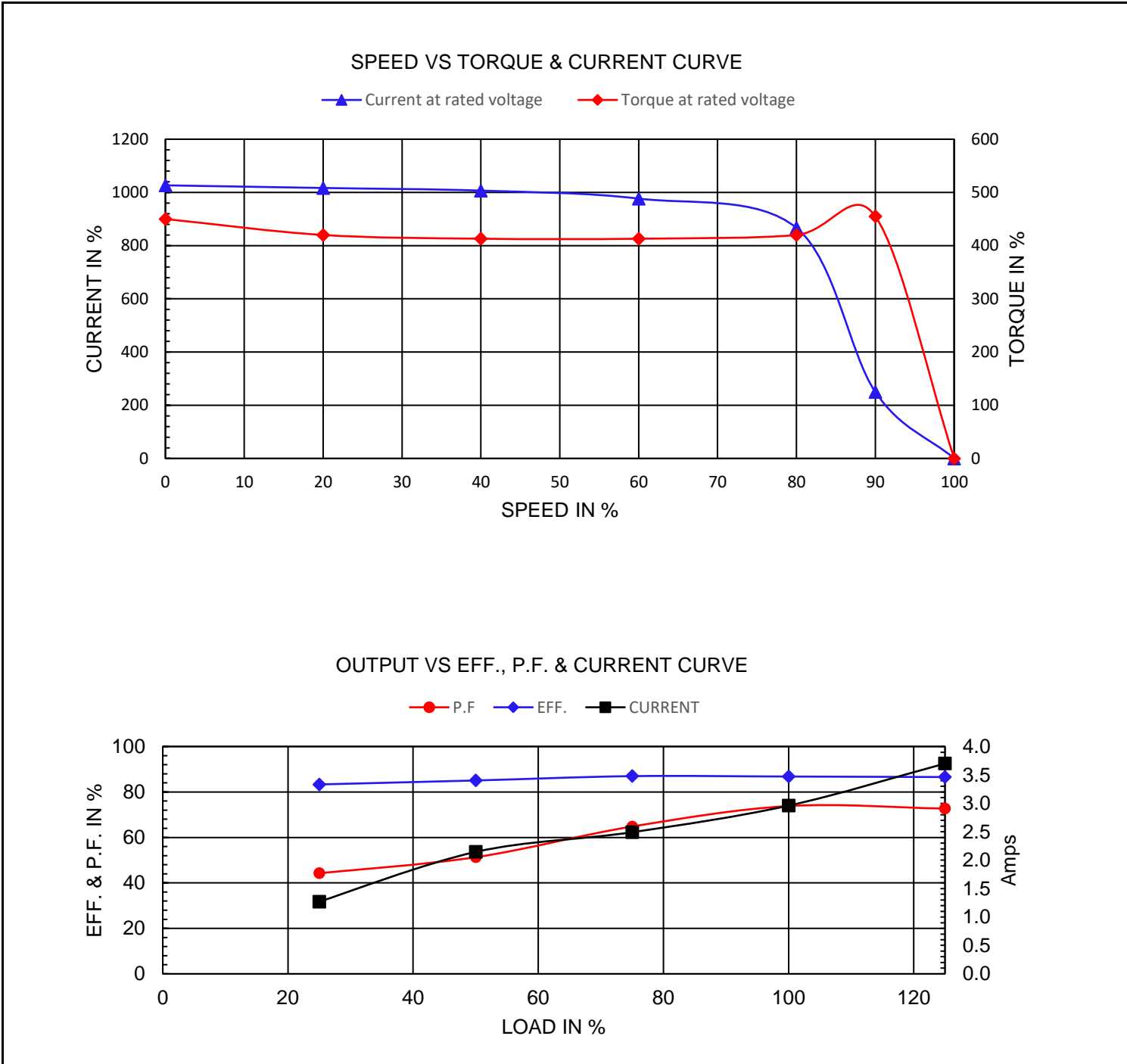

# NAMEPLATE / WIRING

WorldWide Electric Corporation

1 (800) 808-2131

Worldwideelectric.net



Premium Efficiency Motor: **NATE2-18-56CB**

Document Generated: 24-Feb-2023  
Document ID:

Customer:

## SAMPLE NAMEPLATE DATA

		<b>THREE PHASE INDUCTION MOTOR</b>					256950	CC315B
<b>MODEL</b>	<b>FRAME</b>	<b>LOW VOLTAGE</b>			<b>HIGH VOLTAGE</b>			
Hz	ENCL. TEFC	BLUE (T1) —	LINE1	BLUE (T1) —	LINE1	MADE IN CHINA		
HP	PH 3	BROWN (T7) —	LINE1	WHITE (T2) —	LINE2			
RPM	DUTY CONT	WHITE (T2) —	LINE2	ORANGE (T3) —	LINE3			
VOLTS	CODE	RED (T8) —	LINE2	YELLOW (T4) —	INS			
AMPS	INS. F	ORANGE (T3) —	LINE3	BROWN (T7) —	INS			
	DES.	YEL/BLA (T9) —	LINE3	BLACK (T5) —	INS			
S. F.	LB/WT	YELLOW (T4) —	INS	RED (T8) —	INS			
		BLACK (T5) —	INS	GRAY (T6) —	INS			
		GRAY (T6) —	INS	YEL/BLA (T9) —	INS			
NOM. EFF (60Hz)	DE/ODE BRG.	ACCEPTABLE FOR FIELD WIRING						
MAX. AMB. 40°C	Date Code XX/XXXX	THERMALLY PROTECTED : NONE						
SERIAL NO. XXXXXXXXXX		WorldWide Electric Corporation						

<b>Model</b>	NATE2-18-56CB	<b>Frame</b>	56HC
<b>Hz</b>	60 Hz	50Hz	<b>Encl</b> TEFC
<b>HP</b>	2	1.5	<b>PH</b> 3
<b>RPM</b>	1760	1465	<b>DUTY</b> CONT
<b>Voltage</b>	230/460	190/380	<b>Code</b> J
<b>Amps</b>	6.15/2.96	5.56/2.78	<b>Ins Cl</b> F
<b>IP</b>	IP43		<b>Design</b> B
<b>S.F.</b>	1.15	1.15	<b>LB/WT</b> 48.8 lbs.
<b>Nom.Eff.</b>	86.8%		<b>DE Brng</b> 6203 2RS
			<b>ODE Brng</b> 6203 2RS