

DATA SHEET

Premium Efficiency Motor: **NATJ12-36-56JB**

60 Hz

WorldWide Electric Corporation

1 (800) 808-2131

Worldwideelectric.net



Document Generated: 28-Feb-2023

Document ID:

Customer:

MOTOR INFORMATION

HP	1/2
RPM	3600
Phase	3
Frequency	60 Hz
Voltage	230/460
Frame Size	56J
Enclosure	TEFC
Degree of Protection	IP43
Service Factor	1.15
Poles	2
Full Load Speed	3450
Insulation Class	F
Temp Rise	80°C
NEMA Code Letter	P
Duty Cycle	S1 / Continuous
Slip	0.04%
NEMA Design	B
Moment of Inertia	0.0245 lb.ft.^2
Sound Pressure Level	78 dB(A)
Max Ambient Temperature	40°C
Max Elevation	1000 m.a.s.l (3300 f.a.s.l)
Mounting	F1
Base	C-Face Removable Base
Rotation	Clockwise
Standard	NEMA MG-1
Approvals	CSA, CE

EFFICIENCY/POWER FACTOR

LOAD	EFF	P. F.
100%	63.1 %	86.7
75%	61.7 %	81.6
50%	55.7 %	72.7

TORQUE

FULL LOAD	LRT	BDT
0.76 lb.ft.	150 %	255 %

AMPERAGE INFORMATION

	230V	460V
Full Load Amps	1.7	0.85
Locked Rotor Amps	7.7	3.85
No Load Current	0.86	0.43
Usable at 208V	--	

BEARING INFORMATION

DE Bearing	6203 2RS
ODE Bearing	6203 2RS

ADDITIONAL DATA

F2 Suitable	No
Shaft Material	AISI 420 Stainless
Connection Diagram	230 / 460 V - 9 Lead Y
Approximate Weight	19 lbs.

MOTOR DRAWING

Premium Efficiency Motor: **NATJ12-36-56JB**

WorldWide Electric Corporation

1 (800) 808-2131

Worldwideelectric.net

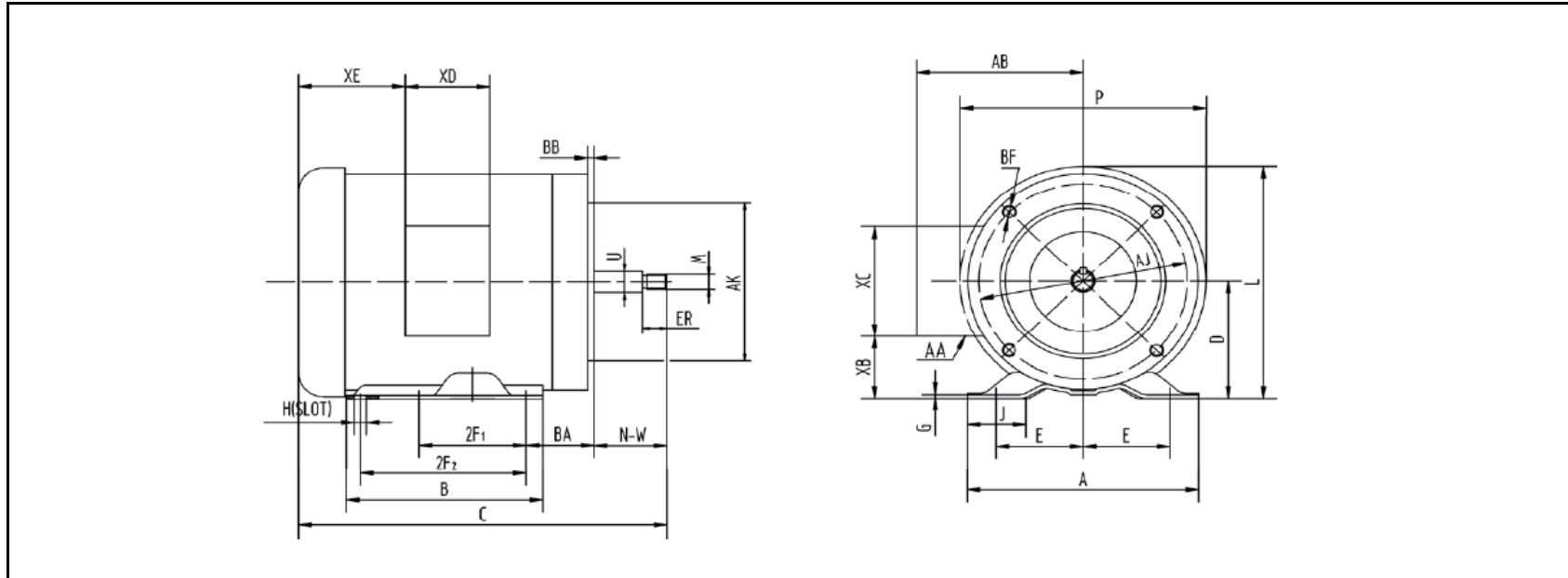

DIMENSION - INCHES

MOUNTING					A	B	C	D	G	J	L	P	AB
E	2F1	2F2	H	BA									
2.44	3	5	0.34	2.75	6.54	6.54	12.4	3.5	0.12	1.65	7.4	7.3	5.2

SHAFT & KEY			
ES	R	N-W	U
0.68	7/16-20	2.44	0.625

TERMINAL BOX				
AA	XB	XC	XD	XE
1/2 & 3/4	1.65	3.7	3.2	2.15

FLANGE				
AK	AJ	BF	BB	BC
4.5	5.875	3/8-16	0.16	-0.19

PERFORMANCE CURVES

WorldWide Electric Corporation

1 (800) 808-2131

Worldwideelectric.net



Premium Efficiency Motor:

NATJ12-36-56JB

Document Generated: 28-Feb-2023
 Document ID:

Customer:

Motor Type					
Output Rating (HP)	1/2		FL Speed	3450	
Full Load Torque	0.76 lb.ft		LRT (%FLT)	150	460 volt FLA 0.85
Rotor Wk ²	0.0245 lb-ft ²		BDT (%FLT)	255	230 volt FLA 1.7

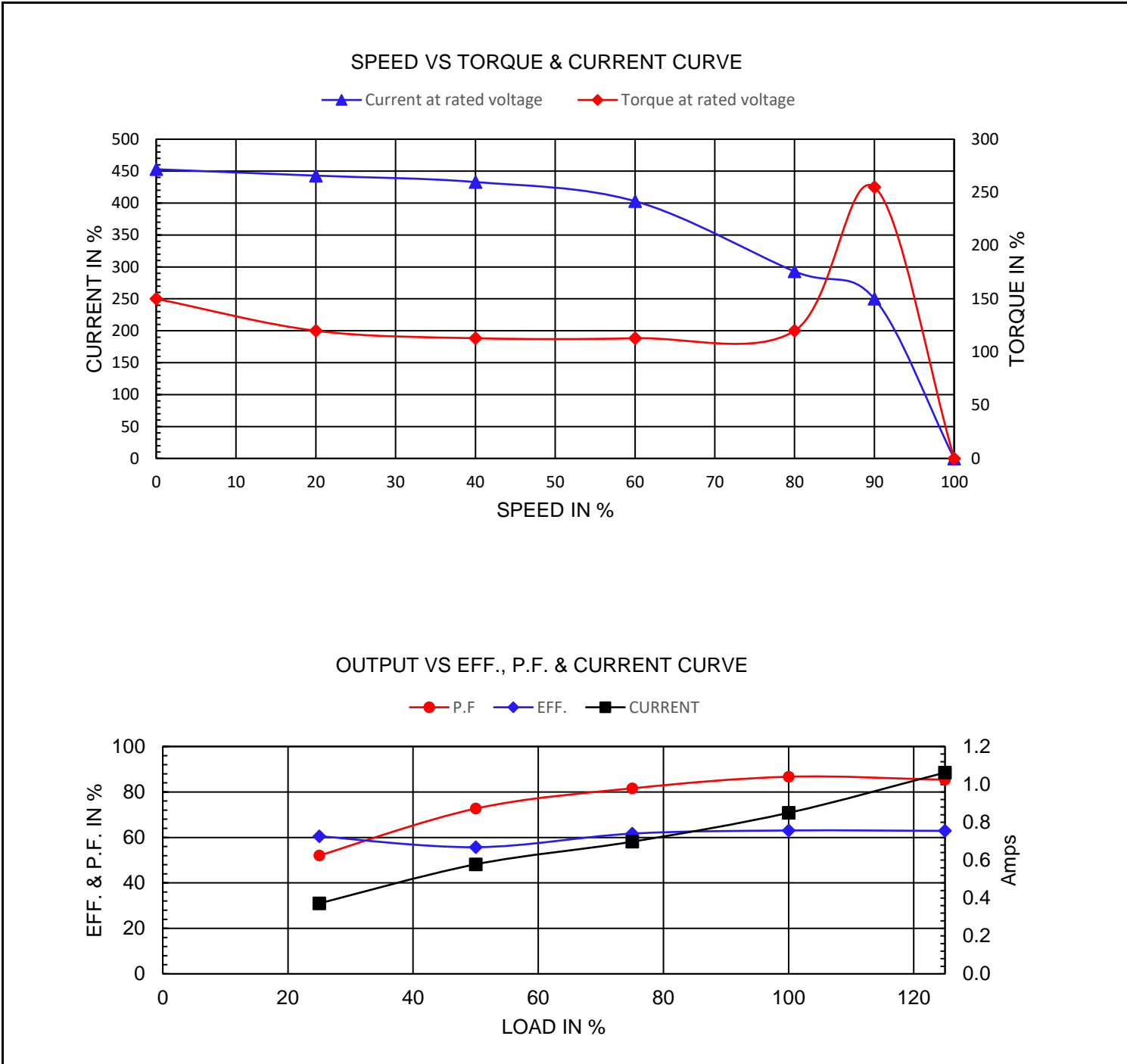

NAMEPLATE / WIRING

Premium Efficiency Motor: **NATJ12-36-56JB**

WorldWide Electric Corporation

1 (800) 808-2131



Worldwideelectric.net



Document Generated: 28-Feb-2023
Document ID:

Customer:

SAMPLE NAMEPLATE DATA

		INDUSTRIAL DUTY FRACTIONAL MOTOR																																																											
MODEL	FRAME	<table border="0"> <tr> <th colspan="2">LOW VOLTAGE</th> <th colspan="2">HIGH VOLTAGE</th> </tr> <tr> <td>BLUE (T1)</td> <td rowspan="2">] LINE2</td> <td>BLUE (T1)</td> <td>LINE2</td> </tr> <tr> <td>BROWN (T7)</td> <td>WHITE (T2)</td> <td>LINE1</td> </tr> <tr> <td>WHITE (T2)</td> <td rowspan="2">] LINE1</td> <td>ORANGE (T3)</td> <td>LINE3</td> </tr> <tr> <td>RED (T8)</td> <td>YELLOW (T4)</td> <td>INS</td> </tr> <tr> <td>ORANGE (T3)</td> <td rowspan="2">] LINE3</td> <td>BROWN (T7)</td> <td>INS</td> </tr> <tr> <td>YEL/BLA (T9)</td> <td>BLACK (T5)</td> <td>INS</td> </tr> <tr> <td>Hz</td> <td>ENCL.</td> <td>YELLOW (T4)</td> <td>INS</td> </tr> <tr> <td>HP</td> <td>PH</td> <td>BLACK (T5)</td> <td>INS</td> </tr> <tr> <td>RPM</td> <td>DUTY</td> <td>RED (T8)</td> <td>INS</td> </tr> <tr> <td>VOLTS</td> <td>CODE</td> <td>GRAY (T6)</td> <td>INS</td> </tr> <tr> <td>AMPS</td> <td>INS.</td> <td>YEL/BLA (T9)</td> <td>INS</td> </tr> <tr> <td>S. F.</td> <td>DES.</td> <td colspan="2" rowspan="2" style="text-align: center;"> ACCEPTABLE FOR FIELD WIRING THERMALLY PROTECTED : NONE </td> </tr> <tr> <td>SFA.</td> <td>LB/WT</td> </tr> <tr> <td>MAX. AMB.</td> <td>DE/ODE BRG.</td> <td colspan="2" rowspan="2" style="text-align: center;"> WorldWide Electric Corporation </td> </tr> <tr> <td colspan="2"> SERIAL NO. XXXXXXXXXX Date Code XX/XXXX </td> </tr> </table>		LOW VOLTAGE		HIGH VOLTAGE		BLUE (T1)] LINE2	BLUE (T1)	LINE2	BROWN (T7)	WHITE (T2)	LINE1	WHITE (T2)] LINE1	ORANGE (T3)	LINE3	RED (T8)	YELLOW (T4)	INS	ORANGE (T3)] LINE3	BROWN (T7)	INS	YEL/BLA (T9)	BLACK (T5)	INS	Hz	ENCL.	YELLOW (T4)	INS	HP	PH	BLACK (T5)	INS	RPM	DUTY	RED (T8)	INS	VOLTS	CODE	GRAY (T6)	INS	AMPS	INS.	YEL/BLA (T9)	INS	S. F.	DES.	ACCEPTABLE FOR FIELD WIRING THERMALLY PROTECTED : NONE		SFA.	LB/WT	MAX. AMB.	DE/ODE BRG.	WorldWide Electric Corporation		SERIAL NO. XXXXXXXXXX Date Code XX/XXXX		MADE IN CHINA
LOW VOLTAGE				HIGH VOLTAGE																																																									
BLUE (T1)] LINE2			BLUE (T1)	LINE2																																																								
BROWN (T7)				WHITE (T2)	LINE1																																																								
WHITE (T2)] LINE1			ORANGE (T3)	LINE3																																																								
RED (T8)				YELLOW (T4)	INS																																																								
ORANGE (T3)] LINE3			BROWN (T7)	INS																																																								
YEL/BLA (T9)				BLACK (T5)	INS																																																								
Hz	ENCL.			YELLOW (T4)	INS																																																								
HP	PH			BLACK (T5)	INS																																																								
RPM	DUTY	RED (T8)	INS																																																										
VOLTS	CODE	GRAY (T6)	INS																																																										
AMPS	INS.	YEL/BLA (T9)	INS																																																										
S. F.	DES.	ACCEPTABLE FOR FIELD WIRING THERMALLY PROTECTED : NONE																																																											
SFA.	LB/WT																																																												
MAX. AMB.	DE/ODE BRG.	WorldWide Electric Corporation																																																											
SERIAL NO. XXXXXXXXXX Date Code XX/XXXX																																																													

Model	NATJ12-36-56JB	Frame	56J
Hz	60 Hz 50Hz	Encl	TEFC
HP	1/2 1/3	PH	3
RPM	3450 2850	DUTY	CONT
Voltage	230/460 190/380	Code	P
Amps	1.7/0.85 1.50/0.75	Ins Cl	F
S.F.	1.15 1.15	Design	B
SFA.	2.0/1.0 1.6/0.80	LB/WT	19 lbs.
Nom.Eff.	63.1%	DE Brng	6203 2RS
IP	IP43	ODE Brng	6203 2RS
MAX. AMB	40°C		