

DATA SHEET

Premium Efficiency Motor: **NATJE2-36-56CB**

60 Hz

WorldWide Electric Corporation

1 (800) 808-2131

Worldwideelectric.net



Document Generated: 28-Feb-2023

Document ID:

Customer:

MOTOR INFORMATION

HP	2
RPM	3600
Phase	3
Frequency	60 Hz
Voltage	230/460
Frame Size	56C
Enclosure	TEFC
Degree of Protection	IP43
Service Factor	1.15
Poles	4
Full Load Speed	3500
Insulation Class	F
Temp Rise	80°C
NEMA Code Letter	H
Duty Cycle	S1 / Continuous
Slip	0.03%
NEMA Design	B
Moment of Inertia	0.0561 lb.ft.^2
Sound Pressure Level	73 dB(A)
Max Ambient Temperature	40°C
Max Elevation	1000 m.a.s.l (3300 f.a.s.l)
Mounting	F1
Base	C-Face Removable Base
Rotation	Clockwise
Standard	NEMA MG-1
Approvals	CSA, CE

EFFICIENCY/POWER FACTOR

LOAD	EFF	P. F.
100%	87.2 %	85.8
75%	87.5 %	80.3
50%	85.7 %	69.2

TORQUE

FULL LOAD	LRT	BDT
3.02 lb.ft.	385 %	415 %

AMPERAGE INFORMATION

	230V	460V
Full Load Amps	5.22	2.61
Locked Rotor Amps	54.76	27.38
No Load Current	2.24	1.12
Usable at 208V	6	

BEARING INFORMATION

DE Bearing	6203 2RS
ODE Bearing	6203 2RS

ADDITIONAL DATA

F2 Suitable	No
Shaft Material	1045 Carbon Steel
Connection Diagram	230 / 460 V - 9 Lead Y
Approximate Weight	33.4 lbs.

MOTOR DRAWING

Premium Efficiency Motor: **NATJE2-36-56CB**

WorldWide Electric Corporation

1 (800) 808-2131

Worldwideelectric.net

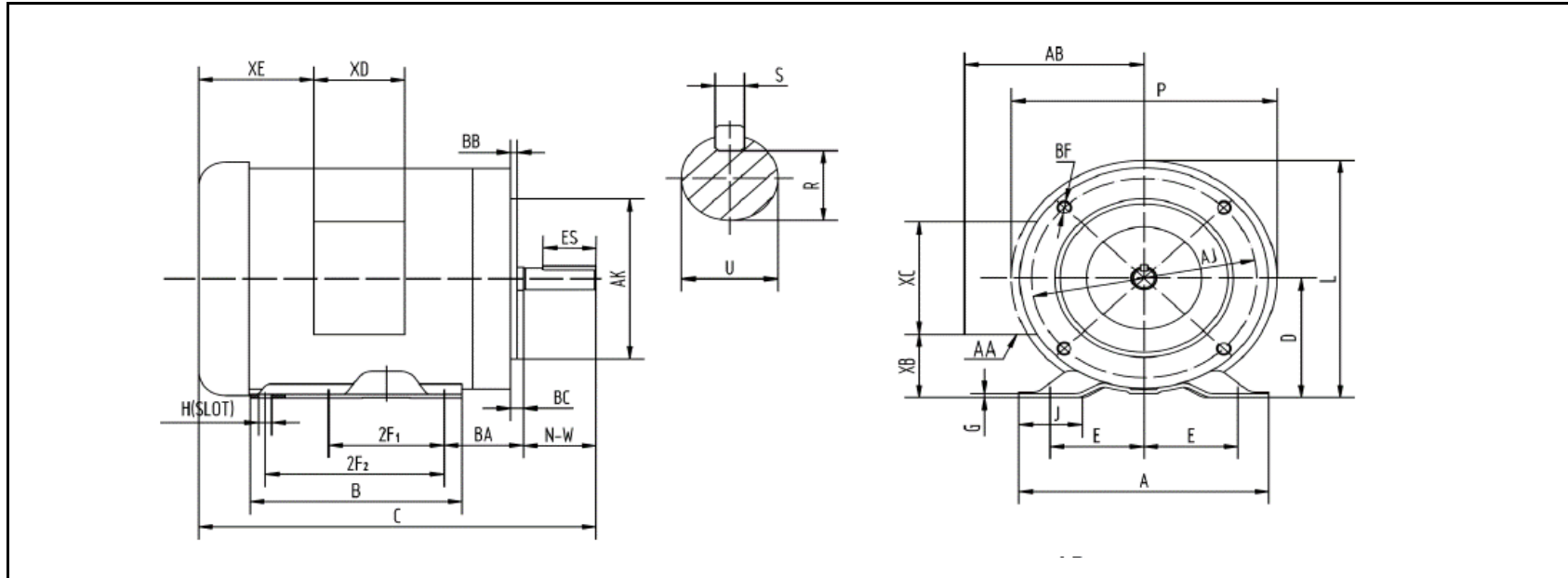

DIMENSION - INCHES

MOUNTING					A	B	C	D	G	J	L	P	AB
E	2F1	2F2	H	BA									
2.44	3	5	0.34	2.75	6.54	6.54	11.9	3.5	0.12	1.65	7.4	7.3	5.2

SHAFT & KEY				
S	ES	R	N-W	U
0.188	1.41	0.517	1.88	0.625

TERMINAL BOX				
AA	XB	XC	XD	XE
1/2 & 3/4	1.65	3.7	3.2	2.15

FLANGE				
AK	AJ	BF	BB	BC
4.5	5.875	3/8-16	0.16	-0.19

PERFORMANCE CURVES

WorldWide Electric Corporation

1 (800) 808-2131

Worldwideelectric.net



Premium Efficiency Motor:

NATJE2-36-56CB

Document Generated: 28-Feb-2023
Document ID:

Customer:

Motor Type			FL Speed	3500		
Output Rating (HP)	2		LRT (%FLT)	385	460 volt FLA	2.61
Full Load Torque	3.02	lb.ft	BDT (%FLT)	415	230 volt FLA	5.22
Rotor Wk^2	0.0561	lb-ft^2				

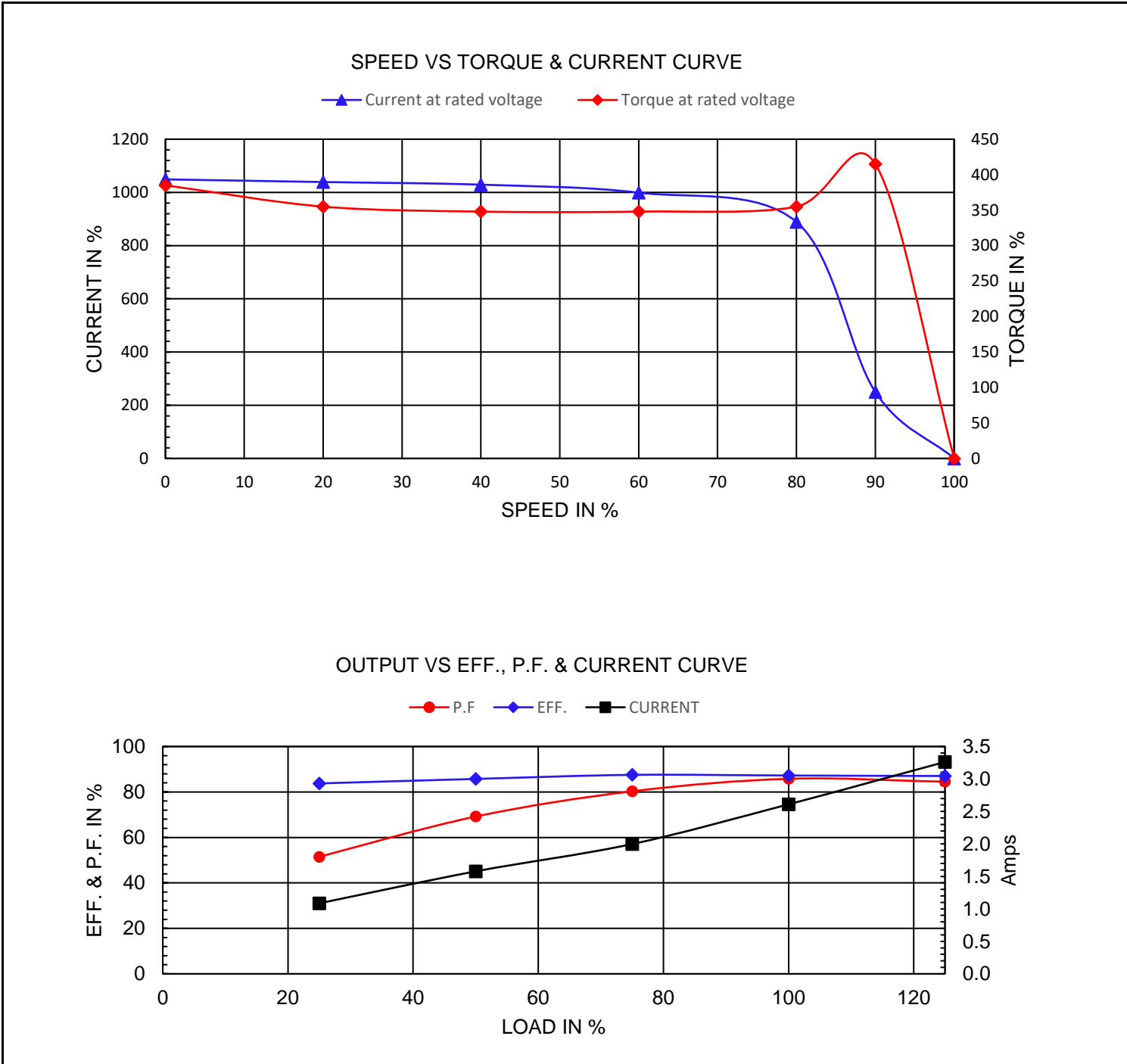

NAMEPLATE / WIRING

Premium Efficiency Motor: **NATJE2-36-56CB**

WorldWide Electric Corporation

1 (800) 808-2131

Worldwideelectric.net



Document Generated: 28-Feb-2023
Document ID:

Customer:

SAMPLE NAMEPLATE DATA

		INDUSTRIAL DUTY FRACTIONAL MOTOR					GC315B
MODEL	FRAME			LOW VOLTAGE		HIGH VOLTAGE	
Hz	ENCL.			BLUE (T1) — LINE2	BLUE (T1) — LINE2	MADE IN CHINA	
HP	PH			BROWN (T7) — LINE2	WHITE (T2) — LINE1		
RPM	DUTY			WHITE (T2) — LINE1	ORANGE (T3) — LINE3		
VOLTS	CODE			RED (T8) — LINE1	YELLOW (T4) — INS		
AMPS	INS.			ORANGE (T3) — LINE3	BROWN (T7) — INS		
S. F.	DES.			YEL/BLA (T9) — LINE3	BLACK (T5) — INS		
NOM. EFF	% (60Hz)	DE/ODE BRG.		YELLOW (T4) — INS	RED (T8) — INS		
MAX. AMB.		LB/WT		BLACK (T5) — INS	GRAY (T6) — INS		
Date Code XX/XXXX				GRAY (T6) — INS	YEL/BLA (T9) — INS		
SERIAL NO. XXXXXXXXXX		WorldWide Electric Corporation					

ACCEPTABLE FOR FIELD WIRING
THERMALLY PROTECTED : NONE

Model	NATJE2-36-56CB	Frame	56C
Hz	60 Hz	50Hz	Encl TEFC
HP	2	1.5	PH 3
RPM	3500	2915	DUTY CONT
Voltage	230/460	190/380	Code H
Amps	5.22/2.61	4.78/2.39	Ins Cl F
S.F.	1.15	1.15	Design B
SFA.	--	0	LB/WT 33.4 lbs.
Nom.Eff.	87.2%		DE Brng 6203 2RS
IP	IP43		ODE Brng 6203 2RS
MAX. AMB	40°C		