

# DATA SHEET

Premium Efficiency Motor: **NATJE2-36-56JB**

**60 Hz**

WorldWide Electric Corporation

1 (800) 808-2131

Worldwideelectric.net



Document Generated: 28-Feb-2023

Document ID:

Customer:

## MOTOR INFORMATION

HP	2
RPM	3600
Phase	3
Frequency	60 Hz
Voltage	230/460
Frame Size	56J
Enclosure	TEFC
Degree of Protection	IP43
Service Factor	1.15
Poles	4
Full Load Speed	3500
Insulation Class	F
Temp Rise	80°C
NEMA Code Letter	H
Duty Cycle	S1 / Continuous
Slip	0.03%
NEMA Design	B
Moment of Inertia	0.0561 lb.ft.^2
Sound Pressure Level	73 dB(A)
Max Ambient Temperature	40°C
Max Elevation	1000 m.a.s.l (3300 f.a.s.l)
Mounting	F1
Base	C-Face Removable Base
Rotation	Clockwise
Standard	NEMA MG-1
Approvals	CSA, CE

## EFFICIENCY/POWER FACTOR

LOAD	EFF	P. F.
100%	87.2 %	85.8
75%	87.5 %	80.3
50%	85.7 %	69.2

## TORQUE

FULL LOAD	LRT	BDT
3.02 lb.ft.	385 %	415 %

## AMPERAGE INFORMATION

	230V	460V
Full Load Amps	5.22	2.61
Locked Rotor Amps	54.76	27.38
No Load Current	2.24	1.12
Usable at 208V	6	

## BEARING INFORMATION

DE Bearing	6203 2RS
ODE Bearing	6203 2RS

## ADDITIONAL DATA

F2 Suitable	No
Shaft Material	AISI 420 Stainless
Connection Diagram	230 / 460 V - 9 Lead Y
Approximate Weight	33.4 lbs.

# MOTOR DRAWING

Premium Efficiency Motor: **NATJE2-36-56JB**

WorldWide Electric Corporation

1 (800) 808-2131

Worldwideelectric.net

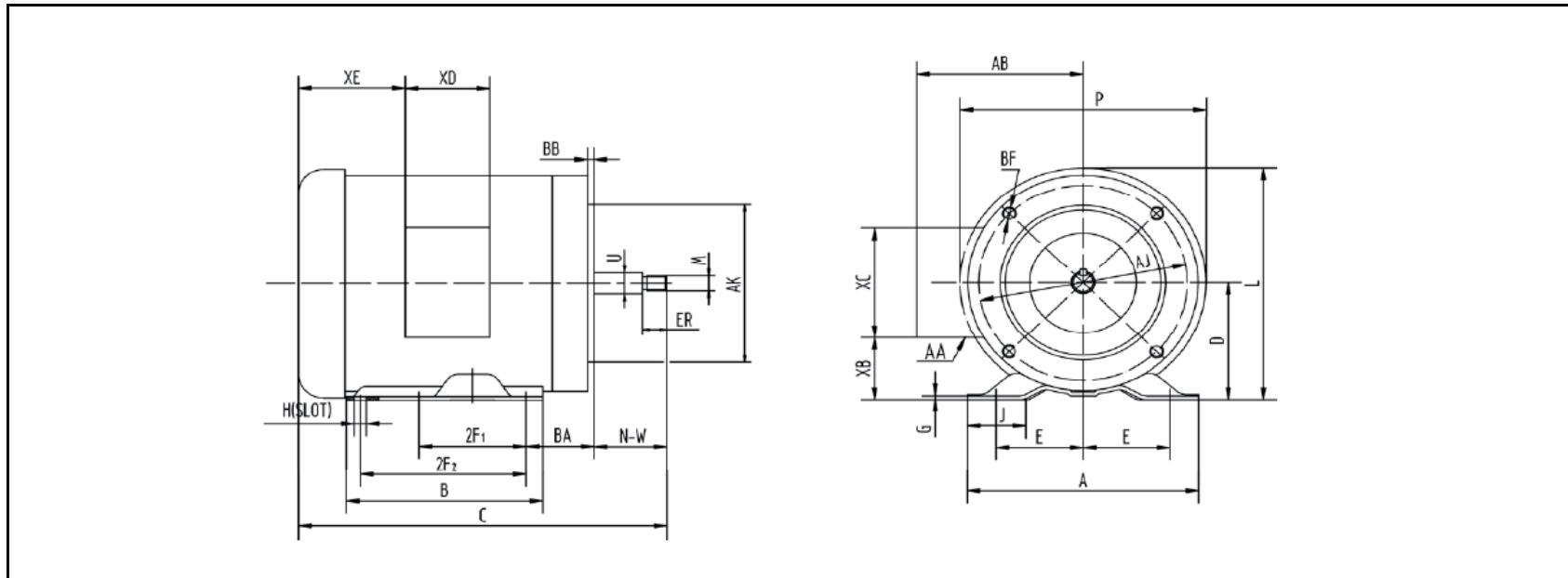

## DIMENSION - INCHES

MOUNTING					A	B	C	D	G	J	L	P	AB
E	2F1	2F2	H	BA									
2.44	3	5	0.34	2.75	6.54	6.54	12.4	3.5	0.12	1.65	7.4	7.3	5.2

SHAFT & KEY			
ES	R	N-W	U
0.68	7/16-20	2.44	0.625

TERMINAL BOX				
AA	XB	XC	XD	XE
1/2 & 3/4	1.65	3.7	3.2	2.15

FLANGE				
AK	AJ	BF	BB	BC
4.5	5.875	3/8-16	0.16	-0.19

# PERFORMANCE CURVES

WorldWide Electric Corporation

1 (800) 808-2131

Worldwideelectric.net



Premium Efficiency Motor:

**NATJE2-36-56JB**

Document Generated: 28-Feb-2023  
Document ID:

Customer:

Motor Type					
Output Rating (HP)	2		FL Speed	3500	
Full Load Torque	3.02 lb.ft		LRT (%FLT)	385	460 volt FLA 2.61
Rotor Wk <sup>2</sup>	0.0561 lb-ft <sup>2</sup>		BDT (%FLT)	415	230 volt FLA 5.22

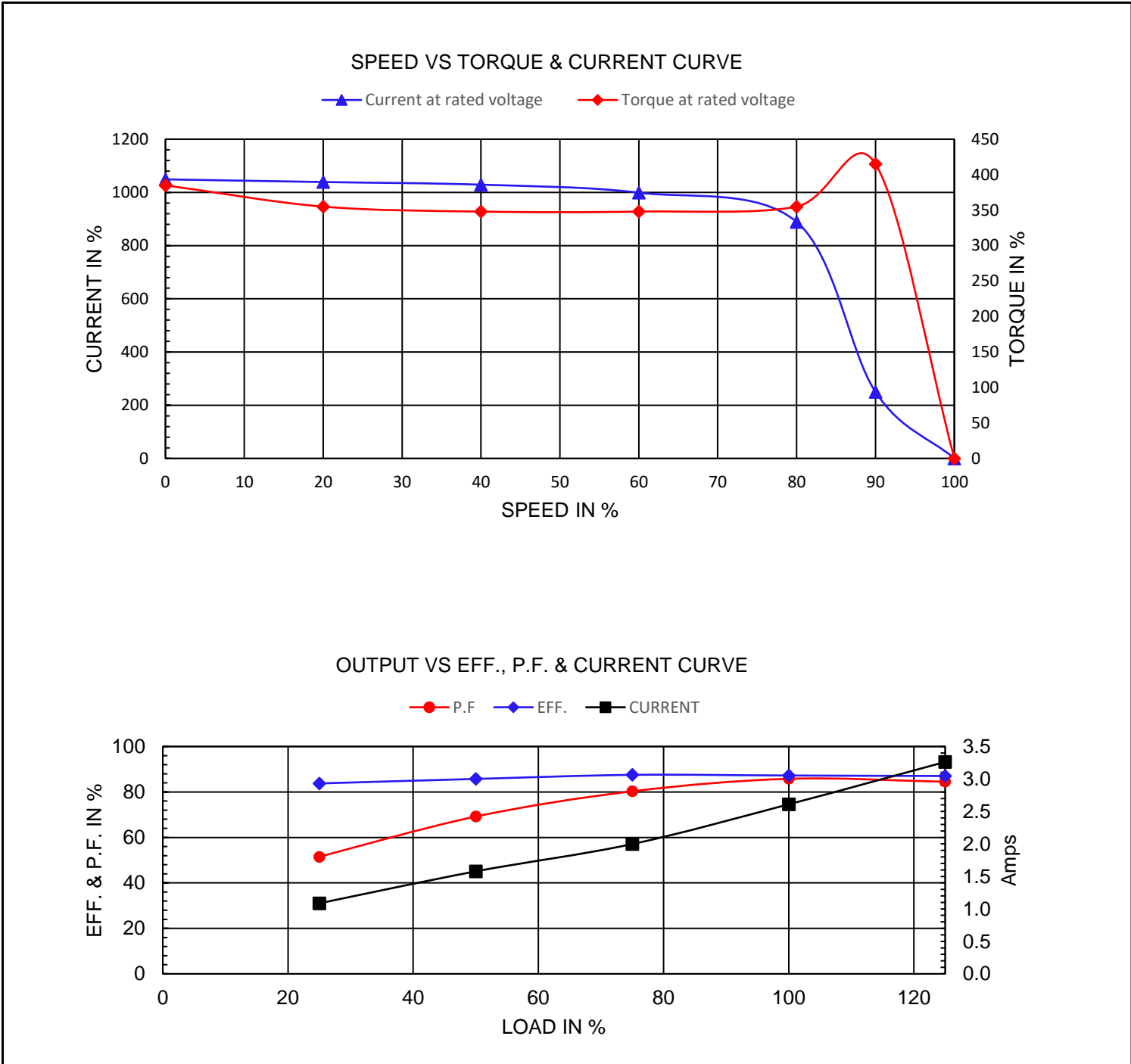

# NAMEPLATE / WIRING

Premium Efficiency Motor: **NATJE2-36-56JB**

WorldWide Electric Corporation

1 (800) 808-2131





Worldwideelectric.net



Document Generated: 28-Feb-2023  
Document ID:

Customer:

## SAMPLE NAMEPLATE DATA

		<b>INDUSTRIAL DUTY FRACTIONAL MOTOR</b>					<b>GC315B</b>
<b>MODEL</b>	<b>FRAME</b>			<b>LOW VOLTAGE</b>		<b>HIGH VOLTAGE</b>	
<b>Hz</b>	<b>ENCL.</b>			BLUE (T1) — LINE2	BLUE (T1) — LINE2	<b>MADE IN CHINA</b>	
<b>HP</b>	<b>PH</b>			BROWN (T7) — LINE2	WHITE (T2) — LINE1		
<b>RPM</b>	<b>DUTY</b>			WHITE (T2) — LINE1	ORANGE (T3) — LINE3		
<b>VOLTS</b>	<b>CODE</b>			RED (T8) — LINE1	YELLOW (T4) — INS		
<b>AMPS</b>	<b>INS.</b>			ORANGE (T3) — LINE3	BROWN (T7) — INS		
<b>S. F.</b>	<b>DES.</b>			YEL/BLA (T9) — LINE3	BLACK (T5) — INS		
<b>NOM. EFF</b>	<b>% (60Hz)</b>	<b>DE/ODE BRG.</b>		YELLOW (T4) — INS	RED (T8) — INS		
<b>MAX. AMB.</b>		<b>LB/WT</b>		BLACK (T5) — INS	GRAY (T6) — INS		
<b>Date Code</b> XX/XXXX				GRAY (T6) — INS	YEL/BLA (T9) — INS		
<b>SERIAL NO.</b> XXXXXXXXXX		<b>WorldWide Electric Corporation</b>					

ACCEPTABLE FOR FIELD WIRING  
THERMALLY PROTECTED : NONE

<b>Model</b>	NATJE2-36-56JB		<b>Frame</b>	56J
<b>Hz</b>	60 Hz	50Hz	<b>Encl</b>	TEFC
<b>HP</b>	2	1.5	<b>PH</b>	3
<b>RPM</b>	3500	2915	<b>DUTY</b>	CONT
<b>Voltage</b>	230/460	190/380	<b>Code</b>	H
<b>Amps</b>	5.22/2.61	4.78/2.39	<b>Ins Cl</b>	F
<b>S.F.</b>	1.15	1.15	<b>Design</b>	B
<b>SFA.</b>	--	0	<b>LB/WT</b>	33.4 lbs.
<b>Nom.Eff.</b>	87.2%		<b>DE Brng</b>	6203 2RS
<b>IP</b>	IP43		<b>ODE Brng</b>	6203 2RS
<b>MAX. AMB</b>	40°C			