

DATA SHEET

Premium Efficiency Motor: **NT12-18-56CB**

60 Hz

WorldWide Electric Corporation

1 (800) 808-2131

Worldwideelectric.net



Document Generated: 22-Feb-2023

Document ID:

Customer:

MOTOR INFORMATION

| | |
|-------------------------|-----------------------------|
| HP | 1/2 |
| RPM | 1800 |
| Phase | 1 |
| Frequency | 60 Hz |
| Voltage | 115/230 |
| Frame Size | 56C |
| Enclosure | TEFC |
| Degree of Protection | IP43 |
| Service Factor | 1.15 |
| Poles | 4 |
| Full Load Speed | 1725 |
| Insulation Class | F |
| Temp Rise | 80°C |
| NEMA Code Letter | N |
| Duty Cycle | S1 / Continuous |
| Slip | 4.17% |
| Max Ambient Temperature | 40°C |
| Max Elevation | 1000 m.a.s.l (3300 f.a.s.l) |
| Mounting | F1 |
| Rotation | Bi-Directional |
| Mounting Type | C-Face with Removable Base |
| Standard | NEMA MG-1 |
| Approvals | CSA, CE |
| Overload | Automatic Overload |

EFFICIENCY/POWER FACTOR

| LOAD | EFF | P. F. |
|------|--------|-------|
| 100% | 65.5 % | 67.4 |
| 75% | 62.9 % | 58.7 |
| 50% | 56.4 % | 47.6 |

TORQUE

| FULL LOAD | LRT | BDT |
|-------------|-------|-------|
| 1.51 lb.ft. | 425 % | 275 % |

AMPERAGE INFORMATION

| | 115V | 230V |
|-------------------|------|------|
| Full Load Amps | 7.2 | 3.6 |
| Locked Rotor Amps | 43.7 | 21.9 |
| No Load Current | 5.48 | 2.74 |
| Usable at 208V | 3.7A | |

BEARING INFORMATION

| | |
|-------------|----------|
| DE Bearing | 6203 2RS |
| ODE Bearing | 6203 2RS |

CAPACITOR INFORMATION

| | |
|-----------------|---------------|
| Start Capacitor | (1)400uF/165V |
| Run Capacitor | -- |

ADDITIONAL DATA

| | |
|--------------------|-------------------|
| F2 Suitable | No |
| Shaft Material | 1045 Carbon Steel |
| Connection Diagram | 115/230V - 6 Lead |
| Approximate Weight | 25 lbs. |

MOTOR DRAWING

Premium Efficiency Motor: **NT12-18-56CB**

WorldWide Electric Corporation

1 (800) 808-2131

Worldwideelectric.net

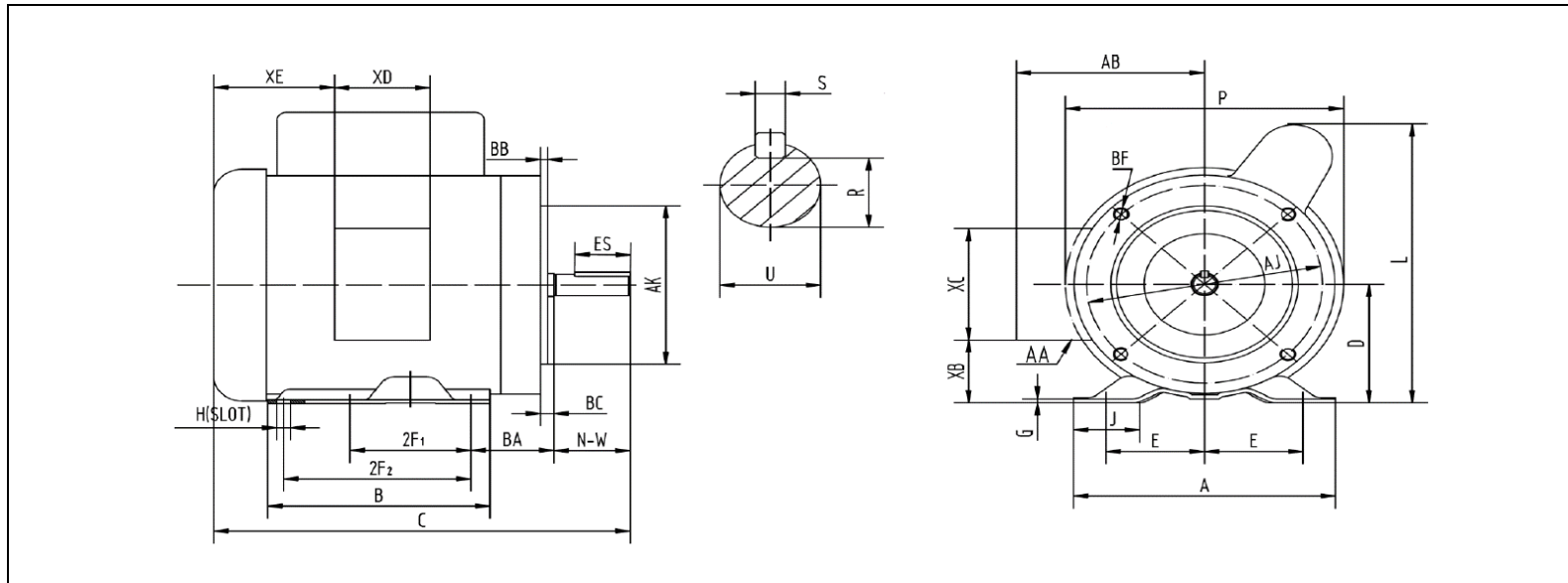

DIMENSION - INCHES

| MOUNTING | | | | | A | B | C | D | G | L | P | AB | J |
|----------|-----|-----|------|------|------|------|------|-----|------|-----|-----|-----|------|
| E | 2F1 | 2F2 | H | BA | | | | | | | | | |
| 2.44 | 3 | 5 | 0.34 | 2.75 | 6.54 | 6.54 | 11.9 | 3.5 | 0.12 | 8.2 | 7.3 | 5.2 | 1.65 |

| SHAFT & KEY | | | | |
|-------------|------|-------|-------|------|
| R | ES | S | U | NW |
| 0.517 | 1.41 | 0.188 | 0.625 | 1.88 |

| TERMINAL BOX | | | | |
|--------------|-----|-----|------|----------------|
| XB | XC | XD | XE | AA |
| 1.65 | 3.7 | 3.2 | 2.15 | 3-0.88/2-1.109 |

| FLANGE | | | | |
|--------|-------|--------|------|-------|
| AK | AJ | BF | BB | BC |
| 4.5 | 5.875 | 3/8-16 | 0.16 | -0.19 |

NAMEPLATE / WIRING

Premium Efficiency Motor: **NT12-18-56CB**

WorldWide Electric Corporation

1 (800) 808-2131

Worldwideelectric.net



Document Generated: 22-Feb-2023
Document ID:

Customer:

SAMPLE NAMEPLATE DATA

| | | | | | |
|--------------------------------|--------------------------------|--|-------------|---------------------|------------|
| | | SINGLE PHASE INDUCTION MOTOR | | | |
| MODEL | FRAME 56C | LOW VOLTAGE | | HIGH VOLTAGE | |
| Hz 60 | ENCL. TEFC | BLUE (T1) |] LINE1 | BLUE (T1) | LINE1 |
| HP | PH 1 | ORANGE (T3) | | ORANGE (T3) |] INS |
| RPM | DUTY CONT | RED (T8) |] LINE2 | RED (T8) | |
| VOLTS 115/230 | CODE | WHITE (T2) | | WHITE (T2) | |
| AMPS | INS. F IP43 | YELLOW (T4) | YELLOW (T4) | BLACK (T5) | BLACK (T5) |
| | DES. | BLACK (T5) | | | |
| S. F. 1.15 | LB/WT | ACCEPTABLE FOR FIELD WIRING | | | |
| SFA. | MAX. AMB. 40°C | ROTATION CCW-OPE TO REVERSE EITHER VOLTAGE | | | |
| DE/ODE BRG. | Date Code X X / X X X X | INTERCHANGE BLACK (T5) AND RED (T8) LEADS | | | |
| | | THERMALLY PROTECTED : NONE | | | |
| SERIAL NO. XXXXXXXXXXXX | | WorldWide Electric Corporation | | | |

MADE IN CHINA

| | | | |
|-----------------|--------------|---------------|---------|
| Model | NT12-18-56CB | Frame | 56C |
| Hz | 60 Hz | Encl | TEFC |
| HP | 1/2 | PH | 1 |
| RPM | 1725 | DUTY | CONT |
| Voltage | 115/230 | Code | N |
| Amps | 7.2/3.6 | Ins Cl | F |
| S.F. | 1.15 | IP | IP43 |
| SFA. | 7.6/3.8 | DES. | N |
| DE Brng | 6203 2RS | WT: | 25 lbs. |
| ODE Brng | 6203 2RS | | |