

# DATA SHEET

Premium Efficiency Motor: **NTJ1-36-56CB**

**60 Hz**

WorldWide Electric Corporation

1 (800) 808-2131

Worldwideelectric.net



Document Generated: 27-Feb-2023  
Document ID:

Customer:

MOTOR INFORMATION	
HP	1
RPM	3600
Phase	1
Frequency	60 Hz
Voltage	115/230
Frame Size	56C
Enclosure	TEFC
Degree of Protection	IP43
Service Factor	1.15
Poles	2
Full Load Speed	3450
Insulation Class	F
Temp Rise	80°C
NEMA Code Letter	M
Duty Cycle	S1 / Continuous
Slip	4.17%
Max Ambient Temperature	40°C
Max Elevation	1000 m.a.s.l (3300 f.a.s.l)
Mounting	F1
Rotation	Clockwise
Mounting Type	C-Face with Removable Base
Standard	NEMA MG-1
Approvals	CSA, CE
Overload	Automatic Overload

EFFICIENCY/POWER FACTOR		
LOAD	EFF	P. F.
100%	70.0 %	82.6
75%	69.5 %	76.0
50%	65.4 %	64.9

TORQUE		
FULL LOAD	LRT	BDT
1.53 lb.ft.	125 %	225 %

AMPERAGE INFORMATION		
	115V	230V
Full Load Amps	11.4	5.7
Locked Rotor Amps	123.6	61.8
No Load Current	11.94	5.97

BEARING INFORMATION	
DE Bearing	6203 2RS
ODE Bearing	6203 2RS

CAPACITOR INFORMATION	
Start Capacitor	(1)150uF/165V
Run Capacitor	--

ADDITIONAL DATA	
F2 Suitable	No
Shaft Material	1045 Carbon Steel
Connection Diagram	115/230V - 6 Lead
Approximate Weight	28.3 lbs.

# MOTOR DRAWING

Premium Efficiency Motor: **NTJ1-36-56CB**

WorldWide Electric Corporation

1 (800) 808-2131

Worldwideelectric.net

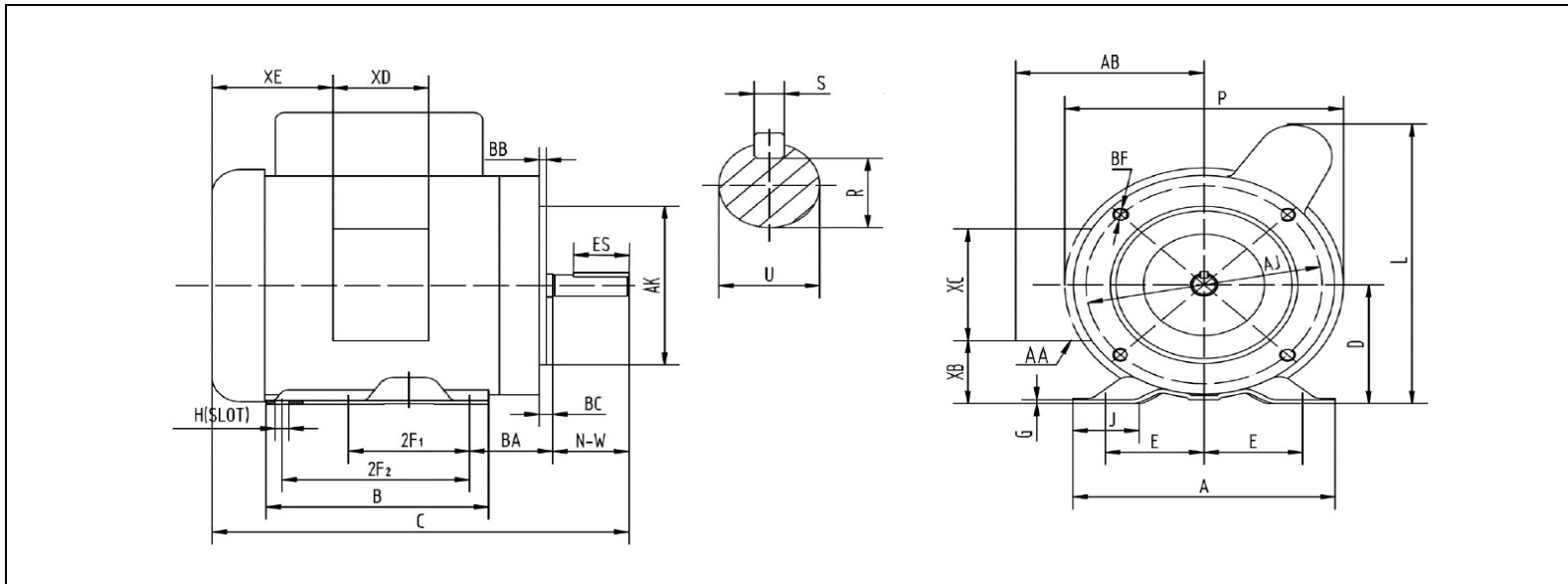

## DIMENSION - INCHES

MOUNTING					A	B	C	D	G	L	P	AB	J
E	2F1	2F2	H	BA									
2.44	3	5	0.34	2.75	6.54	6.54	11.9	3.5	0.12	8.8	8.2	5.2	1.65

SHAFT & KEY				
R	ES	S	U	NW
0.517	1.41	0.188	0.625	1.88

TERMINAL BOX				
XB	XC	XD	XE	AA
1.65	3.7	3.2	2.15	1/2 & 3/4

FLANGE				
AK	AJ	BF	BB	BC
4.5	5.875	3/8-16	0.16	-0.19

# NAMEPLATE / WIRING

Premium Efficiency Motor: **NTJ1-36-56CB**

WorldWide Electric Corporation

1 (800) 808-2131

Worldwideelectric.net



Document Generated: 27-Feb-2023  
 Document ID:

Customer:

## SAMPLE NAMEPLATE DATA

		<h3>INDUSTRIAL DUTY FRACTIONAL MOTOR</h3>			
<b>MODEL</b>	<b>FRAME</b>	<b>LOW VOLTAGE</b>		<b>HIGH VOLTAGE</b>	
Hz	ENCL.	BLACK (P1) — LINE1	BLACK (P1) — LINE1	<b>MADE IN CHINA</b>	
HP	PH	BROWN (P2) — INS	BROWN (P2) — INS		
RPM	DUTY	ORANGE (T3) — INS	ORANGE (T3) — INS		
VOLTS	CODE	BLACK (T5) — INS	BLACK (T5) — INS		
AMPS	INS.	WHITE (T2) — INS	WHITE (T2) — INS		
S. F.	DES.	YELLOW (T4) — LINE2	YELLOW (T4) — LINE2		
SFA.	LB/WT	RED (T8) — LINE2	RED (T8) — LINE2		
MAX. AMB.	DE/ODE BRG.				
SERIAL NO. XXXXXXXXXX Date Code XXX/XXXXX		ACCEPTABLE FOR FIELD WIRING ROTATION CW-OPE TO REVERSE EITHER VOLTAGE INTERCHANGE BLACK (T5) AND RED (T8) LEADS THERMALLY PROTECTED : AUTOMATIC			
WorldWide Electric Corporation					

<b>Model</b>	NTJ1-36-56CB	<b>Frame</b>	56C
<b>Hz</b>	60 Hz	<b>Encl</b>	TEFC
<b>HP</b>	1	<b>PH</b>	1
<b>RPM</b>	3450	<b>DUTY</b>	CONT
<b>Voltage</b>	115/230	<b>Code</b>	M
<b>Amps</b>	11.4/5.7	<b>Ins Cl</b>	F
<b>S.F.</b>	1.15	<b>IP</b>	IP43
<b>SFA.</b>	12.6/6.3	<b>DES.</b>	N
<b>DE Brng</b>	6203 2RS	<b>WT:</b>	28.3 lbs.
<b>ODE Brng</b>	6203 2RS		