

DATA SHEET

Premium Efficiency Motor: **NTJ13-36-56JB**

60 Hz

WorldWide Electric Corporation

1 (800) 808-2131

Worldwideelectric.net



Document Generated: 27-Feb-2023
Document ID:

Customer:

MOTOR INFORMATION	
HP	1/3
RPM	3600
Phase	1
Frequency	60 Hz
Voltage	115/230
Frame Size	56J
Enclosure	TEFC
Degree of Protection	IP43
Service Factor	1.15
Poles	2
Full Load Speed	3450
Insulation Class	F
Temp Rise	80°C
NEMA Code Letter	N
Duty Cycle	S1 / Continuous
Slip	4.17%
Max Ambient Temperature	40°C
Max Elevation	1000 m.a.s.l (3300 f.a.s.l)
Mounting	F1
Rotation	Clockwise
Mounting Type	C-Face with Removable Base
Standard	NEMA MG-1
Approvals	CSA, CE
Overload	Automatic Overload

EFFICIENCY/POWER FACTOR		
LOAD	EFF	P. F.
100%	51.1 %	84.9
75%	51.1 %	79.8
50%	45.3 %	71.4

TORQUE		
FULL LOAD	LRT	BDT
0.51 lb.ft.	145 %	250 %

AMPERAGE INFORMATION		
	115V	230V
Full Load Amps	5	2.5
Locked Rotor Amps	39.0	19.5
No Load Current	5.28	2.64

BEARING INFORMATION	
DE Bearing	6203 2RS
ODE Bearing	6203 2RS

CAPACITOR INFORMATION	
Start Capacitor	(1)150uF/165V
Run Capacitor	--

ADDITIONAL DATA	
F2 Suitable	No
Shaft Material	AISI 420 Stainless
Connection Diagram	115/230V - 6 Lead
Approximate Weight	19.4 lbs.

MOTOR DRAWING

Premium Efficiency Motor: **NTJ13-36-56JB**

WorldWide Electric Corporation

1 (800) 808-2131

Worldwideelectric.net

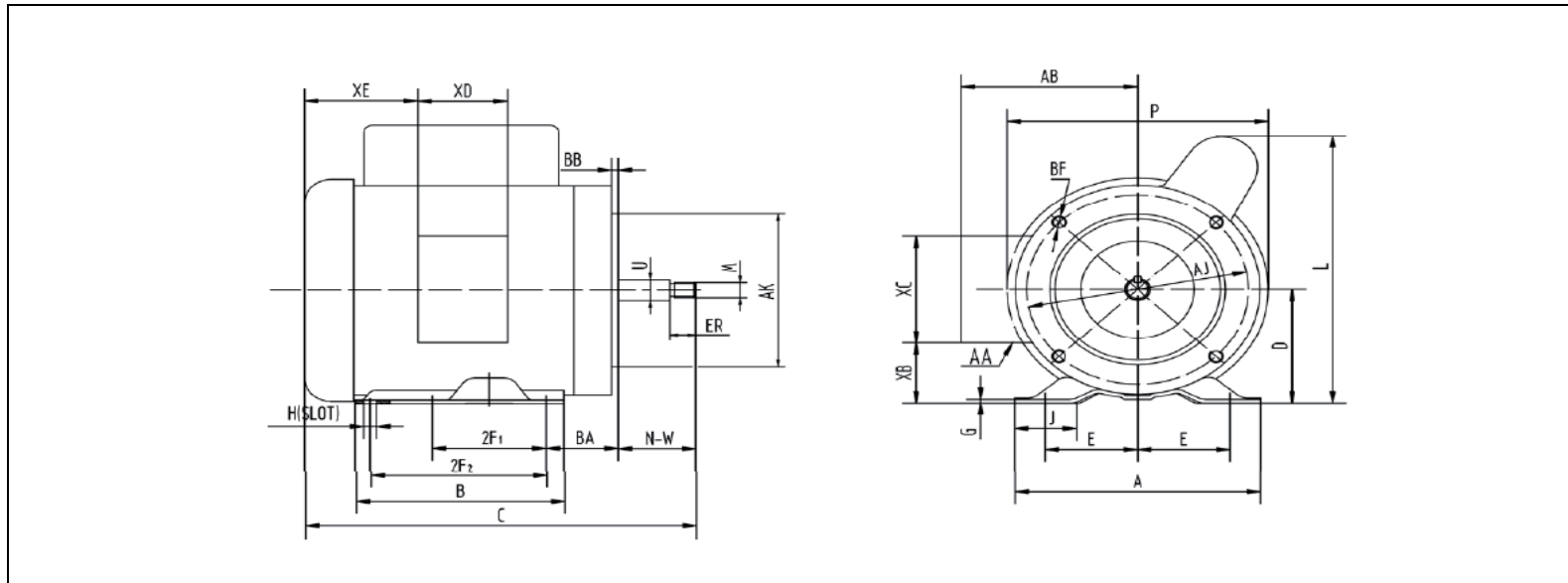

DIMENSION - INCHES

MOUNTING					A	B	C	D	G	L	P	AB	J
E	2F1	2F2	H	BA									
2.44	3	5	0.34	2.75	6.54	6.54	12.4	3.5	0.12	8.2	7.3	5.2	1.65

SHAFT & KEY			
R	ES	U	NW
7/16-20	0.68	0.625	2.44

TERMINAL BOX				
XB	XC	XD	XE	AA
1.65	3.7	3.2	2.15	1/2 & 3/4

FLANGE			
AK	AJ	BF	BB
4.5	5.875	3/8-16	0.16

NAMEPLATE / WIRING

Premium Efficiency Motor: **NTJ13-36-56JB**

WorldWide Electric Corporation

1 (800) 808-2131

Worldwideelectric.net



Document Generated: 27-Feb-2023
 Document ID:

Customer:

SAMPLE NAMEPLATE DATA

INDUSTRIAL DUTY FRACTIONAL MOTOR <div style="float: right; text-align: right;"> </div>			
MODEL	FRAME	LOW VOLTAGE	HIGH VOLTAGE
Hz	ENCL.	BLACK (P1) — LINE1	BLACK (P1) — LINE1
HP	PH	BROWN (P2) —]	BROWN (P2) —] INS
RPM	DUTY	ORANGE (T3) —]	ORANGE (T3) —] INS
VOLTS	CODE	BLACK (T5) —]	BLACK (T5) —] INS
AMPS	INS.	WHITE (T2) —]	WHITE (T2) —] INS
S. F.	DES.	YELLOW (T4) —]	YELLOW (T4) —] LINE2
SFA.	LB/WT	RED (T8) —]	RED (T8) —] LINE2
MAX. AMB.	DE/ODE BRG.	ACCEPTABLE FOR FIELD WIRING ROTATION CW-OPE TO REVERSE EITHER VOLTAGE INTERCHANGE BLACK (T5) AND RED (T8) LEADS THERMALLY PROTECTED : AUTOMATIC	
SERIAL NO. XXXXXXXXXX Date Code XXX/XXXXX			
WorldWide Electric Corporation			

Model	NTJ13-36-56JB	Frame	56J
Hz	60 Hz	Encl	TEFC
HP	1/3	PH	1
RPM	3450	DUTY	CONT
Voltage	115/230	Code	N
Amps	5.0/2.5	Ins Cl	F
S.F.	1.15	IP	IP43
SFA.	5.4/2.7	DES.	N
DE Brng	6203 2RS	WT:	19.4 lbs.
ODE Brng	6203 2RS		