

DATA SHEET

Premium Efficiency Motor: **NTJ2-36-56JB**

60 Hz

WorldWide Electric Corporation

1 (800) 808-2131

Worldwideelectric.net



Document Generated: 27-Feb-2023
Document ID:

Customer:

MOTOR INFORMATION	
HP	2
RPM	3600
Phase	1
Frequency	60 Hz
Voltage	115/230
Frame Size	56J
Enclosure	TEFC
Degree of Protection	IP43
Service Factor	1.15
Poles	2
Full Load Speed	3450
Insulation Class	F
Temp Rise	80°C
NEMA Code Letter	K
Duty Cycle	S1 / Continuous
Slip	4.17%
Max Ambient Temperature	40°C
Max Elevation	1000 m.a.s.l (3300 f.a.s.l)
Mounting	F1
Rotation	Clockwise
Mounting Type	C-Face with Removable Base
Standard	NEMA MG-1
Approvals	CSA, CE
Overload	Automatic Overload

EFFICIENCY/POWER FACTOR		
LOAD	EFF	P. F.
100%	79.8 %	96.1
75%	80.3 %	95.5
50%	77.6 %	92.9

TORQUE		
FULL LOAD	LRT	BDT
3.06 lb.ft.	140 %	205 %

AMPERAGE INFORMATION		
	115V	230V
Full Load Amps	17.2	8.6
Locked Rotor Amps	232.4	116.2
No Load Current	17.28	8.64

BEARING INFORMATION	
DE Bearing	6203 2RS
ODE Bearing	6203 2RS

CAPACITOR INFORMATION	
Start Capacitor	(1)400uF/165V
Run Capacitor	(1)40uF/250V

ADDITIONAL DATA	
F2 Suitable	No
Shaft Material	AISI 420 Stainless
Connection Diagram	115/230V - 6 Lead
Approximate Weight	36.6 lbs.

MOTOR DRAWING

Premium Efficiency Motor: **NTJ2-36-56JB**

WorldWide Electric Corporation

1 (800) 808-2131

Worldwideelectric.net

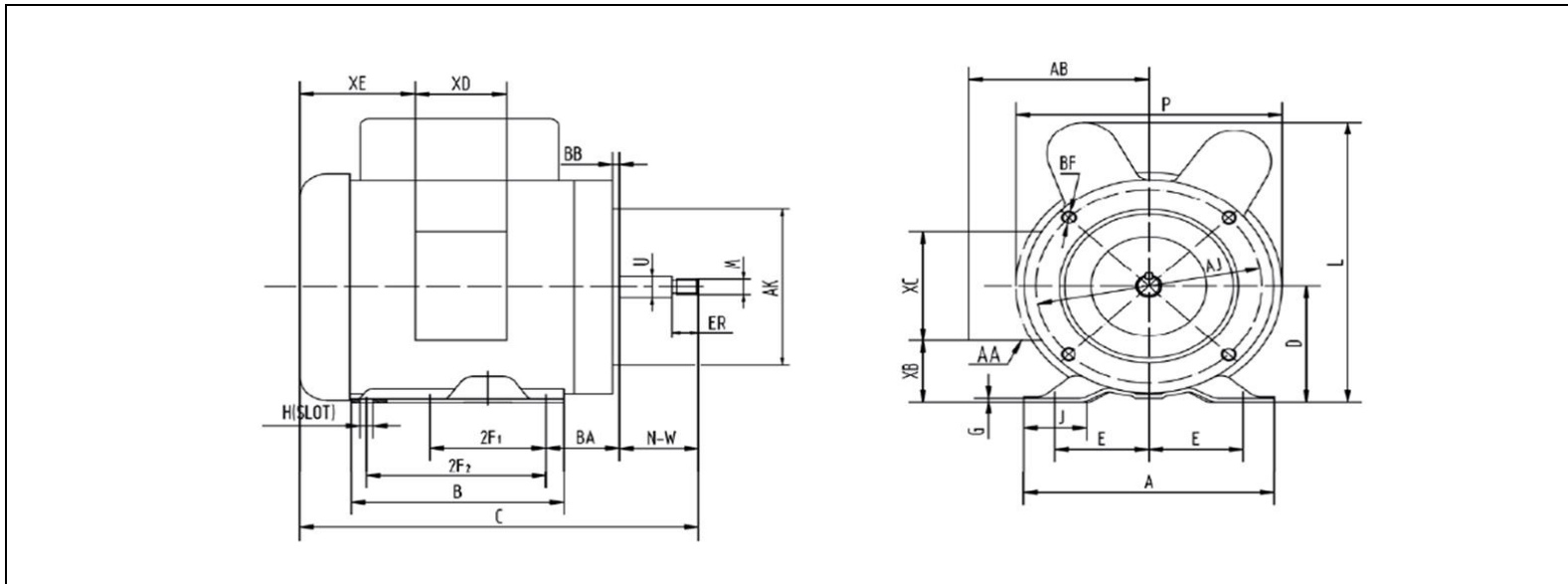

DIMENSION - INCHES

MOUNTING					A	B	C	D	G	L	P	AB	J
E	2F1	2F2	H	BA									
2.44	3	5	0.34	2.75	6.54	6.54	13.4	3.5	0.12	8.7	8.2	5.2	1.65

SHAFT & KEY			
R	ES	U	NW
7/16-23	0.68	0.625	2.44

TERMINAL BOX				
XB	XC	XD	XE	AA
1.65	3.7	3.2	2.15	1/2 & 3/4

FLANGE			
AK	AJ	BF	BB
4.5	5.875	3/8-16	0.16

NAMEPLATE / WIRING

Premium Efficiency Motor: **NTJ2-36-56JB**

WorldWide Electric Corporation

1 (800) 808-2131

Worldwideelectric.net



Document Generated: 27-Feb-2023
Document ID:

Customer:

SAMPLE NAMEPLATE DATA

		INDUSTRIAL DUTY FRACTIONAL MOTOR																																							
						<table border="1"> <tr> <th>MODEL</th> <th>FRAME</th> <th>LOW VOLTAGE</th> <th>HIGH VOLTAGE</th> </tr> <tr> <td>Hz</td> <td>ENCL.</td> <td>BLACK (P1) — LINE1</td> <td>BLACK (P1) — LINE1</td> </tr> <tr> <td>HP</td> <td>PH</td> <td>BROWN (P2) — INS</td> <td>BROWN (P2) — INS</td> </tr> <tr> <td>RPM</td> <td>DUTY</td> <td>ORANGE (T3) — INS</td> <td>ORANGE (T3) — INS</td> </tr> <tr> <td>VOLTS</td> <td>CODE</td> <td>BLACK (T5) — LINE2</td> <td>BLACK (T5) — INS</td> </tr> <tr> <td>AMPS</td> <td>INS.</td> <td>WHITE (T2) — LINE2</td> <td>WHITE (T2) — INS</td> </tr> <tr> <td>S. F.</td> <td>DES.</td> <td>YELLOW (T4) — LINE2</td> <td>YELLOW (T4) — LINE2</td> </tr> <tr> <td>SFA.</td> <td>LB/WT</td> <td>RED (T8) — LINE2</td> <td>RED (T8) — LINE2</td> </tr> <tr> <td>MAX. AMB.</td> <td>DE/ODE BRG.</td> <td colspan="2" style="text-align: center;"> ACCEPTABLE FOR FIELD WIRING ROTATION CW-OPE TO REVERSE EITHER VOLTAGE INTERCHANGE BLACK (T5) AND RED (T8) LEADS THERMALLY PROTECTED : AUTOMATIC </td> </tr> <tr> <td colspan="2"> SERIAL NO. XXXXXXXXXXXX Date Code XXX/XXXXX </td> <td colspan="2" style="text-align: center;"> WorldWide Electric Corporation </td> </tr> </table>		MODEL	FRAME	LOW VOLTAGE	HIGH VOLTAGE	Hz	ENCL.	BLACK (P1) — LINE1	BLACK (P1) — LINE1	HP	PH	BROWN (P2) — INS	BROWN (P2) — INS	RPM	DUTY	ORANGE (T3) — INS	ORANGE (T3) — INS	VOLTS	CODE	BLACK (T5) — LINE2	BLACK (T5) — INS	AMPS	INS.	WHITE (T2) — LINE2	WHITE (T2) — INS	S. F.	DES.	YELLOW (T4) — LINE2	YELLOW (T4) — LINE2	SFA.	LB/WT	RED (T8) — LINE2	RED (T8) — LINE2	MAX. AMB.	DE/ODE BRG.
MODEL	FRAME	LOW VOLTAGE	HIGH VOLTAGE																																						
Hz	ENCL.	BLACK (P1) — LINE1	BLACK (P1) — LINE1																																						
HP	PH	BROWN (P2) — INS	BROWN (P2) — INS																																						
RPM	DUTY	ORANGE (T3) — INS	ORANGE (T3) — INS																																						
VOLTS	CODE	BLACK (T5) — LINE2	BLACK (T5) — INS																																						
AMPS	INS.	WHITE (T2) — LINE2	WHITE (T2) — INS																																						
S. F.	DES.	YELLOW (T4) — LINE2	YELLOW (T4) — LINE2																																						
SFA.	LB/WT	RED (T8) — LINE2	RED (T8) — LINE2																																						
MAX. AMB.	DE/ODE BRG.	ACCEPTABLE FOR FIELD WIRING ROTATION CW-OPE TO REVERSE EITHER VOLTAGE INTERCHANGE BLACK (T5) AND RED (T8) LEADS THERMALLY PROTECTED : AUTOMATIC																																							
SERIAL NO. XXXXXXXXXXXX Date Code XXX/XXXXX		WorldWide Electric Corporation																																							

Model	NTJ2-36-56JB	Frame	56J
Hz	60 Hz	Encl	TEFC
HP	2	PH	1
RPM	3450	DUTY	CONT
Voltage	115/230	Code	K
Amps	17.2/8.6	Ins Cl	F
S.F.	1.15	IP	IP43
SFA.	19.6/9.8	DES.	L
DE Brng	6203 2RS	WT:	36.6 lbs.
ODE Brng	6203 2RS		