

# DATA SHEET

Premium Efficiency Motor: **NTJ34-36-56JB**

**60 Hz**

WorldWide Electric Corporation

1 (800) 808-2131

Worldwideelectric.net



Document Generated: 27-Feb-2023  
Document ID:

Customer:

MOTOR INFORMATION	
HP	3/4
RPM	3600
Phase	1
Frequency	60 Hz
Voltage	115/230
Frame Size	56J
Enclosure	TEFC
Degree of Protection	IP43
Service Factor	1.15
Poles	2
Full Load Speed	3450
Insulation Class	F
Temp Rise	80°C
NEMA Code Letter	M
Duty Cycle	S1 / Continuous
Slip	4.17%
Max Ambient Temperature	40°C
Max Elevation	1000 m.a.s.l (3300 f.a.s.l)
Mounting	F1
Rotation	Clockwise
Mounting Type	C-Face with Removable Base
Standard	NEMA MG-1
Approvals	CSA, CE
Overload	Automatic Overload

EFFICIENCY/POWER FACTOR		
LOAD	EFF	P. F.
100%	66.8 %	81.4
75%	65.5 %	74.8
50%	60.3 %	64.0

TORQUE		
FULL LOAD	LRT	BDT
1.12 lb.ft.	130 %	220 %

AMPERAGE INFORMATION		
	115V	230V
Full Load Amps	9	4.5
Locked Rotor Amps	94.4	47.2
No Load Current	9.9	4.95

BEARING INFORMATION	
DE Bearing	6203 2RS
ODE Bearing	6203 2RS

CAPACITOR INFORMATION	
Start Capacitor	(1)150uF/165V
Run Capacitor	--

ADDITIONAL DATA	
F2 Suitable	No
Shaft Material	AISI 420 Stainless
Connection Diagram	115/230V - 6 Lead
Approximate Weight	25.5 lbs.

# MOTOR DRAWING

Premium Efficiency Motor: **NTJ34-36-56JB**

WorldWide Electric Corporation

1 (800) 808-2131

Worldwideelectric.net

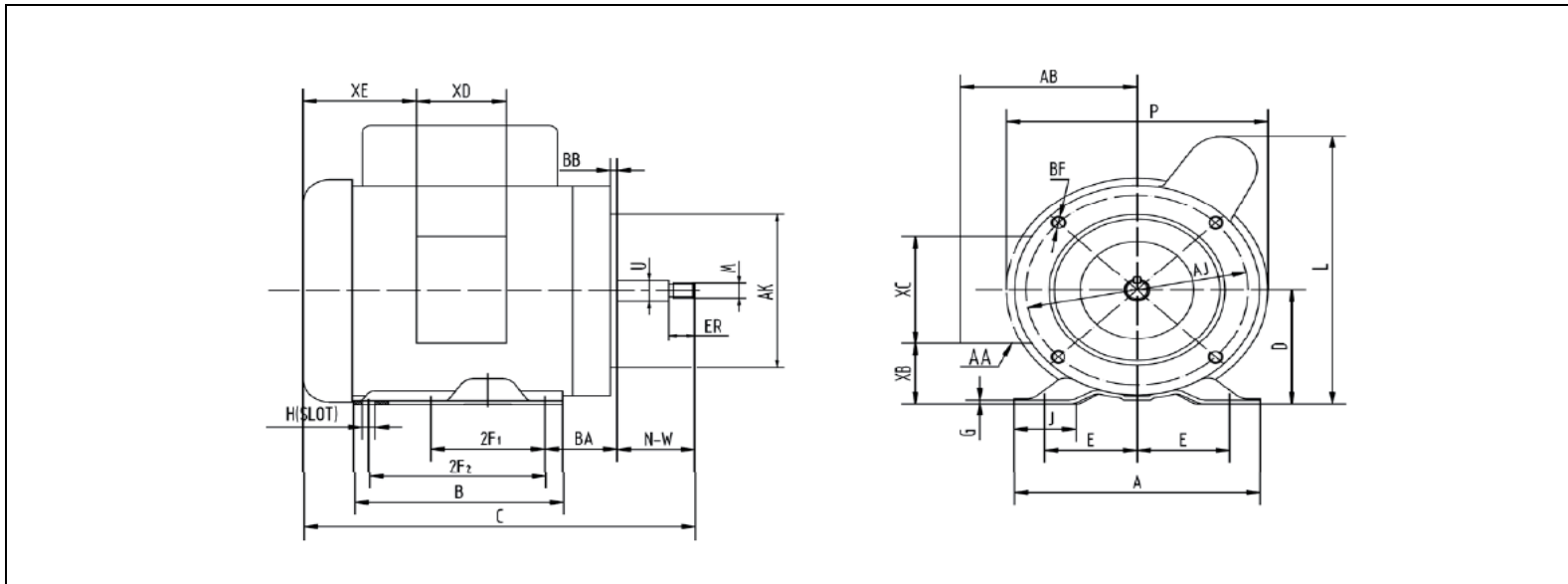

## DIMENSION - INCHES

MOUNTING					A	B	C	D	G	L	P	AB	J
E	2F1	2F2	H	BA									
2.44	3	5	0.34	2.75	6.54	6.54	12.4	3.5	0.12	8.2	7.3	5.2	1.65

SHAFT & KEY			
R	ES	U	NW
7/16-20	0.68	0.625	2.44

TERMINAL BOX				
XB	XC	XD	XE	AA
1.65	3.7	3.2	2.15	1/2 & 3/4

FLANGE			
AK	AJ	BF	BB
4.5	5.875	3/8-16	0.16

# NAMEPLATE / WIRING

WorldWide Electric Corporation

1 (800) 808-2131

Worldwideelectric.net



Premium Efficiency Motor: **NTJ34-36-56JB**

Document Generated: 27-Feb-2023  
Document ID:

Customer:

## SAMPLE NAMEPLATE DATA

		<b>INDUSTRIAL DUTY FRACTIONAL MOTOR</b>			
<b>MODEL</b>	<b>FRAME</b>	<b>LOW VOLTAGE</b>		<b>HIGH VOLTAGE</b>	
Hz	ENCL.	BLACK (P1) — LINE1		BLACK (P1) — LINE1	
HP	PH	BROWN (P2) —		BROWN (P2) — INS	
RPM	DUTY	ORANGE (T3) —	INS	ORANGE (T3) —	INS
VOLTS	CODE	BLACK (T5) —		BLACK (T5) —	INS
AMPS	INS.	WHITE (T2) —		WHITE (T2) —	INS
S. F.	DES.	YELLOW (T4) —	LINE2	YELLOW (T4) —	LINE2
SFA.	LB/WT	RED (T8) —		RED (T8) —	LINE2
<b>MAX. AMB.</b>	<b>DE/ODE BRG.</b>	<b>ACCEPTABLE FOR FIELD WIRING</b> ROTATION CW-OPE TO REVERSE EITHER VOLTAGE INTERCHANGE BLACK (T5) AND RED (T8) LEADS THERMALLY PROTECTED : AUTOMATIC			
SERIAL NO. XXXXXXXXXX Date Code XXX/XXXXX					
WorldWide Electric Corporation					

<b>Model</b>	NTJ34-36-56JB	<b>Frame</b>	56J
<b>Hz</b>	60 Hz	<b>Encl</b>	TEFC
<b>HP</b>	3/4	<b>PH</b>	1
<b>RPM</b>	3450	<b>DUTY</b>	CONT
<b>Voltage</b>	115/230	<b>Code</b>	M
<b>Amps</b>	9.0/4.5	<b>Ins Cl</b>	F
<b>S.F.</b>	1.15	<b>IP</b>	IP43
<b>SFA.</b>	9.8/4.9	<b>DES.</b>	N
<b>DE Brng</b>	6203 2RS	<b>WT:</b>	25.5 lbs.
<b>ODE Brng</b>	6203 2RS		