

DATA SHEET

Premium Efficiency Motor: **PEWWE100-18-405TBB**

60 Hz

WorldWide Electric Corporation

1 (800) 808-2131

Worldwideelectric.net



Document Generated: 31-Jul-2023
Document ID:

Customer:

MOTOR INFORMATION

| | |
|-------------------------|--|
| HP | 100 |
| RPM | 1800 |
| Phase | 3 |
| Frequency | 60 Hz |
| Voltage | 230/460 V |
| Frame Size | 405T |
| Enclosure | TEFC |
| Degree of Protection | IP55 |
| Service Factor | 1.25 |
| Poles | 4 |
| Full Load Speed | 1785 |
| Insulation Class | F |
| Temp Rise | 80°C |
| NEMA Code Letter | G |
| Duty Cycle | S1 / Continuous |
| Slip | 0.83% |
| NEMA Design | B |
| Moment of Inertia | 28.1 lb.ft.^2 |
| Locked Rotor Time (Hot) | 16 seconds |
| Sound Pressure Level | 74 dB(A) |
| Number of Starts | 2 Cold/ 1 Hot |
| Max Ambient Temperature | 40°C |
| Max Elevation | 1000 m.a.s.l (3300 f.a.s.l) |
| Mounting | F1 |
| Rotation | Bi-Directional |
| Area of Classification | Class 1 Division 2 Groups A,B,C,D T3A(180°C) |
| Inverter Rating | 10:1 CT / 20:1 VT PWM Type |
| Standard | NEMA MG-1 |
| Approvals | CSA-US, CE |

EFFICIENCY/POWER FACTOR

| LOAD | EFF | P. F. |
|------|--------|-------|
| 100% | 95.4 % | 0.86 |
| 75% | 95.6 % | 0.84 |
| 50% | 95.4 % | 0.77 |

TORQUE

| FULL LOAD | LRT | BDT |
|------------|-------|-------|
| 294 lb.ft. | 160 % | 250 % |

AMPERAGE INFORMATION

| | 230V | 460V |
|-------------------|-------|------|
| Full Load Amps | 228A | 114A |
| Locked Rotor Amps | 1450A | 725A |
| No Load Current | 70A | 35A |
| Usable at 208V | 252A | |

BEARING INFORMATION

| | |
|-------------------------|------------|
| DE Bearing | 6316 C3 |
| ODE Bearing | 6313 C3 |
| Grease Type | SKF LGHP 2 |
| DE Regreasing Interval | 2000 Hours |
| ODE Regreasing Interval | 3000 Hours |

ADDITIONAL DATA

| | |
|--------------------|-------------------------|
| F2 Suitable | No |
| Shaft Material | 1045 Carbon Steel |
| Connection Diagram | 230 / 460 V - 12 Lead Δ |
| Approximate Weight | 1108 lbs. |

MOTOR DRAWING

Premium Efficiency Motor: **PEWWE100-18-405TBB**

WorldWide Electric Corporation

1 (800) 808-2131

Worldwideelectric.net

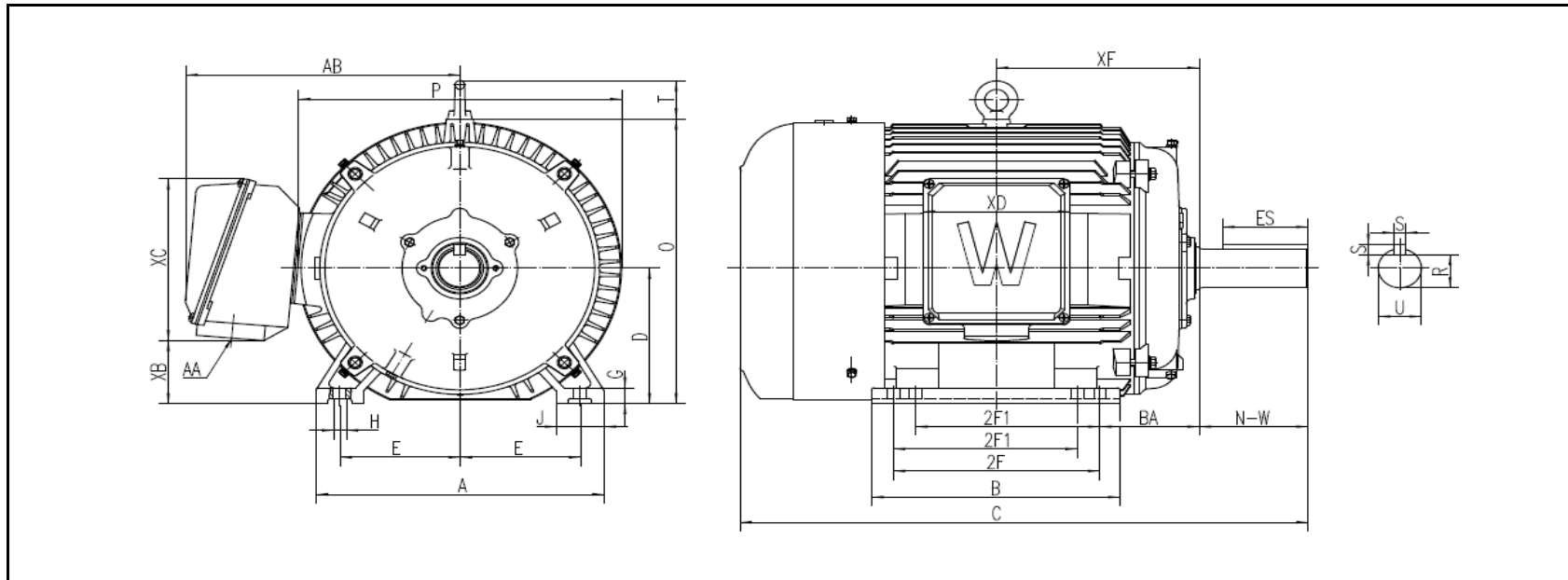

DIMENSION - INCHES

| MOUNTING | | | | | A | B | C | D | G | J | P | O | T | AB |
|----------|-------|-------|------|------|--------|--------|--------|----|-------|------|--------|--------|-------|--------|
| E | 2F1 | 2F | H | BA | | | | | | | | | | |
| 8 | 12.25 | 13.75 | 0.81 | 6.62 | 19.136 | 16.535 | 37.815 | 10 | 1.181 | 3.15 | 21.535 | 21.024 | 2.835 | 18.264 |

| SHAFT & KEY | | | | |
|-------------|------|------|------|-------|
| S | ES | R | N-W | U |
| 0.75 | 5.65 | 2.45 | 7.25 | 2.875 |

| TERMINAL BOX | | | | |
|--------------|-------|--------|-------|--------|
| AA | XB | XC | XD | XF |
| 3 | 4.659 | 11.933 | 9.764 | 13.494 |

PERFORMANCE CURVES

WorldWide Electric Corporation

1 (800) 808-2131

Worldwideelectric.net



Premium Efficiency Motor:

PEWWE100-18-405TBB

Document Generated: 31-Jul-2023
Document ID:

Customer:

| | | | | | |
|--------------------|--------------|------------|------|--------------|-------|
| Motor Type | PEWWE | | | | |
| Output Rating (HP) | 100 | FL Speed | 1785 | | |
| Full Load Torque | 294 lb.ft | LRT (%FLT) | 160 | 460 volt FLA | 114 A |
| Rotor Wk^2 | 28.1 lb-ft^2 | BDT (%FLT) | 250 | 230 volt FLA | 228 A |

SPEED VS TORQUE & CURRENT CURVE

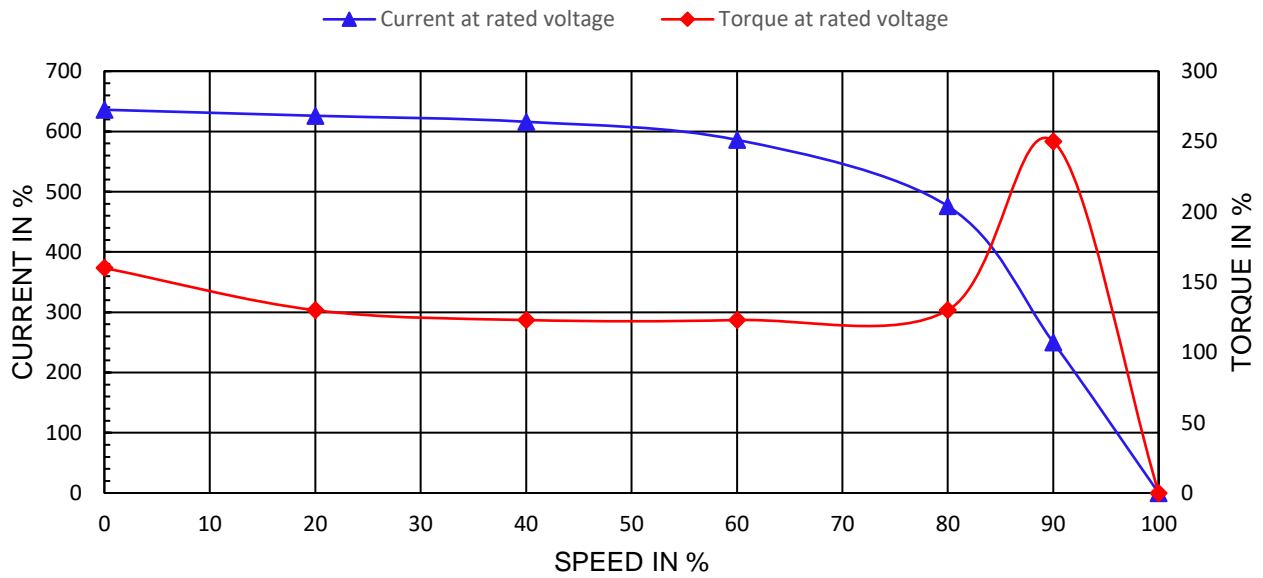

OUTPUT VS EFF., P.F. & CURRENT CURVE

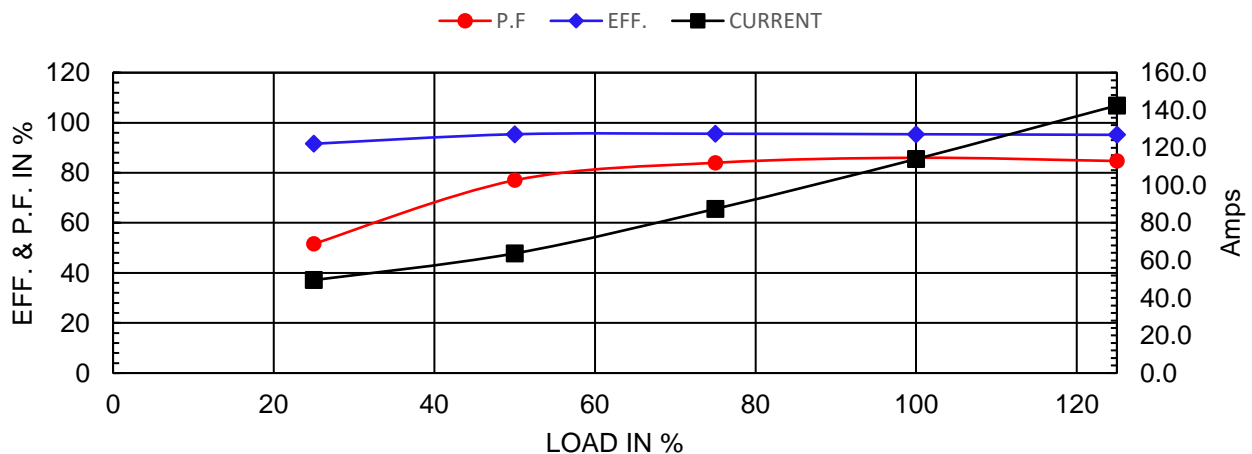

NAMEPLATE / WIRING

WorldWide Electric Corporation

1 (800) 808-2131

Worldwideelectric.net



Premium Efficiency Motor: **PEWWE100-18-405TBB**

Document Generated: 31-Jul-2023
Document ID:

Customer:

SAMPLE NAMEPLATE DATA

| | | | | | | | |
|-------------------------------|---------|---------|------------|---|---------|------------|-------------|
| | | | | 3-PHASE INDUCTION MOTOR | | 259277 | |
| Model | | Ser No. | | | | | |
| HP | | S.F. | | IP | | Encl | |
| Frame | | P.F. | | Code | | Type | |
| Voltage | 230/460 | Hz | | Ins Cl | | Rating | °C Amb Cont |
| Amps | | RPM | | Design | | Date | |
| Nom.Eff. | FL | % 3/4 | % 230/460V | 10:1 CT | 20:1 VT | PWM | VFD 1.0SF |
| Class I DIV. 2 Groups A B C D | | | Amb.40°C | DE Brng | | | |
| Class I Zone 2 IIC | | | Amb.55°C | ODE Brng | | | |
| | | | | Grease type: LGHP 2 (compatible with polyrex) | | | |
| 50Hz | | HP | V | A | rpm | 1.0SF | |

Model

HP S.F. IP Encl

Frame P.F. Code Type

Voltage Hz Ins Cl Ambient

Amps RPM Design DE Brng 6316 C3

Nom.Eff. ODE Brng 6313 C3

Grease type: SKF LGHP 2