

DATA SHEET

Premium Efficiency Motor: **SSPE2-36-56C-ENC,**

60 Hz

WorldWide Electric Corporation

1 (800) 808-2131

Worldwideelectric.net



Document Generated: 17-Apr-2026
Document ID:

Customer:

| MOTOR INFORMATION | |
|-------------------------|-------------------------------------|
| HP | 2 |
| RPM | 3600 |
| Phase | 3 |
| Frequency | 60 |
| Voltage | 230/460 |
| Frame Size | 56C |
| Enclosure | TEFC |
| Degree of Protection | IP69K |
| Service Factor | 1.15 |
| Poles | 2 |
| Full Load Speed | 3480 |
| Insulation Class | F |
| Temp Rise | 80°C |
| NEMA Code Letter | L |
| Duty Cycle | S1 |
| Slip | 3.33% |
| NEMA Design | B |
| Moment of Inertia | 0.094 lb.ft.^2 |
| Locked Rotor Time (Hot) | 12 seconds |
| Sound Pressure Level | 76 dB(A) |
| Number of Starts | 10 |
| Max Ambient Temperature | 40° C |
| Max Elevation | 1000 m.a.s.l (3300 f.a.s.l) |
| Mounting | F1 - C-Face with Feet |
| Rotation | Bidirectional |
| Area of Classification | Class 1 Division 2 Gr. A,B,C,D - T3 |
| Inverter Rating | 10:1 CT/20:1 VT - T3 |
| Standard | NEMA MG1, UL1004 |
| Approvals | CSA,UL,CE |

| EFFICIENCY/POWER FACTOR | | |
|-------------------------|--------|-------|
| LOAD | EFF | P. F. |
| 100% | 85.5 % | 0.91 |
| 75% | 79.0 % | 0.85 |
| 50% | 75.0 % | 0.78 |

| TORQUE | | |
|------------|-------|-------|
| FULL LOAD | LRT | BDT |
| 2.9 lb.ft. | 285 % | 300 % |

| AMPERAGE INFORMATION | | |
|----------------------|------|------|
| | 230V | 460V |
| Full Load Amps | 4.8 | 2.4 |
| Locked Rotor Amps | 50 | 25 |
| No Load Current | 1.7 | 0.85 |
| Usable at 208V | 4.9 | |

| BEARING INFORMATION | |
|---------------------|------------------|
| DE Bearing | 6205 2RS |
| ODE Bearing | 6205 2RS |
| Grease Type | Mobil Polyrex EM |

| ADDITIONAL DATA | |
|--------------------|---------------------|
| F2 Suitable | No |
| Shaft Material | 304 Stainless Steel |
| Connection Diagram | 9 Lead 2Y/Y |
| Approximate Weight | 53 lbs. |

MOTOR DRAWING

Premium Efficiency Motor: **SSPE2-36-56C-ENC**

WorldWide Electric Corporation

1 (800) 808-2131

Worldwideelectric.net

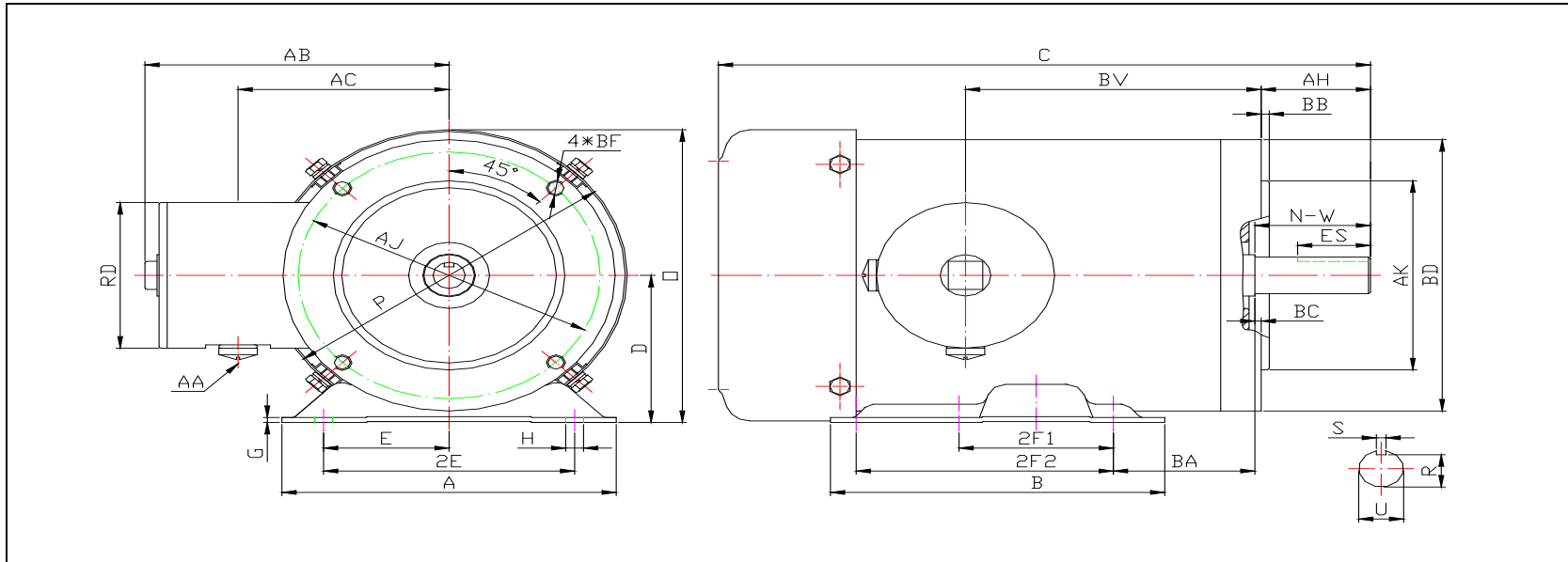

DIMENSION - INCHES

| MOUNTING | | | | | | A | B | C | D | G | P | O | T |
|----------|------|-----|-----|-----------|------|-----|-----|-------|-----|-------|------|------|-----|
| E | 2E | 2F1 | 2F2 | H | BA | | | | | | | | |
| 2.44 | 4.88 | 3 | 5 | 1.22*0.34 | 2.75 | 6.5 | 6.5 | 13.75 | 3.5 | 0.118 | 6.95 | 6.98 | N/A |

| AB | BC | KEY | | KEYSET | SHAFT | | | TERMINAL BOX | | | | |
|------|-------|-------|------|--------|-------|------|-------|--------------|------|-----|------|------|
| | | S | ES | R | AH | N-W | U | AA | AB | AC | RD | BV |
| 5.95 | -0.19 | 0.188 | 1.41 | 0.517 | 2.06 | 1.88 | 0.625 | 1/2 | 5.95 | 4.5 | 3.45 | 6.95 |

| FLANGE | | | | |
|--------|-----|------|------|----------|
| AJ | AK | BB | BD | BF |
| 5.875 | 4.5 | 0.16 | 6.45 | 4*3/8-16 |

PERFORMANCE CURVES

WorldWide Electric Corporation

1 (800) 808-2131

Worldwideelectric.net



Premium Efficiency Motor:

SSPE2-36-56C-ENC

| | | | |
|---------------------|-------------|-----------|--|
| Document Generated: | 17-Apr-2026 | Customer: | |
| Document ID: | | | |

| | | | | | |
|-----------------------|--------------------------|------------|------|--------------|-----|
| Motor Type | SSPE | | | | |
| Output Rating (HP) | 2 | FL Speed | 3480 | | |
| Full Load Torque | 2.9 lb.ft | LRT (%FLT) | 285 | 460 volt FLA | 2.4 |
| Rotor Wk ² | 0.094 lb-ft ² | BDT (%FLT) | 300 | 230 volt FLA | 4.8 |

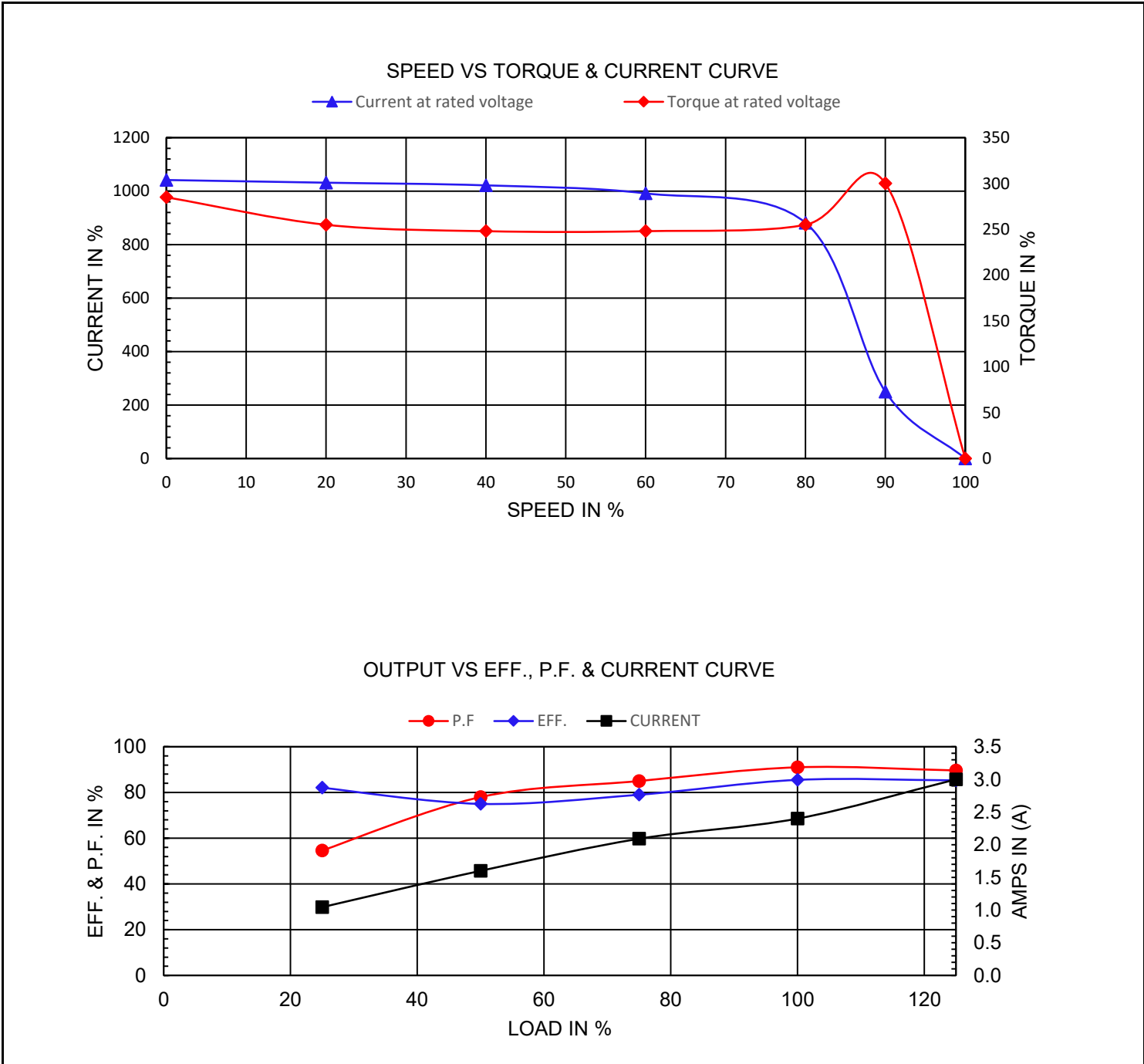

NAMEPLATE / WIRING

WorldWide Electric Corporation

1 (800) 808-2131

Worldwideelectric.net



Premium Efficiency Motor: **SSPE2-36-56C-ENC**

Document Generated: 17-Apr-2026
Document ID:

Customer:

SAMPLE NAMEPLATE DATA

| | | | | | | | | | | |
|---------------|-------------|--|-------------|-------------|-----------|--------|--|--|--|--|
| | | THREE PHASE AC INDUCTION MOTOR | | | | CC082A | | | | |
| Model . | | FRAME | | IP 69K | LB/WT | | | <div style="display: flex; justify-content: space-around;"> <div style="text-align: center;"> <p>230V</p> </div> <div style="text-align: center;"> <p>460V</p> </div> </div> | | |
| Hz 60 | S. F. 1. 15 | Hz 50 | S. F. 1. 15 | ENCL. TEFC | AMB. 40°C | | | | | |
| HP | RPM | HP | RPM | DUTY CONT | INS. F | | | | | |
| VOLTS | 230/460 | VOLTS | 190/380 | NEMA DES. B | | | | | | |
| AMP | | AMP | | BRG DE | | | | | | |
| CODE | P. F. | CODE | P. F. | BRG ODE | | | | | | |
| EFF | MIN | IE3 - | | NO. | | | | | | |
| CSA Certified | | CLASS 1 DIV. 2, Gr A, B, C, D - T3 For Use on PWM:CT 6-60Hz , VT 3-60Hz - 1.00 SF - T3 Worldwide Electric Corporation - Fairport, NY | | | | | | | | |

| | | | | | | |
|---------|------------------|------|-------|-----------|-------|---------|
| Model | SSPE2-36-56C-ENC | | FRAME | 56C | LB/WT | 53 lbs. |
| Hz | 60 S.F. | 1.15 | Hz | 50 S.F. | 1.15 | |
| HP | 2 RPM | 3480 | HP | 1 1/2 RPM | 2900 | |
| VOLTS | 230/460 | | VOLTS | 190/380 | | |
| AMPS | 4.8/2.4 | | AMPS | 4.4/2.2 | | |
| CODE | L | P.F. | 0.91 | CODE | M | P.F. |
| EFF | 85.5% | MIN | 75% | IE3 - | 82.7% | |
| BRG DE | 6205 2RS | | | | | |
| BRG ODE | 6205 2RS | | | | | |